

Fuse Holders and Blocks

Class CC, Type M and Class G fuse blocks

BC Series



Specifications

Description: Class CC fuse blocks for use with Class CC fuses (Cooper Bussmann LP-CC, KTK-R, and FNQ-R).

Dimensions: See Data Sheet 1105 (available on the web at www.cooperbussmann.com).

Construction: Thermoplastic base.

Poles: 1 to 3

Ratings:

Volts: — 600V

Amps: — 1/0-30A

Withstand:— 200,000A RMS Sym.

Agency Information: CE, UL Listed (Guide IZLT, File E14853), CSA (Class 6225-01, File 47235)

Flammability Rating: UL 94V0

DIN Rail Adapters: See page 358 for DRA-1 & DRA-2

Catalog Numbers

Catalog Numbers					
Terminal Type					
Screw	Screw with Quick Connect*	Pressure Plate	Pressure Plate w/ Quick Connect*	Box Lug	Poles
BC6031S	BC6031SQ	BC6031P	BC6031PQ	BC6031B	1
BC6032S	BC6032SQ	BC6032P	BC6032PQ	BC6032B	2
BC6033S	BC6033SQ	BC6033P	BC6033PQ	BC6033B	3

Data Sheet: 1105

BCCM Series

Specifications

(See Data Sheet 1106 for details)

Description: 3-pole fuse block for use with (2) Class CC fuses and (1) 1³/₂" x 1¹/₂" fuse

Catalog Numbers

Catalog Numbers	Terminal Type
BCCM6033SQ	Screw with Quick-Connect*
BCCM6033PQ	Pressure Plate w/Quick-Connect*

*Quick-connect terminal rated for 20A max.

Data Sheet: 1106

BM Series Type M



Specifications

Description: Supplementary fuse blocks for use with any 1³/₂" x 1¹/₂" fuses (Cooper Bussmann® KTK, FNQ, FNM, BAF, BAN, and AGU).

Dimensions: See Data Sheet 1104 (available on the web at www.cooperbussmann.com).

Construction: Thermoplastic base.

Poles: 1 to 3

DIN Rail Adapters: See page 358 for DRA-1 & DRA-2

Ratings:

Volts: — 600V

Amps: — 1/0-30A

Withstand:— 10,000A RMS Sym.

Agency Information: CE, UL Recognized (Guide IZLT2, File E14853), CSA (Class 6225-01, File 47235).

Flammability Rating: UL 94V0.

Catalog Numbers

Catalog Numbers				
Terminal Type				
Screw with Quick Connect*	Pressure Plate w/ Quick Connect*	Box Lug	Poles	
BM6031SQ	BM6031PQ	BM6031B	1	
BM6032SQ	BM6032PQ	BM6032B	2	
BM6033SQ	BM6033PQ	BM6033B	3	

Data Sheet: 1104

BG & G Series



Specifications

Description: Class G fuse blocks for use with Class G fuses (Cooper Bussmann SC).

Dimensions: See Data Sheet 1106 (available on the web at www.cooperbussmann.com).

Construction: 0-30A thermoplastic base, 35-60A phenolic base.

Poles: 1 to 3

Ratings:

Volts: — 600V (0-20A)

— 480V (25-60A)

Amps: — 1-60A (See Catalog Numbers table)

Withstand: — 100,000A RMS Sym.

Agency Information: CE, UL Listed 35-60A (Guide IZLT, File E14853), UL Recognized 1-30A, (Guide IZLT2, File E14853), CSA (Class 6225-01, File 47235).

DIN Rail Adapters: See page 358 for DRA-1 & DRA-2.

Catalog Numbers

Catalog Numbers						
Terminal Type						
Screw with Quick Connect*	Pressure Plate w/ Quick Connect*	Box Lug	Box Lug w/retaining clip	Amps	Poles	
BG3011SQ	BG3011PQ	BG3011B	—	1-15	1	
BG3012SQ	BG3012PQ	BG3012B	—		2	
BG3013SQ	BG3013PQ	BG3013B	—		3	
BG3021SQ	BG3021PQ	BG3021B	—	20	1	
BG3022SQ	BG3022PQ	BG3022B	—		2	
BG3023SQ	BG3023PQ	BG3023B	—		3	
BG3031S	BG3031P	BG3031B	—	25-30	1	
BG3032S	BG3032P	BG3032B	—		2	
BG3033S	BG3033P	BG3033B	—		3	
—	—	—	G30060-1CR	35-60	1	
—	—	—	G30060-2CR		2	
—	—	—	G30060-3CR		3	

Data Sheet: 1106

Modular fuse blocks

BH Series



Specifications

Description: For use with Cooper Bussmann semiconductor fuses.

Construction: Light weight, high temperature thermoplastic base with spring steel washer, and plated steel mounting studs and nuts.

Ratings:

Withstand: — 200,000A RMS Sym. or fuse IR, whichever is smaller.

Agency Information: CE, UL Recognized, Guide EZLT2, File No. E14853 up to 700V, CSA Certified, Class 6225-01, File No. 47235 up to 700V.

BH Series Features and Benefits

- BH fuse blocks provide a wide range of mounting configurations for Cooper Bussmann High Speed (Semi-conductor) fuses.
- BH fuse blocks have a Short Circuit Current Rating of any installed fuse up to 200,000A RMS Sym.

Typical Applications

- Solid State Control Circuits
- VFDs
- UPS Systems

Catalog Numbers

BH-0001	BH-0122	BH-2001	BH-3004
BH-0002	BH-1001	BH-2002	BH-3033
BH-0003	BH-1002	BH-2003	BH-3144
BH-0111	BH-1003	BH-2031	BH-3145
BH-0112	BH-1131	BH-2032	
BH-0113	BH-1132	BH-2033	
BH-0121	BH-1133	BH-3003	

Refer to the data sheet numbers below for the catalog code description information.

Data Sheet: (BH-0) 1200; (BH-1) 1201; (BH-2) 1202; (BH-3) 1203

Modular Type Fuse blocks for Class H & J Fuses



Specifications

Description: 3-Pole only, modular type fuse blocks for Class H & J fuses with standard reinforced retaining clips.

Ratings:

- Volts: — 250V (0-60A See Catalog Numbers table)
 — 600V (35-60A See Catalog Numbers table)
- Amps: — 0-60A @ 250V (See Catalog Numbers table)
 — 35-60A@600V (See Catalog Numbers table)

Agency Information: CE, UL Recognized, Guide IZLT2, File E14853, CSA Certified, Class 6225-01, File 47235.

Class H & J Features and Benefits

- H & J modular fuse blocks provide three pole 30 and 60 amp ratings for specific client requirements for separate line and load fuse clip configurations.

Typical Applications

- Up to 60A, space confined, control circuits

Catalog Numbers

Catalog Numbers					
Screw	Pressure Plate	Fuse Class	Volts	Amps	Fig. No.
11241-3SR*	11241-3PR*	H	250	60	1
11242-3SR	11242-3PR				2
11241-3SR	11241-3PR		600	35	1
11242-3SR**	11242-3PR**				2
11239-3SR	11239-3PR	J	600	60	1
11240-3SR**	11240-3PR**				2
11241-3SR	11241-3PR				35
11239-3SR*	11239-3PR*			60	1

Note: Order two blocks per fuse (matched or mixed.)

*11239 and 11241 have wire terminals and mounting holes located under fuse. (Figure 1)

**11240 and 11242 have wire terminals and mounting holes located at end of fuse. (Figure 2)



Figure 1



Figure 2

Fuse Holders and Blocks

Box cover units for plug fuses

SOU, SRU, SSU, SOW, SRW, SSW, SOX, SRX, SSX, SOY, SRY, SSY, SSY-RL, SSY-L, STY, SCY, SOY-B & SKA

Specifications

Description: Box covers for standard electrical boxes that provide fused outlet, fused switch or circuit fuse protection.

Ratings:

Volts: — 125V/250V (See Catalog Numbers table)

Amps: — 0-15A (See Catalog Numbers table)

Agency Information: CE, See Catalog Numbers table.



Features/Benefits

- Cooper Bussmann Box Cover Units provide a low-cost method of controlling and protecting small motors when used with Cooper Bussmann Type T, Fusetron®, dual-element fuses.
- Provide low-cost supplementary protection and disconnection of 125V or less, single phase circuits.

Typical Applications

- Fractional Horsepower, 125 Volt Single-Phase Motor Circuits
- General 125 Volt Supplemental Circuits

Catalog Numbers

Catalog Numbers	Type Box	Fuse holder		Receptacle Outlet to Load		Switch Control ¹	Switch Light ²	Motor Size (Max)	General Data	Agency ⁴ Listing/Certification
		Single	Double	125V	250V					
SOU		X						¾hp	125V, 15A	UL, CSA
SRU	2¼" Handy	X		X				½hp	125V, 15A	UL
SSU ⁵		X				X		½hp	125Vac, (do not use on dc), 15A	UL, CSA
SOW		X						¾hp	125V, 15A	UL, CSA
SRW	2¾" Switch	X		X				½hp	125V, 15A	UL
SSW		X				X		½HP	125Vac, (do not use on dc), 15A	UL, CSA
SOX		X						¾hp	125V, 15A	UL, CSA
SRX	4" Octagon	X		X				½hp	125V, 15A	UL
SSX		X				X		½hp	125Vac, (do not use on dc), 15A	UL, CSA
SOY		X						¾hp	125V, 15A	UL, CSA
SRY		X		X				½hp	125V, 15A	UL
SSY		X				X		½hp	125Vac, (do not use on dc), 15A	UL, CSA
SSY-RL	4" Square	X		X		X	X	½hp	125Vac, (do not use on dc), 15A	—
STY ³			X			X		½hp	125Vac, (do not use on dc), 15A	UL
SCY			X			X(2)		½hp (2)	125Vac, (do not use on dc),	
									can protect two motors, 15A	UL
SOY-B			X					¾hp	125V, protects two motors, 15A	UL
SKA	4½" Square		X		X(15A)			2hp	250V, 15A single phase	UL

¹ Switch turns power to fused load OFF or ON.

² Switch light indicates power to load (dark when switch OFF or fuse open).

³ Double-pole switch opens both side of circuit. STY can be used for two separate 125V motors not larger than ½hp with the common switch, or a single motor not larger than 2hp at 250V (Maximum of 150V to ground).

⁴ UL Guide JAMZ, File IE6491; CSA Class 6225-01, File 47235.

⁵ Weatherproof version available, Part No. SSN.

Fuse Holders and Blocks

In-line fuse holders for ¼" x ⅞" to 1¼" fuses

HFB & HFB-10



Specifications

Description: Waterproof in-line fuse holder for ¼" x 1¼" fuses.

Dimensions: See Dimensions illustration.

Construction: Thermoplastic rubber body with tin-plated, copper contacts.

Ratings:

Volts: — 32V

Amps: — 30A

Catalog Numbers

Catalog Numbers	Description
HFB*	Standard Pack (10-in)
BK/HFB	Bulk Pack (20-in)
BK/1A2294	HFB Replacement Contact Clip
1A2294-01	HFB-10** Replacement Contact Clip

*HFB accepts #12 to #18 wire leads (not provided). See Data Sheet for recommended crimp tools.

**HFB-10 accepts #10 wire leads (not provided). See Data Sheet for recommended crimp tools.

Features/Benefits

- Simple assembly with one-piece thermoplastic (important information molded into body)
- High visibility yellow color for easy identification in dark or hard-to-access locations
- Ideal for shock and vibration environments; withstands many organic solvents; temperature range -40/+150°C

Typical Applications

- Supplemental, Low Voltage, Low Amperage Control Circuits

Dimensions

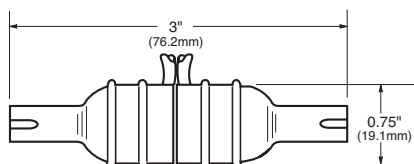

Data Sheet: 2102

HHB



Specifications

Description: Universal in-line fuse holder for ¼" x ⅞", 1" and 1¼" fuses.

Dimensions: See Dimensions illustration.

Construction: Nylon body with tin-plated, copper contacts.

Ratings:

Volts: — 32V

Amps: — 30A

Flammability Rating: UL 94V2.

Pull Force: 5lbs minimum to separate fuse holder housing with fuse installed.

Features and Benefits

- HHB Universal in-line fuse holder for ¼" x ⅞", 1" and 1¼" fuses.

Typical Applications

- Supplemental, Low Voltage, Low Amperage Control Circuits

Catalog Numbers

Holder — without leads*	Description
HHB	Standard Pack (10-in)
BK/HHB	Bulk Pack (100-in)

Holder — with pre-attached #14 Insulated lead wires

Catalog Numbers	8" Length	Wire Color
BK/HHB-Y419	BK/HHB-Y408	Yellow
BK/HHB-R419	BK/HHB-R408	Red
BK/HHB-B419	BK/HHB-B408	Black

*Accepts #12 to #16 wire leads (not provided with basic fuse holder). See Data Sheet for recommended crimp tools.

Dimensions

Fuse Length	Fuse Holder Length "L"
⅞" (AGW)	2.100 Max
1" (AGX)	2.250 Max
1¼" (AGC, MDL)	2.420 Max

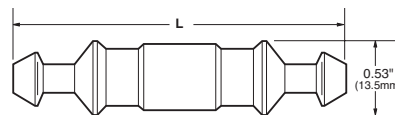

Data Sheet: 2100

HRK



Specifications

Description: Universal in-line fuse holder for ¼" x ⅞" to 1¼" fuses.

Dimensions: See Dimensions illustration.

Construction: 8" (203mm) #14 lead wires staked and soldered to fuse holder contacts.

Ratings:

Volts: — 32V

Amps: — 15A

Features and Benefits

- HRK Universal in-line fuse holder for ¼" x ⅞", 1" and 1¼" fuses with #14 lead wires.

Typical Applications

- Supplemental, Low Voltage, Low Amperage Control Circuits

Catalog Number

Catalog Number	Amp Rating	Volts	Fuse Description
HRK*	15	32	¼" diameter fuses of different lengths.

*Three springs furnished with fuse holder to accommodate different length ¼" fuses.

Dimensions

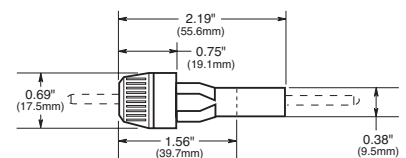

Data Sheet: 2111

Fuse Holders and Blocks

In-line fuse holders

HR and HM Series

Specifications

Description: In-line fuse holders for SFE and ¼" dia. x various length fuses.

Dimensions: See Dimensions illustration.

Ratings:

Volts: — 32V

Amps: — 20A

Features and Benefits

- HR and HM Universal in-line fuse holder for SFE and various length ¼" diameter fuses with #14 lead wires.

Typical Applications

- Supplemental, Low Voltage, Low Amperage Control Circuits

Catalog Numbers

Catalog Numbers	Includes Fuse	Wire Length & Size
HRJ*	SFE-20	19" of #14
HRI	SFE-14	
HRH	SFE-9	
HRE	SFE-7½	
HRG	SFE-6	
HRF	SFE-4	
HMJ**	SFE-20	8" of #14
HMI	SFE-14	
HMH	SFE-9	
HME	SFE-7½	
HMG	SFE-6	
HMF	SFE-4	

* Also available as in-line fuse holder only with lead wire contacts, HRJ-LES-Fuse.

** Also available as in-line fuse holder only with lead wire contacts, HMJ-LES-Fuse.

HHJ-A For ¼" x 1¼" fuse, no wire or fuse included, accepts #18 - #22 wire.

HHJ-B For ¼" x 1¼" fuse, no wire or fuse included, accepts #12 - #16 wire.

HHI-B For ¼" x 1½" fuse, no wire or fuse included, accepts #12 - #16 wire.

Replacement Contacts

Catalog Number	Symbol
9838	HHJ-A
9841	HHJ-B

Dimensions

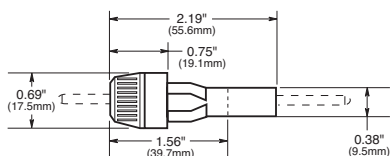

HFA Series

Specifications

Description: In-line waterproof fuse holders for ¼" x 1¼" fuses.

Dimensions: See Dimensions illustration.

Construction: Phenolic body with copper crimp contact leads.

Ratings:

Volts: — 250V

Amps: — 20A

Agency Information: CE, UL Recognized, (Guide IZLT2, File E14853) UL.

Flammability Rating: UL 94V0.

Features and Benefits

- HFA in-line, waterproof fuse holder for ¼" x 1¼" fuses.

Typical Applications

- Supplemental, Low Voltage, Low Amperage Control Circuits

Catalog Numbers

Catalog Numbers	Terminals
HFA	Crimp #12 - #16
HFA-HH*	¼" Quick Connect

*No UL Recognition.

Dimensions

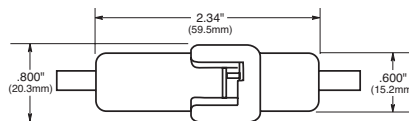

HHT Series

Specifications

Description: In-line fuse holders for 5 x 15mm or 5 x 20mm fuses.

Dimensions: See Dimensions illustration.

Construction: Black thermoplastic body with brass contacts, wire: 16 AWG, red.

Ratings:

Volts: — 32V

Amps: — 5A (5 x 15mm)

— 10A (5 x 20mm)

Features and Benefits

- HHT in-line fuse holders for 5 x 15 mm and 5 x 20 mm fuses.

Typical Applications

- Supplemental, Low Voltage, Low Amperage Control Circuits

Catalog Numbers

Catalog Number	Fuse Size
HHT	5 x 15mm & 5 x 20mm

Dimensions

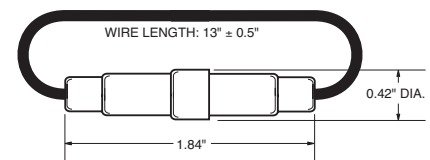
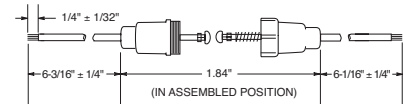

Fuse Holders and Blocks

Tron® in-line fuse holders

HEG Series



Specifications

Description: Single-pole, non-breakaway, in-line fuse holders for Type SC fuses, 480V (or less).

Ratings:

Volts: — 600V

Amps: — 0-15A

Fuse Size: 1³/₃₂" x 1⁵/₁₆"

Catalog Number

HEG-AA

Data Sheet: 2124

HEH Series



Specifications

Description: Single-pole, non-breakaway, in-line fuse holders for Type SC fuses (Also fuse types BBS & KTQ, nominal size 1³/₃₂" x 1³/₈").

Ratings:

Volts: — 600V

Amps: — 0-20A

Agency Information:

CSA - 15A.

Catalog Numbers

HEH-AA, HEH-BB, HEH-AD

Data Sheet: 2124

HEC Series



Specifications

Description: Single-pole, non-breakaway, in-line fuse holders for Type SC-25, & SC-30 fuses, size 1³/₃₂" x 1⁵/₈".

Ratings:

Volts: — 480V

Amps: — 0-30A

Catalog Numbers

HEC-AA, HEC-RW-RLB-R

Data Sheet: 2124

HEJ Series



Specifications

Description: Single-pole, non-breakaway, in-line fuse holders for Type SC and Type HVW fuses, size 1³/₃₂" x 2¹/₄".

Ratings:

Volts: — 480V

Amps: — 35-60A Type SC

— 1/2-6A Type HVW

Catalog Numbers

HEJ-AA, HEJ-AB, HEJ-AC, HEJ-BB, HEJ-JJ, HEJ-JK, HEJ-LL, HEJ-LLB, HEJ-CC, HEJ-DD, HEJ-WW, HEJ-PP, HEJ-QQ

Data Sheet: 2123

HEB Series



Specifications

Description: Single-pole in-line fuse holders for any 1³/₃₂" x 1¹/₂" fuses (typically fuse types: BAF, FNM, FNQ, and KTK 1/0 - 30A).

Ratings:

Volts: — 600V

Amps: — 0-30A

Catalog Numbers

See Page 261

Data Sheet: 2127

HET Series



Specifications

Description: Single-pole in-line fuse holders for 1³/₃₂" x 1¹/₂" fuses with a permanently solid neutral identified by white plastic coupling nut.

Catalog Numbers

HET-AA, HET-AB, HET-AW, HET-AW-RCL-A, HET-AW-RCL-B, HET-AW-RCL-C, HET-AW-RCL-J, HET-AW-RYC, HET-BB, HET-BW-RLC-B, HET-BW-RYC, HET-JJ, HET-JK, HET-JW, HET-JW-RLC-J, HET-JW-RYC, HET-KK

Data Sheet: 2125

HEY Series



Specifications

Description: Double-pole in-line fuse holders for KTK-R fuses with optional breakaway receptacle, polarized, and accepting Class CC branch circuit fuses (Cooper Bussmann KTK-R, FNQ-R & LP-CC; 600V or less, 200,000A IR).

Ratings:

Volts: — 600V

Amps: — 0-30A

Catalog Numbers

HEY-AA, HEY-AB, HEY-AC, HEY-AD, HEY-AE, HEY-AL, HEY-AW-DRLC-A, HEY-AW-DRLC-B, HEY-AW-DRYC, HEY-BB, HEY-JJ

Data Sheet: 2126

HEX Series



Specifications

Description: Double-pole in-line fuse holders for 1³/₃₂" x 1¹/₂" fuses (typically fuse types BAF, FNM, FNQ, and KTK 1/0 - 30A).

Ratings:

Volts: — 600V

Amps: — 0-30A

Catalog Numbers

HEX-AA, HEX-AB, HEX-AC, HEX-AD, HEX-AE, HEX-AW, HEX-AW-DRLC-A, HEX-AW-DRYC, HEX-AY, HEX-BB, HEX-CC, HEX-JJ, HEX-JK, HEX-JW-DRYC, HEX-KK

Data Sheet: 2126

Fuse Holders & Blocks

Fuse Holders and Blocks

For HEB holders only

Directions: To select complete holder P/N, work from left to right starting with load terminal options and then line terminal options. Then determine breakaway or non-breakaway style.

Catalog Numbers		Load Terminal					Line Terminal				
Non-Breakaway Catalog Numbers (Boots not included)	Breakaway Catalog Numbers (Boots included)	Terminal Type	Wire Size	No. of Wires per Terminal	Solid Wire	Stranded Wire	Terminal Type	Wire Size	No. of Wires per Terminal	Solid Wire	Stranded Wire
HEB-AA(1)(2)(3)	HEB-AW-RLC-A(1)(2)(3)	Copper Crimp	#12 to #8 #12	1 2	Y Y	Y Y	Copper Crimp	#12 to #8 #12	1 2	Y Y	Y Y
HEB-AB(2)	HEB-AW-RLC-B	Copper Crimp	#12 to #8 #12	1 2	Y Y	Y Y	Copper Crimp	#6 to #4 #10	1 2	Y Y	Y Y
HEB-AC(2)	HEB-AW-RLC-C	Copper Crimp	#12 to #8 #12	1 2	Y Y	Y Y	Copper Crimp	#4 #8	1 2	N Y	Y Y
HEB-AD(2)	N/A	Copper Crimp	#12 to #8 #12	1 2	Y Y	Y Y	Copper Crimp	#2 #6	1 2	N Y	Y Y
HEB-AE(2)	N/A	Copper Crimp	#12 to #8 #12	1 2	Y Y	Y Y	Copper Crimp	2/0 #3	1 2	N N	Y Y
HEB-AJ	HEB-AW-RLC-J	Copper Crimp	#12 to #8 #12	1 2	Y Y	Y Y	Copper Set-Screw	#12 to #3	1	Y	Y
HEB-AK	HEB-AW-RYC	Copper Crimp	#12 to #8 #12	1 2	Y Y	Y Y	Copper set-screw	#12 to #3	2	Y	Y
HEB-AL	HEB-AW-RLA	Copper Crimp	#12 to #8 #12	1 2	Y Y	Y Y	Aluminum Set-Screw	#12 to #2	1	Y	Y
HEB-AY	HEB-AW-RYA	Copper Crimp	#12 to #8 #12	1 2	Y Y	Y Y	Aluminum Set-Screw	#12 to #2	2	Y	Y
HEB-AR	N/A	Copper Crimp	#12 to #8 #12	1 2	Y Y	Y Y	Aluminum Crimp	#1, #2	1	N	Y
HEB-BA(2)	HEB-BW-RLC-A	Copper Crimp	#6, #4 #10	1 2	Y Y	Y Y	Copper Crimp	#12 to #8 #12	1 2	Y Y	Y Y
HEB-BB(2)	HEB-BW-RLC-B	Copper Crimp	#6, #4 #10	1 2	Y Y	Y Y	Copper Crimp	#6, #4 #10	1 2	Y Y	Y Y
HEB-BC(2)	N/A	Copper Crimp	#6, #4 #10	1 2	Y Y	Y Y	Copper Crimp	#4 #8	1 2	N Y	Y Y
HEB-BD(2)	N/A	Copper Crimp	#6, #4 #10	1 2	Y Y	Y Y	Copper Crimp	#2 #6	1 2	N Y	Y Y
HEB-CC(2)	N/A	Copper Crimp	#4 #8	1 2	N Y	Y Y	Copper Crimp	#4 #8	1 2	N Y	Y Y
HEB-DD(2)	N/A	Copper Crimp	#2 #6	1 2	N Y	Y Y	Copper Crimp	#2 #6	1 2	N Y	Y Y
HEB-ZA	N/A	Copper Crimp	#20, #18	1	Y	Y	Copper Crimp	#12 to #8 #12	1 2	Y Y	Y Y
HEB-JJ	HEB-JW-RLC-J	Copper Set-Screw	#12 to #3	1	Y	Y	Copper Set-Screw	#12 to #3	1	Y	Y
HEB-JK	HEB-JW-RYC	Copper Set-Screw	#12 to #3	1	Y	Y	Copper Set-Screw	#12 to #3	2	Y	Y
HEB-JL	N/A	Copper Set-Screw	#12 to #3	1	Y	Y	Aluminum Set-Screw	#12 to #2	1	Y	Y
HEB-JY	N/A	Copper Set-Screw	#12 to #3	1	Y	Y	Aluminum Set-Screw	#12 to #2	2	Y	Y
HEB-LL	HEB-LW-RLA	Aluminum Set-Screw	#12 to #2	1	Y	Y	Aluminum Set-Screw	#12 to #2	1	Y	Y
HEB-NN	N/A	Aluminum Crimp	#8 #6	1 1	N Y	Y N	Aluminum Crimp	#8 #6	1 1	N Y	Y N
HEB-PP(2)	N/A	Aluminum Crimp	#6 #4	1 1	N Y	Y N	Aluminum Crimp	#6 #4	1 1	N Y	Y N
HEB-QQ(2)	N/A	Aluminum Crimp	#3, #4 #2	1 1	N Y	Y N	Aluminum Crimp	#3, #4 #2	1 1	N Y	Y N
HEB-RR(2)	N/A	Aluminum Crimp	#1, #2	1	N	Y	Aluminum Crimp	#1, #2	1	N	Y
HEB-TT(2)	N/A	Aluminum Crimp	1/0	1	N	Y	Aluminum Crimp	1/0	1	N	Y
HEB-SS	N/A	Solid Terminal for aluminum connector	#8 to #12 #10 to #14	1 1	Y N	N Y	Solid Terminal for aluminum connector	#8 to #12 #10 to #14	1 1	Y N	N Y

(1) UL Recognized, Guide IZLT2, File E14853

(2) CSA Certified, Class 6225-01, File 47235

(3) CE

For custom terminations contact your Cooper Bussmann representative.

Panel mounted fuse holders for 5 x 20mm fuses

HTC-30M

Ratings:

Volts: — 250V

Amps: — 6.3A

Watts: — 2.5W

Fuse Access: Screwdriver slot

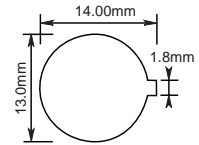
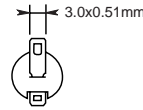
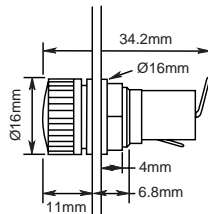

Data Sheet: 2110

HTC-35M

Ratings:

Volts: — 250V

Amps: — 6.3A

Watts: — 2.5W

Fuse Access: Threaded cap

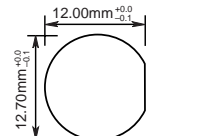
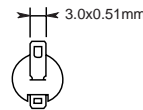
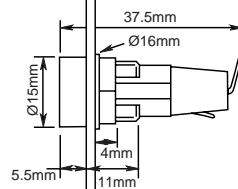

Data Sheet: 2110

HTC-40M

Ratings:

Volts: — 250V

Amps: — 6.3A

Watts: — 2.5W

Fuse Access: Screwdriver slot

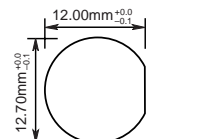
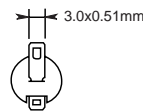
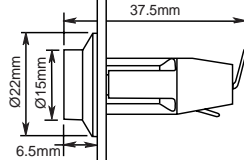

Data Sheet: 2110

HTC-55M

Ratings:

Volts: — 250V

Amps: — 6.3A

Watts: — 2.5W

Fuse Carrier: Bayonet type

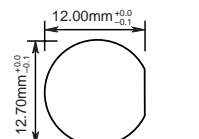
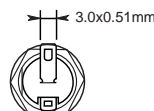
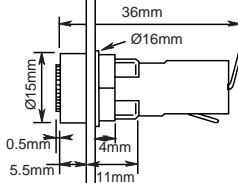

Data Sheet: 2110

HTC-70M

Ratings:

Volts: — 250V

Amps: — 10A

Watts: — 2.5W

Fuse Carrier: Bayonet type

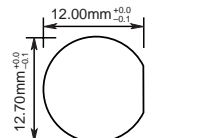
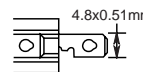
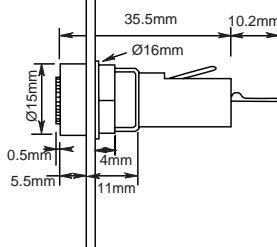

Data Sheet: 2110

Specifications

- Terminals:** Tin-plated brass.
- Molded Materials:** High temperature thermoplastic that meets the flammability ratings of UL 94V0; Glow Wire Test: 960°C per IEC 60695-2-1.
- Solderability:** In accordance with IEC 68-2-20.
- Agency Information:** ROHS Compliant, CE, UL Recognized — Guide IZLT2, File E14853, CSA Certified — Class 6225-01, File 47235, SEMKO — 9226031 (HTC-30M, HTC-35M); 9226032 (HTC-40M); 9226033 (HTC-55M); 9226034 (HTC-70M)
- Electrical:** Contact Resistance: ≤ 10mΩ; Insulation Resistance: ≥ 10mΩ; Dielectric Strength ≥ 2000Vac.
- Shock Safety:** PC2 (fuse holders).
- Packaging:** Standard Qty 10 (No Prefix), Bulk Qty 100 (Prefix Catalog Number with BK/).

Fuse Holders & Blocks

Fuse Holders and Blocks

Panel mounted fuse holders for ¼" x 1¼" fuses

HKP, HKP-L, HKP-W



Specifications

Description: Standard fuse holders.

Dimensions: See Dimensions illustration.

Ratings:

Volts: — 250V

Amps: — 30A

Catalog Numbers

Catalog Numbers	Fuse Description
HKP	—
HKP-L	HKP w/ 2250V stand-off barrier
HKP-W	HKP w/ drip-proof knob

Dimensions

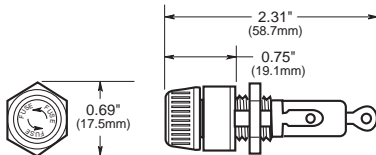

Punched Mounting Hole

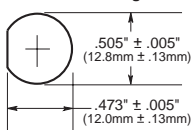

Data Sheet: 2106

HKP-BBHH, HKP-HH and HKP-LW-HH



Specifications

Description: Fuse holders with ¼" quick-connects.

Dimensions: See Dimensions illustration.

Ratings:

Volts: — 250V

Amps: — 15A

Catalog Numbers

Catalog Numbers	Fuse Description
HKP-BBHH	HKP w/ ¼" quick-connects, nut and washer assembled.
HKP-HH	HKP w/ ¼" quick-connect.
HKP-LW-HH	HKP w/ drip-proof knob, 2250V stand-off barrier and quick-connects.

Dimensions

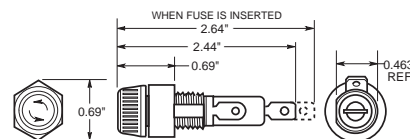

Punched Mounting Hole

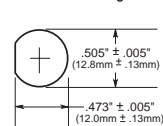

Drilled Mounting Hole

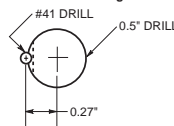

Data Sheet: 2106

HKP-OO



Specifications

Description: Snap-lock fuse holders.

Dimensions: See Dimensions illustration.

Ratings:

Volts: — 250V

Amps: — 30A

Catalog Numbers

Catalog Number	Fuse Description
HKP-OO	HKP with snap-lock

Dimensions

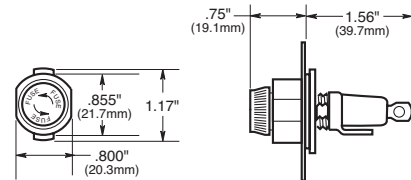

Punched Mounting Hole

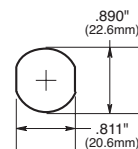

Data Sheet: 2106

Specifications

Terminals: Bayonet-type knob.
Vibration resistant.
For panels up to ⅝" (7.9mm) thick.

Agency Information: CE, UL Recognized — Guide IZLT2, File E14853, CSA Certified — Class 6225-01, File 47235

Replacement Parts: Knob: 9435-1/2"
Plastic Nut: BK/1A4287
Metal Nut: BK/1A4806-2
Washer: 9732

Fuse Holders and Blocks

Panel mounted fuse holders for 5 x 20mm and ¼" x 1 ¼" fuses

HTB Series

Specifications

Description: Fuse holders with knob-type carriers.

Dimensions: See Dimensions illustrations.

Construction: High temperature, flame retardant thermo-plastic; UL Component Recognized; UL 94V0; mounting nut, spacer-black polycarbonate. Terminals: tin-plated brass.

Electrical Data: Insulation resistance (per IEC #257) — 10,000 ohms @ 500Vdc; contact resistance (per IEC #257) — 0.005 ohms Max @ 1A; standoff voltage (per IEC #257) — 480V/Mil @ 0.125" thickness.

Agency Information: CE, UL Recognized — Guide IZLT2, File E14853, 20A (3/16" quick-connect 15A) @ 250V, CSA — 16A @ 250V Class 6225-01 File 47235; VDE* — 6.3A @ 250V, 49890, SEMKO* — 6.3A @ 250V, 8945092, 9005230.

Mounting: Withstands 15 to 20 lbs-ins torque to mounting nut when mounting fuse holder to panel. Maximum panel thickness 0.300 inches.

Environmental: Maximum operating temperature - 55/+85°C.

*Screwdriver slot carrier only.



Knob Type Carrier	Maximum Panel Thickness	Terminal Options				Carrier Options	
		Solder/ ⅜" Quick-Connect		¼" Quick-Connect		¼" x 1 ¼" ("I" Equals Inches)	5 x 20mm ("M" Equals Metric)
		In-Line	Rt. Angle	In-Line	Rt. Angle	Knob	Knob
Common Dimensions: Length (Knob Type) - 1.69" (42.9mm) Plus In-Line Terminal (Screwdriver Slotted) 1.75" (44.5mm) NOTE: Plus In-Line Terminal	 0.30"	HTB-22I	HTB-24I	HTB-26I	HTB-28I	X	
	7.62mm	HTB-22M	HTB-24M	HTB-26M	HTB-28M		X
 0.125"	HTB-42I	HTB-44I	HTB-46I	HTB-48I	X		
	3.18mm	HTB-42M	HTB-44M	HTB-46M	HTB-48M		X
 0.30"	HTB-62I	HTB-64I	HTB-66I	HTB-68I	X		
	7.62mm	HTB-62M	HTB-64M	HTB-66M	HTB-68M		X
 0.125"	HTB-82I	HTB-84I	HTB-86I	HTB-88I	X		
	3.18mm	HTB-82M	HTB-84M	HTB-86M	HTB-88M		X

Fuse holders and fuse carriers may be ordered separately.

Data Sheet: 2119

Fuse Holders and Blocks

Panel mounted fuse holders for 5 x 20mm and 1/4" x 1 1/4" fuses

HTB Series



Knob Type Carrier	Maximum Panel Thickness	Terminal Options				Carrier Options	
		Solder/ 3/16" Quick-Connect		1/4" Quick-Connect		1/4" x 1 1/4" ("I" Equals Inches)	5 x 20mm ("M" Equals Metric)
		In-Line	Rt. Angle	In-Line	Rt. Angle	Knob	Knob
Common Dimensions: Length (Knob Type) - 1.69" (42.9mm) Plus In-Line Terminal (Screwdriver Slotted) 1.75" (44.5mm) NOTE: Plus In-Line Terminal							
 HTB-3	0.30" 7.62mm	HTB-32I	HTB-34I	HTB-36I	HTB-38I	X	
 HTB-5	0.125" 3.18mm	HTB-52I	HTB-54I	HTB-56I	HTB-58I	X	
 HTB-9	0.125" 3.18mm	HTB-92I	HTB-94I	HTB-96I	HTB-98I	X	

Catalog Number Build-A-Code

<input type="text"/>	<input type="text"/>	<input type="text"/>	<input type="text"/>	<input type="text"/>	<input type="text"/>	<input type="text"/>	<input type="text"/>	<input type="text"/>	<input type="text"/>	<input type="text"/>	<input type="text"/>
Packing (Blank) - Std. BK/ - Bulk	Product Symbol				Fuse Carrier I - 1/4" x 1-1/4" M - 5mm x 20mm	Splash Proof (Optional on -2, -4, -6, and -8)					
Body Configuration and Mounting Finger Grip Holders 2 - Low Profile (Rear Panel Hex-Nut) 4 - High Profile *6 - (Front Panel Hex-Nut) 8 - Low Profile (Snap-In) Screwdriver Slotted Holders 3 - Low Profile 5 - High Profile 9 - Low Profile (Snap-In)			Rear Terminal Configuration 2 - Solder/3/16" Quick-Connect (In-Line) 4 - Solder/3/16" Quick-Connect (Right Angle) 6 - 1/4" Quick-Connect (In-Line) 8 - 1/4" Quick-Connect (Right Angle)			FUSE CARRIER ONLY Packaging (Blank) - Std. BK/ - Bulk Product Symbol FT - Knob Type (For 20, 40, 60, and 80 Series Only) ST - Screwdriver Slotted (For 30, 50, and 90 Series Only) Fuse Carrier I - 1/4" x 1 1/4" M - 5mm x 20mm					

*Profile varies with panel thickness. Holder installs thru rear of panel.

Panel mounted fuse holders for indicating type fuses

HLD



Specifications

Description: Pin indicating for ¼" x 1¼" fuses.

Dimensions: See Dimensions illustration.

Ratings:

Volts: — 250V

Amps: — 15A

Agency Information: CE, UL Recognized, (File E14853, Guide IZLT2).

Catalog Numbers

Catalog Numbers*	Terminals
HLD	Solder terminals
HLD-HH	¼" quick-connect terminals

*Use w/GBA, GLD Fuses

Dimensions

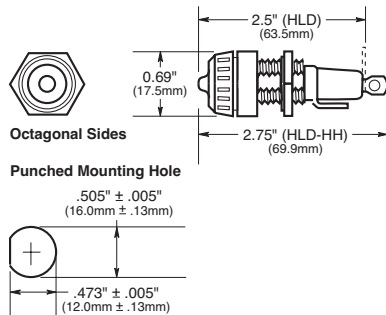

Data Sheet: 2120

HJL



Specifications

Description: Neon lamp indicating for ¼" x 1" fuses.

Dimensions: See Dimensions illustration.

Ratings:

Volts: — 250V

Amps: — 15A

Agency Information: None

Catalog Number

Catalog Number*	Volts	Lamp Color	Knob Type
HJL	90 to 250	Clear	Oct

*Use with AGX or MKB fuses, for panels up to ¼" thick.

Dimensions

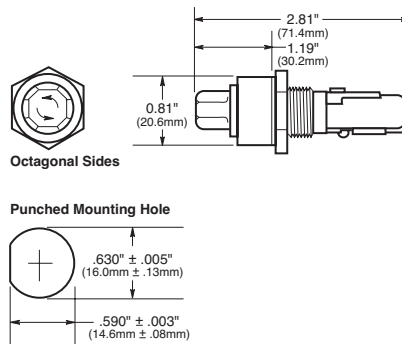

Data Sheet: 2121

HK Series



Specifications

Description: Neon and incandescent lamp indicating for ¼" x 1¼" fuses

Dimensions: See Dimensions illustration.

Ratings:

Volts: — 250V

Amps: — 15A (HKL, HKL-X)

— 20A (HKR, HKT, HKU, HKX)

Agency Information: CE, UL Recognized, (Guide IZLT2, File E14853), CSA Certified (Class 6225-01, File 47235).

Catalog Numbers

Catalog Numbers	Lamp Volts	Knob Color/Type
HKL*	90-250	Clear/Oct
HKL-X*		Clear/FS
HKR**	22-30	Amber/Oct
HKT**	13-22	Amber/Oct
HKU**	4-6	Red/Oct
HKX**	22-33	Amber/FS

* Neon lamp — UL Recognized and CSA Certified

** Incandescent lamp

Dimensions

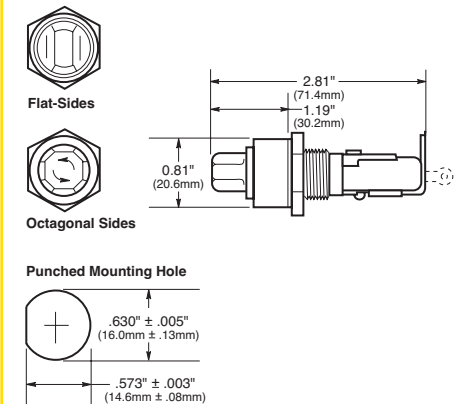

Data Sheet: 2105

Fuse Holders & Blocks

Fuse Holders and Blocks

Panel mounted fuse holders for 1 1/2" x 1 5/16" to 1 1/2" fuses

HPF



Specifications

Description: Standard fuse holders with screw-type knob for 1 1/2" x 1 5/16" to 1 1/2" Fuses.

Dimensions: See Dimensions illustration.

Agency Information: CE, UL Recognized, (Guide IZLT2, File E14853) CSA Certified (Class 6225-01, File 47235).

Flammability Rating: UL 94HB.

Terminals: Combination 1/4" quick-connect/solder terminals.

Catalog Numbers

Catalog Numbers	Amp Ratings	Volts	Fuse Description
HPF	30(3)	600	1 1/2" (38.1mm)
HPF-C	30(4)	600(4)	1 1/2" (38.1mm) clear knob.
HPF-L	5	600	BBS, 1/2" x 1 3/8" fuses.
HPF-EE	15	600	SC 0-15, 1/2" x 1 5/16" fuses.
HPF-JJ	20	600	SC 20, 1/2" x 1 5/16" fuses.
HPF-FF(2)	30(3)	480	SC 25 & 30, 1/2" x 1 5/16" fuses.
HPF-RR	30(3)	600	KTK-R, LP-CC & FNQ-R Class CC fuses.
HPF-WT	30(3)	600	Splash-proof knob. 1/2" x 1 5/16" (38.1mm)

- (2) No CSA Certification
- (3) 20A max when used with quick-connect terminals.
- (4) HPF-C ratings for CSA-15A, 250V

Dimensions

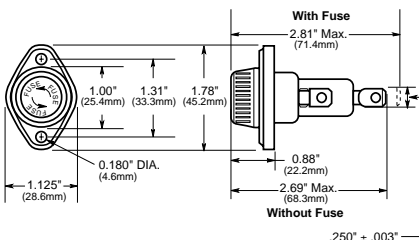

Data Sheet: 2114

HPS



Specifications

Description: Standard fuse holders with bayonet-type knob for 1 1/2" x 1 5/16" to 1 1/2" fuses.

Dimensions: See Dimensions illustration.

Agency Information: CE, UL Recognized, (Guide IZLT2, File E14853) CSA Certified (Class 6225-01, File 47235).

Flammability Rating: UL 94HB.

Terminals: Combination 1/4" quick-connect/solder terminals.

Catalog Numbers

Catalog Symbol	Amp Ratings	Volts	Fuse Description
HPS	30(3)(4)	600	1 1/2" x 1 5/16"
HPS-L	5	600	BBS, 1/2" x 1 3/8" fuses.
HPS-EE*	15	600	SC 0-15, 1/2" x 1 5/16" fuses.
HPS-JJ*	20	600	SC 20, 1/2" x 1 5/16" fuses.
HPS-F-EE(2)15	600		Sleeve on body, leaded for 1/2" x 1 5/16" fuses.
HPS-FF*(2)	30(3)	480	SC 25 & 30, 1/2" x 1 5/16" fuses.
HPS-RR*(2)	30(3)	600	KTK-R, LP-CC, FNQ-R Class CC fuses.

- *-EE, -JJ, -FF and -RR versions are UL Recognized for applications requiring branch circuit protection.
- (1) No UL Recognition
- (2) No CSA Certification
- (3) 20A max when used with quick-connect terminals.
- (4) HPS rated at 25V for CSA

Dimensions

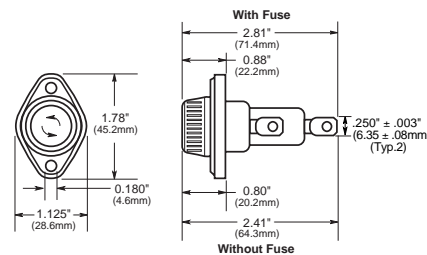

Data Sheet: 2113

HPG



HPD



Specifications

Description: Standard fuse holders with bayonet-type knob for 1 1/2" x 1 5/16" fuses.

Dimensions: See Dimensions illustrations.

Agency Information: CE, UL Recognized, (Guide IZLT2, File E14853).

Flammability Rating: UL 94V0 - fuse holder body UL 94HB - Knob.

Catalog Numbers

Catalog Numbers	Amp Ratings	Volts	Fuse Description
HPG*	30(3)	600	1 1/2" x 1 5/16" fuses
HPG-EE*	15	600	SC 0-15, 1/2" x 1 5/16" fuses.
HPD**	30(3)	600	1 1/2" x 1 5/16" fuses

- (3) 20A max when used with quick-connect terminals.
- *HPG and HPG-EE has combination 1/4" quick-connect/solder terminals on both side (load) and rear (line) terminals.
- **HPD has combination 1/4" quick-connect/solder terminal on side (load) terminal only. Rear (line) terminal is 3/8" shorter than HPG. Rear terminal solder only.

Dimensions

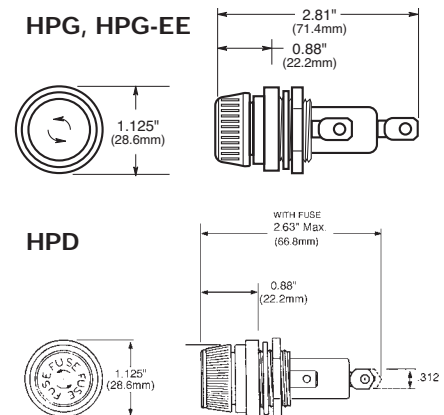

Data Sheet: 2108