

PART NAME	LARGE NON-METALLIC ENCLOSURE (STYLE D)	PART No.	NBD-10442 & NBD-10462 & NBD-15442
-----------	--	----------	-----------------------------------

MATERIAL:	FINISH:	INDUSTRY STANDARDS:
INDOOR RATED	BODY _____ LIGHT GRAY	INDOOR RATED
SOLID BODY & COVER _____ ABS/PC BLENDED PLASTIC	COVER _____ LIGHT GRAY OR CLEAR	UL508 TYPE 1, 2, 4, 4X INDOOR, 12 & 13
UL94-5VB FLAMMABILITY RATING		NEMA TYPE 1, 2, 4, 4X, 12 & 13
-40°C TO +70°C TEMPERATURE RANGE	COVER IS GASKETED.	IEC529, IP66
CLEAR COVER _____ POLYCARBONATE PLASTIC		
UL94-VD FLAMMABILITY RATING	NOTE: COVER ATTACHES WITH PHILLIPS DRIVE	OUTDOOR RATED
-40°C TO +70°C TEMPERATURE RANGE	NON-METALLIC SCREWS. (NOT SHOWN)	UL508 TYPE 1, 2, 4, 4X, 12 & 13
UV STABILIZED		NEMA TYPE 1, 2, 4, 4X, 12 & 13
		IEC529, IP66

OUTDOOR RATED	SOLID BODY & COVER _____ PBT/PC BLENDED PLASTIC
UL94-5VA FLAMMABILITY RATING	
-40°C TO +70°C TEMPERATURE RANGE	
UV STABILIZED	

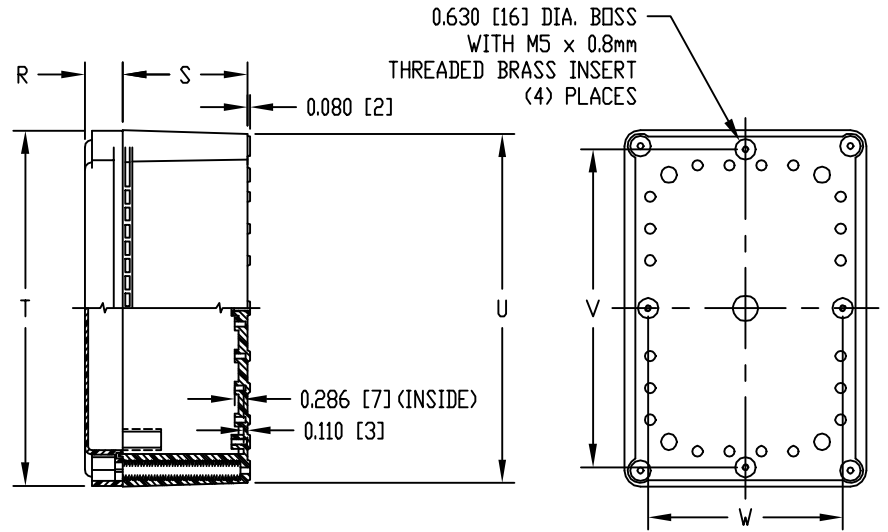
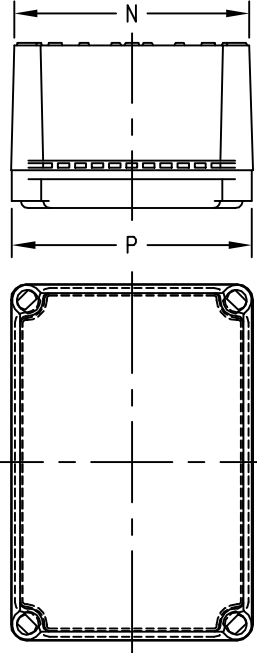

AIR AND MOISTURE VENTS, STAINLESS STEEL LOCKING HASP, PANEL MOUNTING RAILS, GALVANIZED STEEL INNER PANEL AND STAINLESS STEEL WALL MOUNTING BRACKETS ARE NOT INCLUDED, BUT CAN BE PURCHASED SEPARATELY.

DIMENSIONS = INCHES
[MILLIMETERS]

NOTE: ALL DIMENSIONS HAVE ±0.039 [±1] TOLERANCE UNLESS OTHERWISE SPECIFIED

INDOOR RATED		OUTDOOR RATED	(4) PLACES										BE PURCHASED SEPARATELY.										NOTE: ALL DIMENSIONS HAVE ±0.039 [±1] TOLERANCE UNLESS OTHERWISE SPECIFIED									
PART NO.		PART NO.	DIMENSIONS																													
SOLID COVER	CLEAR COVER	SOLID COVER	A	B	C	D	E	F	G	H	J	K	L	M	N	P	R	S	T	U	V	W										
NBD-10442	NBD-10462	NBD-15442	7.485 [190]	6.663 [169]	6.496 [165]	5.890 [150]	4.736 [120]	2.958 [75]	11.024 [280]	10.474 [266]	10.039 [255]	8.850 [225]	8.263 [210]	6.902 [175]	7.280 [185]	7.420 [188]	1.181 [30]	3.850 [98]	10.984 [279]	10.805 [274]	9.838 [250]	6.027 [153]										