



We Tame Photons to Work for You!



Products > LEDs > Thru-Hole > Round > 5mm > InspirationLEDs



### Features / Options

- ▶ State-of-the-Art, High Brightness Chip Technology
- ▶ Choice of Colors and Lens Finishes
- ▶ Lead Frame / Lens Casting Reliability
- ▶ Easy-to-Solder Leads, Tin Finish
- ▶ Available Bulk or on Tape and Reel
- ▶ Lead Trimming and Forming Available
- ▶ Custom Shapes, Easily Tooled, Low Minimum

### Applications / Uses

- ▶ Soft Lighting Applications
- ▶ Medical Diagnostics Indicators
- ▶ Board or Panel Indication or Illumination
- ▶ Annunciator and Control Panels
- ▶ Telecom Switches and Central Station Equipment
- ▶ Large Panel Indicators

| Part Number: | Brightness | Dice Material | Emitted Color | Peak Wavelength | Epoxy Lens | Operating Typ Vf (V) | Intensity Typ, mcd @ 20 mA | View Angle 2x Theta |  |   |
|--------------|------------|---------------|---------------|-----------------|------------|----------------------|----------------------------|---------------------|--|---|
| SSL-LX5093PC | HIGH       | InGaN         | Pink          | -               | Clear      | 3.5                  | 2200                       | 20                  |  | — |
| SSL-LX5093TC | HIGH       | InGaN         | Turquoise     | -               | Clear      | 3.5                  | 2200                       | 20                  |  | — |
| SSL-LX5093VC | HIGH       | InGaN         | Purple        | -               | Clear      | 3.5                  | 2200                       | 20                  |  | — |

UNCONTROLLED DOCUMENT

PART NUMBER  
SSL-LX5093TC

REV.

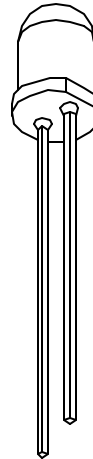
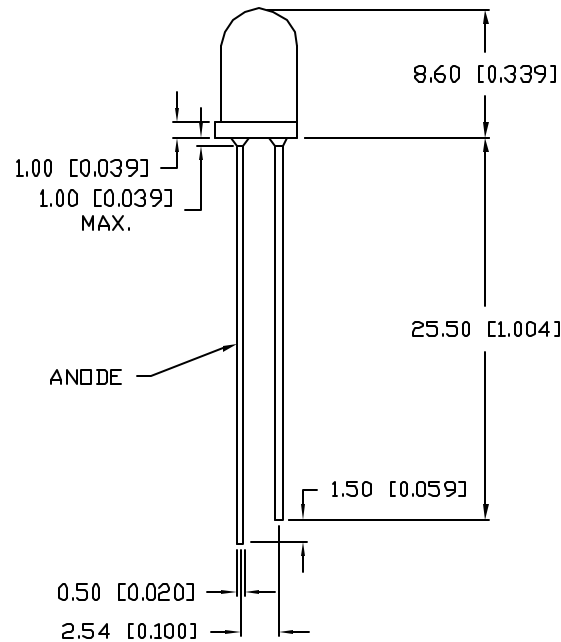
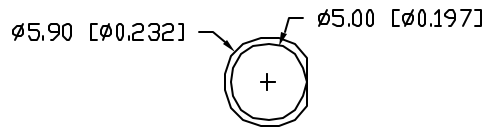

ELECTRO-OPTICAL CHARACTERISTICS  $T_A=25^\circ\text{C}$

| PARAMETER                    | SYMBOL      | MIN | TYP  | MAX | UNITS    | TEST COND           |
|------------------------------|-------------|-----|------|-----|----------|---------------------|
| PEAK WAVELENGTH              |             |     | -    |     | nm       |                     |
| FORWARD VOLTAGE              | $V_f$       |     | 3.2  | 4.0 | V        | $I_f=20\text{mA}$   |
| REVERSE VOLTAGE              | $V_r$       | 5   |      |     | V        | $I_r=10\mu\text{A}$ |
| AXIAL INTENSITY(*1)          | $I_v$       | 900 | 2200 |     | mcd      | $I_f=20\text{mA}$   |
| CHROMATICITY COORDINATES(*2) | X           |     | 0.19 |     |          | $I_f=20\text{mA}$   |
|                              | Y           |     | 0.41 |     |          |                     |
| VIEWING ANGLE                |             |     | 20   |     | 2x theta |                     |
| EMITTED COLOR:               | TURQUOISE   |     |      |     |          |                     |
| EPOXY LENS FINISH:           | WATER CLEAR |     |      |     |          |                     |

\*1. AXIAL INTENSITY TESTING CONDITION: 550nm WAVELENGTH.  
\*2. THE ICI STANDARD COLORIMETRIC SYSTEM.

LIMITS OF SAFE OPERATION AT 25°C

| PARAMETER             | SYMBOL    | MAX        | UNITS      |
|-----------------------|-----------|------------|------------|
| PULSE FORWARD CURRENT | $I_p$     | 100*       | mA         |
| STEADY CURRENT        | $I_f$     | 30         | mA         |
| POWER DISSIPATION     | $P_D$     | 120        | mW         |
| OPERATING TEMP.       | $T_{OPR}$ | -40 TO +85 | °C         |
| STORAGE TEMP.         | $T_{STG}$ | -40 TO +85 | °C         |
| SOLDERING TEMP.       |           | +260       | °C         |
| 2.0mm FROM BODY       |           |            | 3 SEC. MAX |

\*DUTY 1/10 PULSE WIDTH 10ms

CAUTION: STATIC SENSITIVE DEVICE  
FOLLOW PROPER E.S.D. HANDLING PROCEDURES  
WHEN WORKING WITH THIS PART.



UNCONTROLLED DOCUMENT

\*UNLESS OTHERWISE SPECIFIED TOLERANCES PER DECIMAL PRECISION ARE: X=±1 (±0.039), X.X=±0.5 (±0.020), X.XX=±0.25 (±0.010), X.XXX=±0.127 (±0.005), LEAD SIZE=±0.05 (±0.002), LEAD LENGTH=±0.75 (±0.030), MIN= <sup>+0.00</sup>-0.00, MAX= <sup>+0.00</sup>-0.00

REV.

PART NUMBER  
SSL-LX5093TC

CONFIDENTIAL INFORMATION  
THE INFORMATION CONTAINED IN THIS DOCUMENT IS THE PROPERTY OF LUMEX INC. EXCEPT AS SPECIFICALLY AUTHORIZED IN WRITING BY LUMEX INC, THE HOLDER OF THIS DOCUMENT SHALL KEEP ALL INFORMATION CONTAINED HEREIN CONFIDENTIAL AND SHALL PROTECT SAME IN WHOLE OR IN PART FROM DISCLOSURE AND DISSEMINATION TO ALL THIRD PARTIES.



T-5mm TURQUOISE LED,  
WATER CLEAR LENS.

RELIABILITY NOTE  
OUR MANY YEARS OF EXPERIENCE DATA ACCUMULATION INDICATE THAT SOLDER HEAT IS A MAJOR CAUSE OF EARLY AND FUTURE FAILURE. PLEASE PAY ATTENTION TO YOUR SOLDERING PROCESS.

|                 |             |              |  |
|-----------------|-------------|--------------|--|
| DRAWN BY:<br>JN | CHECKED BY: | APPROVED BY: | DATE: 02.06.08<br>PAGE: 1 OF 1<br>SCALE: N/A |
|-----------------|-------------|--------------|--|