

# MMSZ4678T1 Series

Preferred Device

## Zener Voltage Regulators

### 500 mW SOD-123 Surface Mount

Three complete series of Zener diodes are offered in the convenient, surface mount plastic SOD-123 package. These devices provide a convenient alternative to the leadless 34-package style.

#### Features

- 500 mW Rating on FR-4 or FR-5 Board
- Wide Zener Reverse Voltage Range – 1.8 V to 43 V
- Package Designed for Optimal Automated Board Assembly
- Small Package Size for High Density Applications
- ESD Rating of Class 3 (>16 kV) per Human Body Model
- Pb-Free Packages are Available

#### Mechanical Characteristics:

**CASE:** Void-free, transfer-molded, thermosetting plastic case

**FINISH:** Corrosion resistant finish, easily solderable

**MAXIMUM CASE TEMPERATURE FOR SOLDERING PURPOSES:**

260°C for 10 Seconds

**POLARITY:** Cathode indicated by polarity band

**FLAMMABILITY RATING:** UL 94 V-0

#### MAXIMUM RATINGS

Rating	Symbol	Max	Unit
Total Power Dissipation on FR-5 Board, (Note 1) @ $T_L = 75^\circ\text{C}$ Derated above $75^\circ\text{C}$	$P_D$	500 6.7	mW mW/°C
Thermal Resistance, (Note 2) Junction-to-Ambient	$R_{\theta JA}$	340	°C/W
Thermal Resistance, (Note 2) Junction-to-Lead	$R_{\theta JL}$	150	°C/W
Junction and Storage Temperature Range	$T_J, T_{stg}$	-55 to +150	°C

Maximum ratings are those values beyond which device damage can occur. Maximum ratings applied to the device are individual stress limit values (not normal operating conditions) and are not valid simultaneously. If these limits are exceeded, device functional operation is not implied, damage may occur and reliability may be affected.

1. FR-5 = 3.5 X 1.5 inches, using the minimum recommended footprint.
2. Thermal Resistance measurement obtained via infrared Scan Method.



ON Semiconductor®

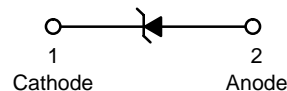

SOD-123  
CASE 425  
STYLE 1

#### MARKING DIAGRAM

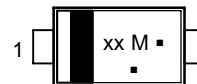

xx = Device Code (Refer to page 3)  
M = Date Code  
▪ = Pb-Free Package  
(Note: Microdot may be in either location)

#### ORDERING INFORMATION

Device	Package	Shipping†
MMSZ4xxxT1	SOD-123	3000/Tape & Reel
MMSZ4xxxT1G	SOD-123 (Pb-Free)	3000/Tape & Reel
MMSZ4xxxT3	SOD-123	10000/Tape & Reel
MMSZ4xxxT3G	SOD-123 (Pb-Free)	10000/Tape & Reel

†For information on tape and reel specifications, including part orientation and tape sizes, please refer to our Tape and Reel Packaging Specifications Brochure, BRD8011/D.

#### DEVICE MARKING INFORMATION

See specific marking information in the device marking column of the Electrical Characteristics table on page 3 of this data sheet.

Devices listed in **bold, italic** are ON Semiconductor **Preferred** devices. **Preferred** devices are recommended choices for future use and best overall value.

## MMSZ4678T1 Series

**ELECTRICAL CHARACTERISTICS** ( $T_A = 25^\circ\text{C}$  unless otherwise noted,  $V_F = 0.95\text{ V Max. @ } I_F = 10\text{ mA}$ )

Symbol	Parameter
$V_Z$	Reverse Zener Voltage @ $I_{ZT}$
$I_{ZT}$	Reverse Current
$I_R$	Reverse Leakage Current @ $V_R$
$V_R$	Reverse Voltage
$I_F$	Forward Current
$V_F$	Forward Voltage @ $I_F$

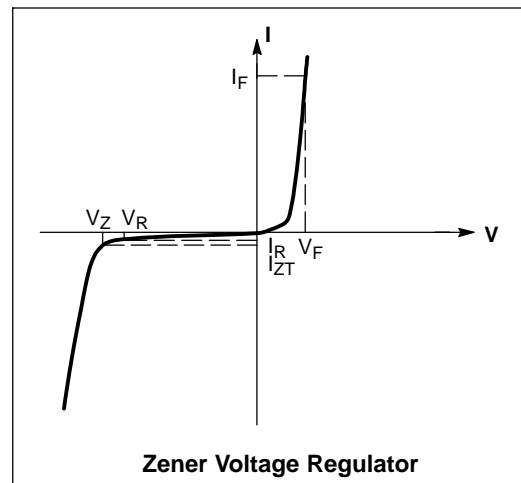

## MMSZ4678T1 Series

**ELECTRICAL CHARACTERISTICS** ( $T_A = 25^\circ\text{C}$  unless otherwise noted,  $V_F = 0.9\text{ V Max.}$  @  $I_F = 10\text{ mA}$ )

Device*	Device Marking	Zener Voltage (Note 3)				Leakage Current	
		V <sub>Z</sub> (Volts)			@ I <sub>ZT</sub>	I <sub>R</sub> @ V <sub>R</sub>	
		Min	Nom	Max	μA	μA	Volts
MMSZ4678T1, G	CC	1.71	1.8	1.89	50	7.5	1
MMSZ4679T1, G	CD	1.90	2.0	2.10	50	5	1
<b>MMSZ4680T1, G</b>	<b>CE</b>	<b>2.09</b>	<b>2.2</b>	<b>2.31</b>	<b>50</b>	<b>4</b>	<b>1</b>
MMSZ4681T1, G	CF	2.28	2.4	2.52	50	2	1
MMSZ4682T1, G	CH	2.565	2.7	2.835	50	1	1
MMSZ4683T1, G	CJ	2.85	3.0	3.15	50	0.8	1
MMSZ4684T1, G	CK	3.13	3.3	3.47	50	7.5	1.5
<b>MMSZ4685T1, G</b>	<b>CM</b>	<b>3.42</b>	<b>3.6</b>	<b>3.78</b>	<b>50</b>	<b>7.5</b>	<b>2</b>
MMSZ4686T1, G	CN	3.70	3.9	4.10	50	5	2
MMSZ4687T1, G	CP	4.09	4.3	4.52	50	4	2
MMSZ4688T1, G	CT	4.47	4.7	4.94	50	10	3
MMSZ4689T1, G	CU	4.85	5.1	5.36	50	10	3
<b>MMSZ4690T1, G</b>	<b>CV</b>	<b>5.32</b>	<b>5.6</b>	<b>5.88</b>	<b>50</b>	<b>10</b>	<b>4</b>
MMSZ4691T1, G	CA	5.89	6.2	6.51	50	10	5
MMSZ4692T1, G	CX	6.46	6.8	7.14	50	10	5.1
MMSZ4693T1, G	CY	7.13	7.5	7.88	50	10	5.7
MMSZ4694T1, G	CZ	7.79	8.2	8.61	50	1	6.2
MMSZ4695T1, G	DC	8.27	8.7	9.14	50	1	6.6
MMSZ4696T1, G	DD	8.65	9.1	9.56	50	1	6.9
MMSZ4697T1, G	DE	9.50	10	10.50	50	1	7.6
MMSZ4698T1, G	DF	10.45	11	11.55	50	0.05	8.4
MMSZ4699T1, G	DH	11.40	12	12.60	50	0.05	9.1
MMSZ4700T1, G	DJ	12.35	13	13.65	50	0.05	9.8
MMSZ4701T1, G	DK	13.30	14	14.70	50	0.05	10.6
MMSZ4702T1, G	DM	14.25	15	15.75	50	0.05	11.4
MMSZ4703T1, G †	DN	15.20	16	16.80	50	0.05	12.1
MMSZ4704T1, G	DP	16.15	17	17.85	50	0.05	12.9
MMSZ4705T1, G	DT	17.10	18	18.90	50	0.05	13.6
MMSZ4706T1, G	DU	18.05	19	19.95	50	0.05	14.4
MMSZ4707T1, G	DV	19.00	20	21.00	50	0.01	15.2
MMSZ4708T1, G	DA	20.90	22	23.10	50	0.01	16.7
MMSZ4709T1, G	DX	22.80	24	25.20	50	0.01	18.2
MMSZ4710T1, G	DY	23.75	25	26.25	50	0.01	19.0
MMSZ4711T1, G †	EA	25.65	27	28.35	50	0.01	20.4
MMSZ4712T1	EC	26.60	28	29.40	50	0.01	21.2
MMSZ4713T1, G	ED	28.50	30	31.50	50	0.01	22.8
MMSZ4714T1, G	EE	31.35	33	34.65	50	0.01	25.0
MMSZ4715T1, G	EF	34.20	36	37.80	50	0.01	27.3
MMSZ4716T1, G	EH	37.05	39	40.95	50	0.01	29.6
MMSZ4717T1, G	EJ	40.85	43	45.15	50	0.01	32.6

3. Nominal Zener voltage is measured with the device junction in thermal equilibrium at  $T_L = 30^\circ\text{C} \pm 1^\circ\text{C}$ .

\*The "G" suffix indicates Pb-Free package available.

†MMSZ4703 and MMSZ4711 Not Available in 10,000/Tape & Reel

# MMSZ4678T1 Series

## PACKAGE DIMENSIONS

SOD-123  
CASE 425-04  
ISSUE E

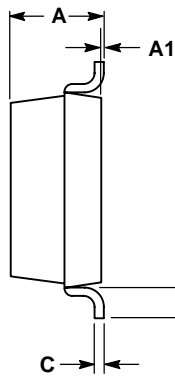
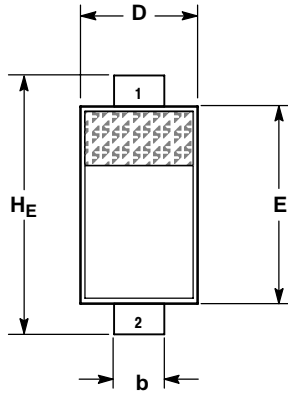

- NOTES:  
1. DIMENSIONING AND TOLERANCING PER ANSI Y14.5M, 1982.  
2. CONTROLLING DIMENSION: INCH.

DIM	MILLIMETERS			INCHES		
	MIN	NOM	MAX	MIN	NOM	MAX
A	0.94	1.17	1.35	0.037	0.046	0.053
A1	0.00	0.05	0.10	0.000	0.002	0.004
b	0.51	0.61	0.71	0.020	0.024	0.028
c	---	---	0.15	---	---	0.006
D	1.40	1.60	1.80	0.055	0.063	0.071
E	2.54	2.69	2.84	0.100	0.106	0.112
HE	3.56	3.68	3.86	0.140	0.145	0.152
L	0.25	---	---	0.010	---	---

STYLE 1:  
PIN 1. CATHODE  
2. ANODE

## SOLDERING FOOTPRINT\*

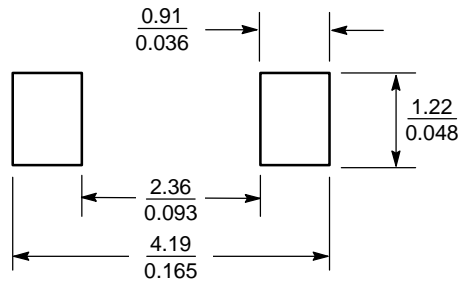

SCALE 10:1  $\left(\frac{\text{mm}}{\text{inches}}\right)$

\*For additional information on our Pb-Free strategy and soldering details, please download the ON Semiconductor Soldering and Mounting Techniques Reference Manual, SOLDERRM/D.