



PRODUCTS

RESOURCES

COMPANY

PART NUMBER SEARCH



« Clamping Knobs

Four Arm Clamping Knobs Series #2837

Clamping knobs are available in different materials, thermoplastic, and phenolic for a multiple of applications.

A variety of shapes and diameters with plain, tapped bosses or with studs are available with standard threads to fit the application.

Perfect for the industrial machinery, medical, general equipment and other industrial applications.

Knobs can be decorated or customized to your specific need.

Davies Molding is pleased to introduce our series of soft touch knobs and handles. Our soft touch parts are molded with a soft thermoplastic overmolded "rubber" top with a tough thermoplastic body underneath. The soft feel of the knob provides a comfortable touch with a sure grip.

Colors available upon request.

Please note: Not all variations available are listed below. Please [contact Customer Service](#) to inquire about all available options.

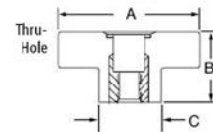
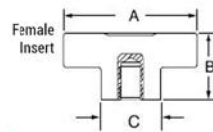
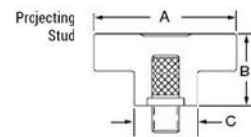

[REQUEST CAD DRAWING](#)

[REQUEST A QUOTE](#)

Item #	Diameter A	Height B	Hub C	Material Type	Mounting Diameter	Mounting Type	Thread Length/Depth	Color
2837	2.25	1.00	1.00	Thermoplastic	1/4-20	Female Insert	0.50	BLACK
2837-A	2.25	1.00	1.00	Thermoplastic	5/16-18	Female Insert	0.50	BLACK
2837-B	2.25	1.00	1.00	Thermoplastic	3/8-16	Female Insert	0.50	BLACK
2837-C	2.25	1.00	1.00	Thermoplastic	1/4-20	Projecting Stud	0.50	BLACK
2837-D	2.25	1.00	1.00	Thermoplastic	5/16-18	Projecting Stud	0.50	BLACK
2837-E	2.25	1.00	1.00	Thermoplastic	3/8-16	Projecting Stud	0.50	BLACK
2837-F	2.25	1.00	1.00	Thermoplastic	1/4-20	Thru-Hole		BLACK
2837-G	2.25	1.00	1.00	Thermoplastic	5/16-18	Thru-Hole		BLACK
2837-H	2.25	1.00	1.00	Thermoplastic	3/8-16	Thru-Hole		BLACK
2837-J	2.25	1.00	1.00	Thermoplastic	3/8-16	Projecting Stud	1.50	BLACK
2837-K	2.25	1.00	1.00	Thermoplastic	3/8-16	Projecting Stud	1.25	BLACK
2837-V	2.25	1.00	1.00	Thermoplastic	5/16-18	Projecting Stud	1.00	BLACK
2837-W	2.25	1.00	1.00	Thermoplastic	3/8-16	Projecting Stud	1.00	BLACK
2837-X	2.25	1.00	1.00	Thermoplastic	3/8-16	Projecting Stud	3.00	BLACK
2837-Y	2.25	1.00	1.00	Thermoplastic	5/16-18	Projecting Stud	2	BLACK

2837-Z	2.25	1.00	1.00	Thermoplastic	5/16-18	Projecting Stud	1.625	BLACK
2837AC	2.25	1.00	1.00	Thermoplastic	3/8-16	Projecting Stud	2	BLACK
2837AF	2.25	1.00	1.00	Thermoplastic	1/2-13	Thru-Hole		BLACK
2837AH	2.25	1.00	1.00	Thermoplastic	5/16-18	Projecting Stud	1.50	BLACK
2837AK	2.25	1.00	1.00	Thermoplastic	5/16-18	Projecting Stud	0.50	BLACK
2837AQ	2.25	1.00	1.00	Thermoplastic	3/8-16	Female Insert	0.50	RED
2837AR	2.25	1.125	1.00	Thermoplastic	3/8-16	Projecting Stud	1.00	BLACK

PRODUCTS

- Knobs
- Handles
- Leveling Feet
- Latches
- Hinges
- Indexing Plungers
- Electronic Enclosures
- Two-Shot / Soft Touch
- Frac Balls
- Custom Molding

RESOURCES

- Engineering Specifications
- Distributor Listing
- Sales Representative Listing

COMPANY

- About Us
- Capabilities
- Certifications
- Contact Us
- Blog
- Careers

QUESTIONS ?

Copyright © 2016 Davies Molding, LLC. All Rights Reserved.
 350 Kehoe Blvd. | Carol Stream, IL 60188-1818 | Phone: (800) 554-9208 | Fax: (630) 510-9944