



PRODUCTS

RESOURCES

COMPANY

PART NUMBER SEARCH



« Clamping Knobs

Four Arm Clamping Knobs Series #2830

Clamping knobs are available in different materials, thermoplastic, and phenolic for a multiple of applications.

A variety of shapes and diameters with plain, tapped bosses or with studs are available with standard threads to fit the application.

Perfect for the industrial machinery, medical, general equipment and other industrial applications.

Knobs can be decorated or customized to your specific need.

Davies Molding is pleased to introduce our series of soft touch knobs and handles. Our soft touch parts are molded with a soft thermoplastic overmolded "rubber" top with a tough thermoplastic body underneath. The soft feel of the knob provides a comfortable touch with a sure grip.

Colors available upon request.

Please note: Not all variations available are listed below. Please [contact Customer Service](#) to inquire about all available options.

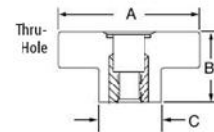
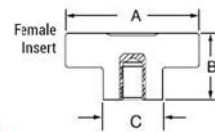
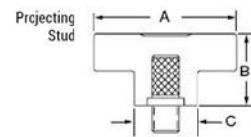

[REQUEST CAD DRAWING](#)

[REQUEST A QUOTE](#)

Item #	Diameter A	Height B	Hub C	Material Type	Mounting Diameter	Mounting Type	Thread Length/Depth	Color
2830	2	1.00	0.875	Thermoset	1/4-20	Female Insert	0.375	BLACK
2830-A	2	1.00	0.875	Thermoset	5/16-18	Female Insert	0.50	BLACK
2830-B	2	1.00	0.875	Thermoset	3/8-16	Female Insert	0.50	BLACK
2830-C	2	1.00	0.875	Thermoset	1/4-20	Projecting Stud	0.56	BLACK
2830-D	2	1.00	0.875	Thermoset	5/16-18	Projecting Stud	0.50	BLACK
2830-E	2	1.00	0.875	Thermoset	3/8-16	Projecting Stud	1.00	BLACK
2830-F	2	1.00	0.875	Thermoset	3/8-16	Projecting Stud	1.375	BLACK
2830-J	2	1.00	0.875	Thermoset	5/16-18	Projecting Stud	1.00	BLACK
2830-K	2	1.00	0.875	Thermoset	1/4-20	Projecting Stud	1.50	BLACK
2830-M	2	1.00	0.875	Thermoset	3/8-16	Projecting Stud	1.00	BLACK
2830-N	2	1.00	0.875	Thermoset	5/16-18	Projecting Stud	0.75	BLACK
2830-Q	2	1.00	0.875	Thermoset	1/4-20	Projecting Stud	1.00	BLACK
2830-R	2	1.00	0.875	Thermoset	5/16-18	Projecting Stud	1.25	BLACK
2830-T	2	1.00	0.875	Thermoset	3/8-16	Projecting Stud	1.50	BLACK
2830-U	2	1.00	0.875	Thermoset	3/8-16	Projecting Stud	2	BLACK

2830-V	2	1.00	0.875	Thermoset	3/8-24	Female Insert	0.625	BLACK
2830-Z	2	1.00	0.875	Thermoset	5/16-18	Projecting Stud	1.75	BLACK
2830AA	2	1.00	0.875	Thermoset	3/8-16	Projecting Stud	0.50	BLACK
2830AC	2	1.00	0.875	Thermoset	3/8-16	Projecting Stud	1.25	BLACK
2830AF	2	1.00	0.875	Thermoset	M10	Female Insert	0.59	BLACK
2830AG	2	1.00	0.875	Thermoset	3/8-16	Projecting Stud	2.50	BLACK
2830AH	2	1.00	0.875	Thermoset	5/16-18	Projecting Stud	1.00	BLACK
2830AJ	2	1.00	0.875	Thermoset	5/16-18	Projecting Stud	0.81	BLACK
2830AK	2	1.00	0.875	Thermoset	3/8-16	Projecting Stud	0.75	BLACK
2830AP	2	1.00	0.875	Thermoset	1/4-20	Projecting Stud	0.50	BLACK
2830AU	2	1.00	0.875	Thermoset	5/16-18	Projecting Stud	1.50	BLACK
2830AW	2	1.00	0.875	Thermoset	1/4-20	Projecting Stud	1.25	BLACK
2830BA	2	1.00	0.875	Thermoset	3/8-24	Projecting Stud	0.75	BLACK
2830BB	2	1.00	0.875	Thermoset	3/8-16	Projecting Stud	3.00	BLACK
2830BF	2	1.00	0.875	Thermoset	1/4-20	Projecting Stud	1.375	GRAY
2830BG	2	1.15	0.875	Thermoset	1/2-13	Female Insert	0.625	BLACK
2830BH	2	1.15	0.875	Thermoset	1/2-20	Female Insert	0.625	BLACK
2830BJ	2	1.00	0.875	Thermoset	3/8-16	Thru-Hole		BLACK
2830BK	2	1.00	0.875	Thermoset	3/8-24	Thru-Hole		BLACK
2830BL	2	1.15	0.875	Thermoset	1/2-13	Thru-Hole		BLACK
2830BM	2	1.125	0.875	Thermoset	1/2-20	Thru-Hole		BLACK
2830BZ	2	1.00	0.875	Thermoset	1/4-20	Projecting Stud	1.50	RED
2830CA	2	1.00	0.875	Thermoset	5/16-18	Thru-Hole		BLACK
2830CB	2	1.00	0.875	Thermoset	3/8-16	Projecting Stud	0.75	BLACK
2830CE	2	1.00	0.875	Thermoset	3/8-16	Projecting Stud	0.64	BLACK
2830CG	2	1.00	0.875	Thermoset	1/2-13	Projecting Stud	0.75	BLACK
2830CH	2	1.00	0.875	Thermoset	5/16-18	Projecting Stud	0.875	BLACK
2830CU	2	1.00	0.875	Thermoset	1/2-13	Projecting Stud	1.00	BLACK
2830DE	2	1.00	0.875	Thermoset	3/8-16	Projecting Stud	1.75	BLACK

PRODUCTS

- Knobs
- Handles
- Leveling Feet
- Latches
- Hinges
- Indexing Plungers
- Electronic Enclosures
- Two-Shot / Soft Touch
- Frac Balls
- Custom Molding

RESOURCES

- Engineering Specifications
- Distributor Listing
- Sales Representative Listing

COMPANY

- About Us
- Capabilities
- Certifications
- Contact Us
- Blog
- Careers

QUESTIONS ?

your name

your e-mail

[select your industry]

questions / comments

Copyright © 2016 Davies Molding, LLC. All Rights Reserved.
 350 Kehoe Blvd. | Carol Stream, IL 60188-1818 | Phone: (800) 554-9208 | Fax: (630) 510-9944