

AMPAMP INCORPORATED
Harrisburg, Pa. 17105**AMP ★ INSERTION/EXTRACTION
TOOLS 91066**

Instruction Sheet

IS 7491

RELEASED

9 • 10 • 85

REDUCED FOR PACKAGING

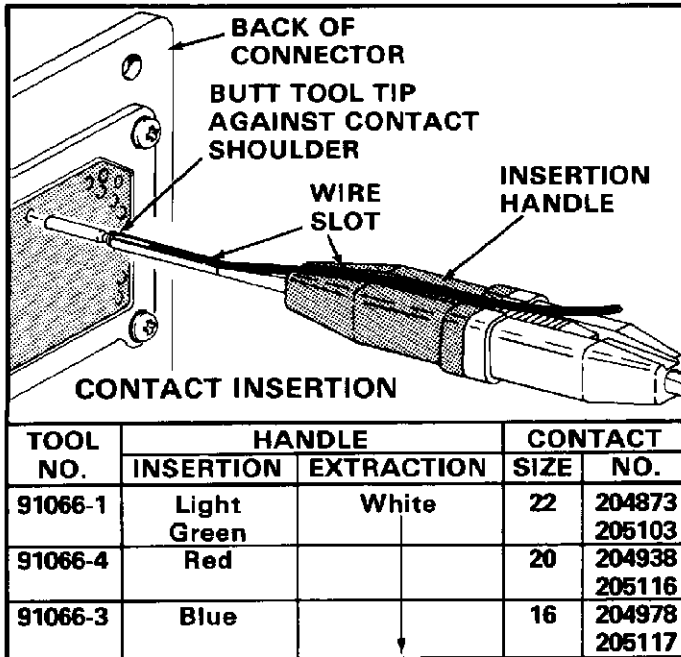

Fig. 1

1. INTRODUCTION

The AMP Insertion/Extraction Tools listed in Figure 1 are designed for contacts that are used in AMP RM and RME ARINC Connectors. Read these instructions thoroughly before starting.

NOTE

All dimensions presented on this instruction sheet are in inches, unless otherwise stated.

2. DESCRIPTION

Each tool handle has two color-coded halves. The white half contains the extraction tip and the other half contains the insertion tip. The color of the insertion tip half indicates the applicable contact size. See chart in Figure 1.

The tool number and contact size are stamped opposite the wire slot on the white half of the tool handle. The AMP marking is molded opposite the wire slot on the insertion tip half of the tool handle. See Figure 3.

3. INSERTION/EXTRACTION PROCEDURES**CAUTION**

Too much force on the tool during insertion and extraction procedures could cause damage to the contact.

A. Insertion

1. Place the wire over the wire slot of the insertion tip and hold it in this position with your thumb.

2. While applying light pressure on the wire, slide your thumb over the wire and toward the tip of the tool. The tool tip will spread, allowing the wire to enter the tip.
3. Slide the tool tip over the wire barrel of the contact until it butts against the shoulder of the contact as shown in Figure 1.

WARNING

It is important that you hold the tool handle between the thumb and finger tips to prevent possibility of injury. Do NOT hold tool with unused tip (end) toward or against palm of your hand.

4. Align the contact with the cavity and push contact straight into the connector until it bottoms.
5. Remove the tool, and then pull back lightly on the wire to make certain the contact is locked in the cavity.

B. Extraction

1. Place the wire over the wire slot of the extraction tip and hold it in this position with your thumb.
2. While applying light pressure on the wire, slide your thumb over the wire and toward the tip of the tool. The tool tip will spread, allowing the wire to enter the tip as shown in Figure 2.

WARNING

It is important that you hold the tool handle

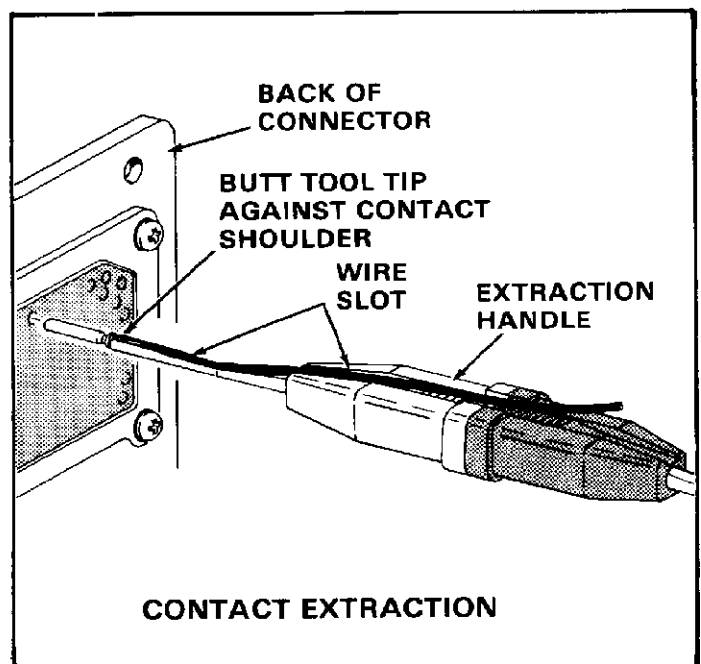

Fig. 2

Copyright 1977, 1979, 1985 by AMP Incorporated, Harrisburg, PA. All International Rights Reserved. AMP Incorporated products covered by U.S. and Foreign patents and/or patents pending.

between the thumb and finger tips to prevent possibility of injury. Do NOT hold tool with unused tip (end) toward or against palm of your hand.

3. Insert the tool tip straight into the cavity until it bottoms.
4. Hold the wire securely against the tool handle serrations, and pull back lightly to extract the contact. If the contact does not come out easily, reseat the tool tip in the cavity (Step 3) and repeat Step 4.

4. TOOL CERTIFICATION

The information in Figure 3 has been included to

AMP INSERTION/EXTRACTION TOOLS 91066

certify the tools listed in Column 1. We recommend that you inspect the tool immediately upon its arrival in your factory, and at regularly scheduled inspections to assure that the tool has not been damaged.

The dimensions shown in Figure 3 include the maximum tolerances.

Additional tools can be purchased from:

AMP Incorporated
 P.O. Box 3608
 Harrisburg, Pennsylvania 17105-3608

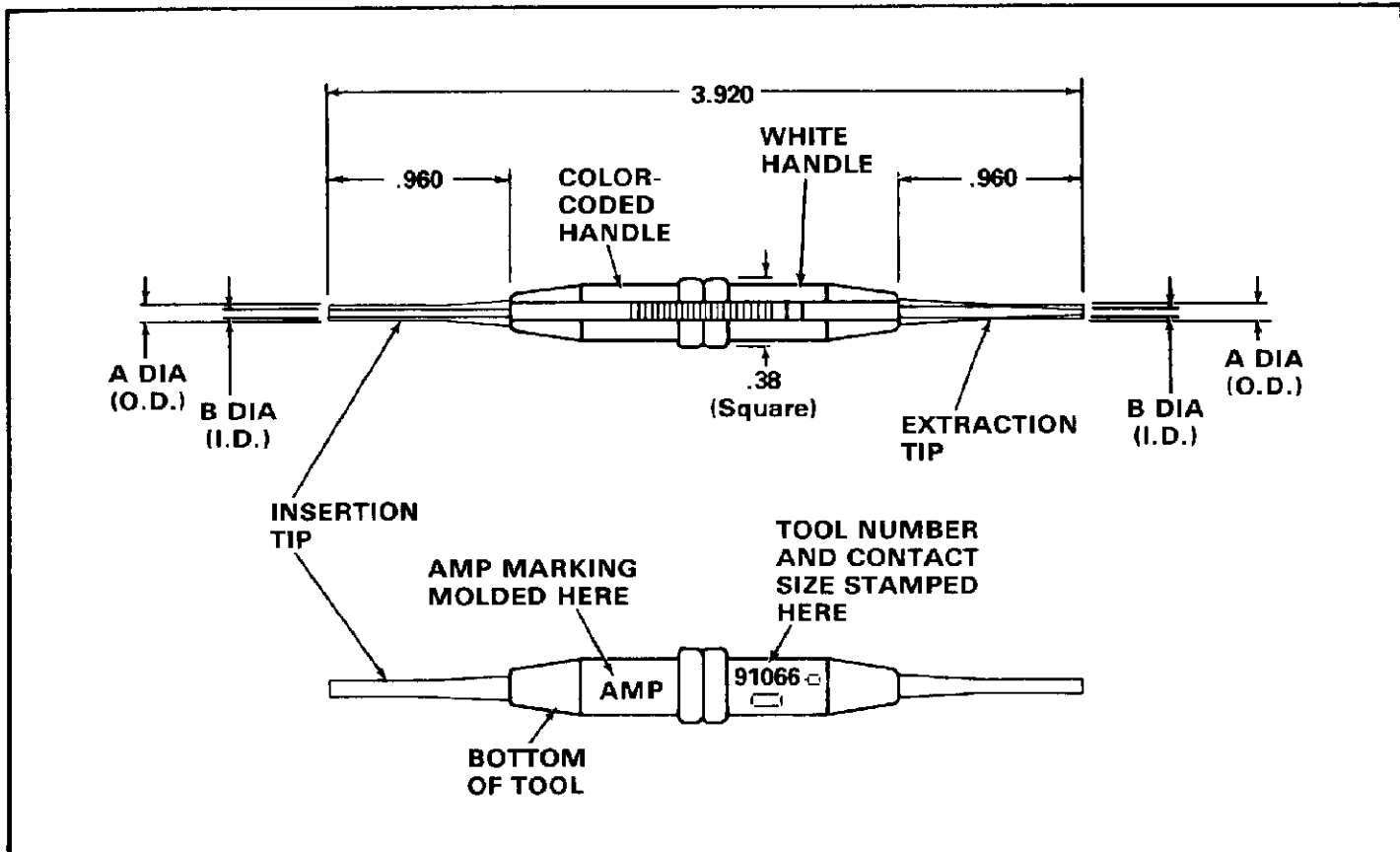

TOOL NUMBER	DIM.		COLOR-CODED HANDLE (Insertion End)	CONTACT SIZE	TOOL MATERIALS	ENGINEERING APPROVAL	DATE APPROVED
	A	B					
91066-1	.065	.054	Light Green	22	Plastic and Steel (Nickel Plated)	Ben Luci	9 · 10 · 85
91066-4	.085	.073	Red	20			
91066-3	.134	.114	Blue	16			

Fig. 3

THIS DRAWING IS UNPUBLISHED. RELEASED FOR PUBLICATION N/A ,N/A .
 © COPYRIGHT N/A By - ALL RIGHTS RESERVED.

LOC	DIST	REVISIONS					
DF	A0	P	LTR	DESCRIPTION	DATE	DWN	APVD
				D1 REVISED PER ECO-11-005030	11MAR11	RK	HMR

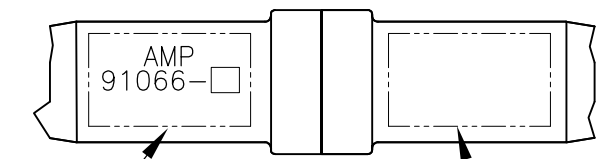
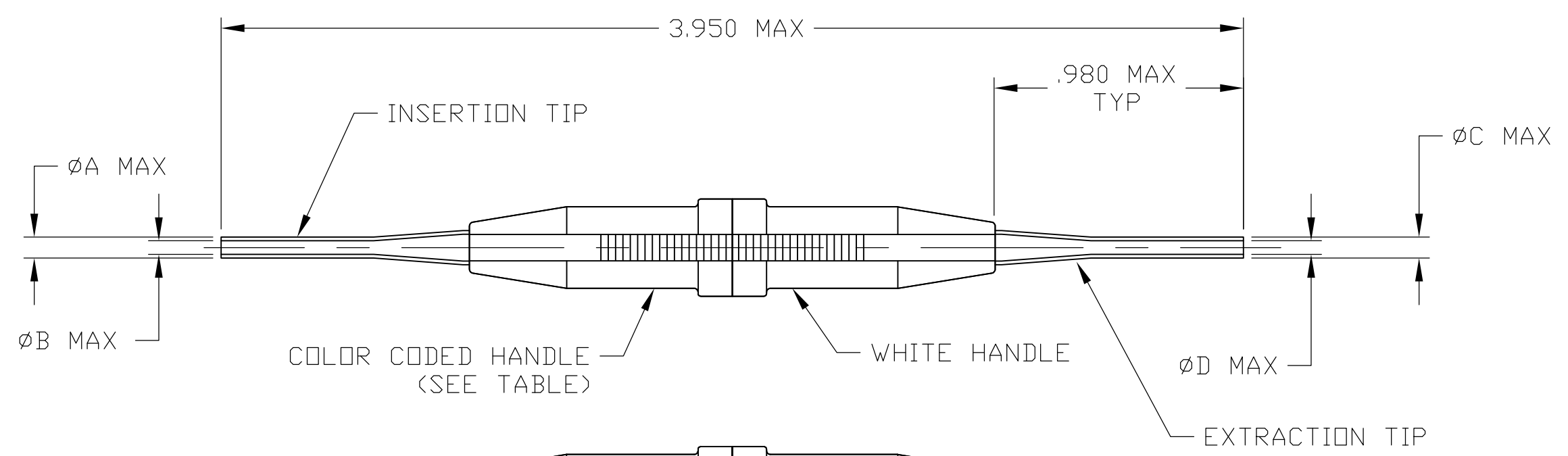

MARKING IN APPROX. AREA AS SHOWN REF

M81969-SQ BLOCK SYMBOL

1. FOR CORRECT TOOL USAGE SEE INSTRUCTION SHEET: I. S. 408-7491.

-	.072	.087	.073	.085	RED	20	91066-4
M81969/1-03	.116	.136	.114	.134	BLUE	16	91066-3
M81969/1-01	.055	.074	.056	.065	LT. GREEN	22	91066-1
MILITARY PART NO. REF	DIM D	DIM C	DIM B	DIM A	COLOR CODE	SIZE	PART NUMBER

THIS DRAWING IS A CONTROLLED DOCUMENT.

DIMENSIONS: INCHES

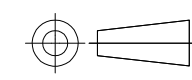

TOLERANCES UNLESS OTHERWISE SPECIFIED:

0 PLC	± -
1 PLC	± -
2 PLC	± -
3 PLC	± -
4 PLC	± -
ANGLES	± -

MATERIAL: PLASTIC & STEEL

FINISH: NICKEL PLATED

DWN	C.C.THOMAS	4-30-03
CHK	S.GLATFELTER	4-30-03
APVD	S.GLATFELTER	4-30-03
PRODUCT SPEC	-	-
APPLICATION SPEC	-	-
WEIGHT	-	-



NAME: -			
INSERTION/EXTRACTION TOOL			
SIZE	CAGE CODE	DRAWING NO	RESTRICTED TO
A3	00779	C-91066	-

CUSTOMER DRAWING SCALE 2:1 SHEET 1 OF 1 REV D1