



- Home Page
- Linear Potentiometers
- Membrane Potentiometers
- Single-Turn Potentiometers
- Multi-Turn Potentiometers
- Turn-Counting Dials
- Industrial Joystick Controls
- Industrial Foot Controllers
- Valve Actuators
- ROHS/WEEE
- Cross Reference
- ETI Systems Sales Reps
- ETI Systems Distributors

J9 Contactless Inductive Joystick

Light Industrial Joystick Series



Panel Cutout

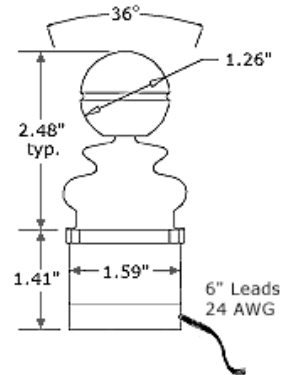
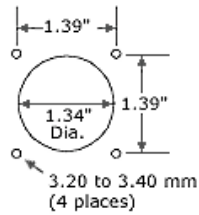

[Click here](#) for larger picture

J9-00106 Standard Features:

- Two axis joystick
- 2.48" handle height
- 36° deflection angle ($\pm 18^\circ$)
- Spring return to center
- Ball knob
- Single decode inductive circuitry
- 100% ($\pm 50\%$) gain
- Circular deflection pattern
- Mounting bezel with hardware
- Large ribbed protective rubber boot (IP65 rating above panel)

ELECTRICAL CHARACTERISTICS.

- INDUCTIVE JOYSTICK
- SUPPLY VOLTAGE _____ 4.75V - 15V
- SIGNAL SWING(FROM CENTER) _____ ±50% VS
- OUTPUT SIGNAL TOLERANCE _____ ±10% OF OUTPUT
- OUTPUT IMPEDANCE _____ 1.8KOHMS±1%
- SIGNAL RIPPLE _____ <1% OF OUTPUT
- SUPPLY CURRENT _____ TYPICALLY 10mA
- OPERATING TEMPERATURE _____ -20°C - +55°C
- ESD IMMUNITY _____ >12 KV
- RFI IMMUNITY _____ 20V/m
- RFI IMMUNITY (TYPICAL) _____ >40 V/m (INSTALLED)
- PREFERRED LOAD (TYPICAL) _____ >10K

MECHANICAL CHARACTERISTICS.

- BODY _____ GLASS RE-ENFORCED ABS
- SHAFT MATERIAL _____ A303 STAINLESS STEEL
- SHAFT DIAMETER _____ .200 TYPICAL
- WASHER PLATE _____ BRASS OR ACETAL
- GIMBAL PIVOT _____ ACETAL
- CENTERING CONE _____ BRASS OR ACETAL
- SPRING _____ STAINLESS STEEL
- PIVOT PINS _____ HARDENED STEEL
- LIMITER PLATE _____ GLASS RE-ENFORCED NYLON
- BEZELS _____ GLASS RE-ENFORCED NYLON
- KNOB _____ DURAPLAST
- LEVER DEFLECTION _____ ±18°
- ENVIRONMENTAL _____ IP 65 ABOVE PANEL
- WEIGHT _____ 70g TYPICAL
- SERVICE LIFE _____ 15 MILLION CYCLES TYPICAL
- BOOT _____ VINYL (GREEN)

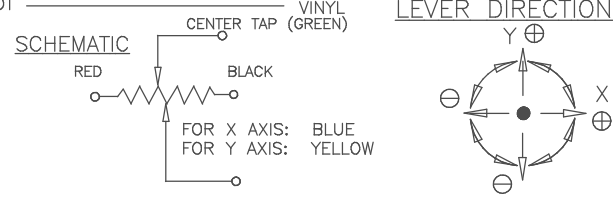

P/N J9-00106

Panel mount Detail

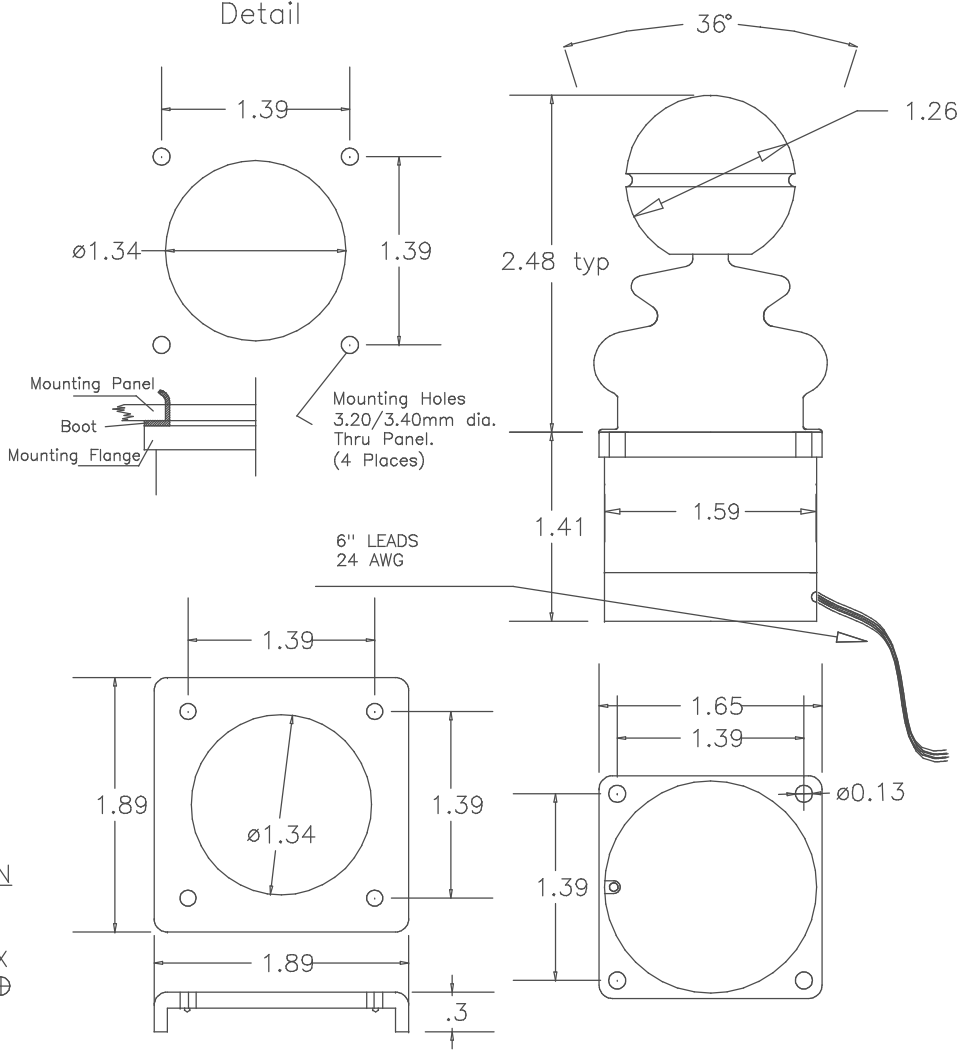

TOLERANCES
 XX = +/- .010" FRACT. = +/- 1/64"
 XXX = +/- .005" ANGLES = +/- 1/2"
 ALL SPECIFICATIONS SUBJECT TO CHANGE WITHOUT NOTICE.

SCALE NONE	DATE:	6-02-03
	BY:	AT
	APPR'D:	
CODE IDENT:	19477	



TITLE
 INDUCTIVE JOYSTICK

PART NO.
 J9-00106