

- Non-constant impedance.
- Ideally suited for pulse applications.
- Durable Brass bodies with Nickel plating.
- Feature polyethylene high density insulators.
- Operating voltage rating of 10 KV DC.

SPECIFICATIONS

MATERIAL

Body:	Brass
Crimp Sleeves:	Commercial Bronze Alloy
Male Center Contacts:	Brass
Female Center Contacts:	Beryllium Copper
Outer Contacts:	Beryllium Copper
Insulators:	Polyethylene
Gaskets & Seals:	Silicone Rubber

FINISHES

Body:	Nickel
Center Contacts:	Gold

MECHANICAL

Mating:	2 Stud Bayonet Coupling
---------	-------------------------

ELECTRICAL

Impedance:	Non-Constant
Voltage Rating:	Operating: 10 KV DC Test: 15 KV DC
Insulation Resistance:	10 ⁶ Megaohms

ENVIRONMENTAL

Temperature Range:	Polyethylene Insulators -55° C to +85° C PTFE Insulators -65° C to +165° C
Vibration:	MIL-STD-202, Method 204, Condition A
Shock:	MIL-STD-202, Method 213, Condition I
Corrosion:	MIL-STD-202, Method 101, Condition B

INTERFACE DIMENSIONS

PLUG

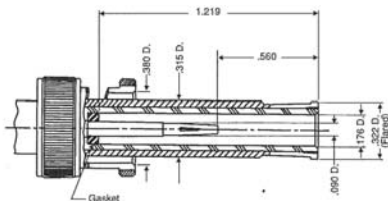

JACK

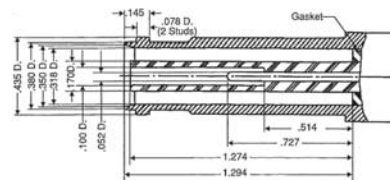

PLUG - K-GRIP, JR.

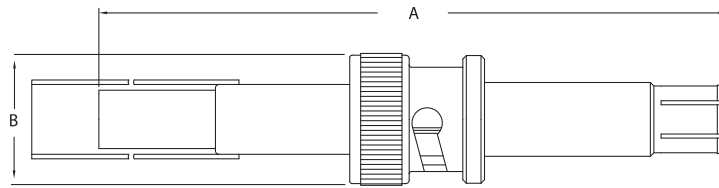

FIGURE 1

BULKHEAD RECEPTACLE

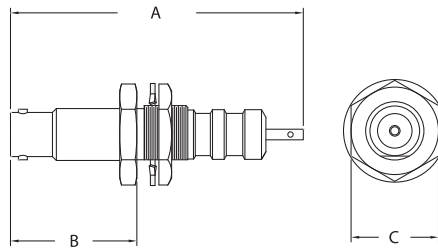

FIGURE 2

ADAPTER - WITHIN SERIES

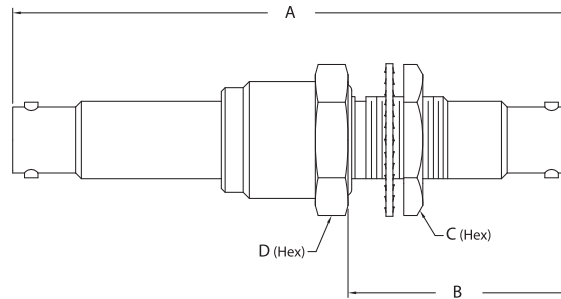
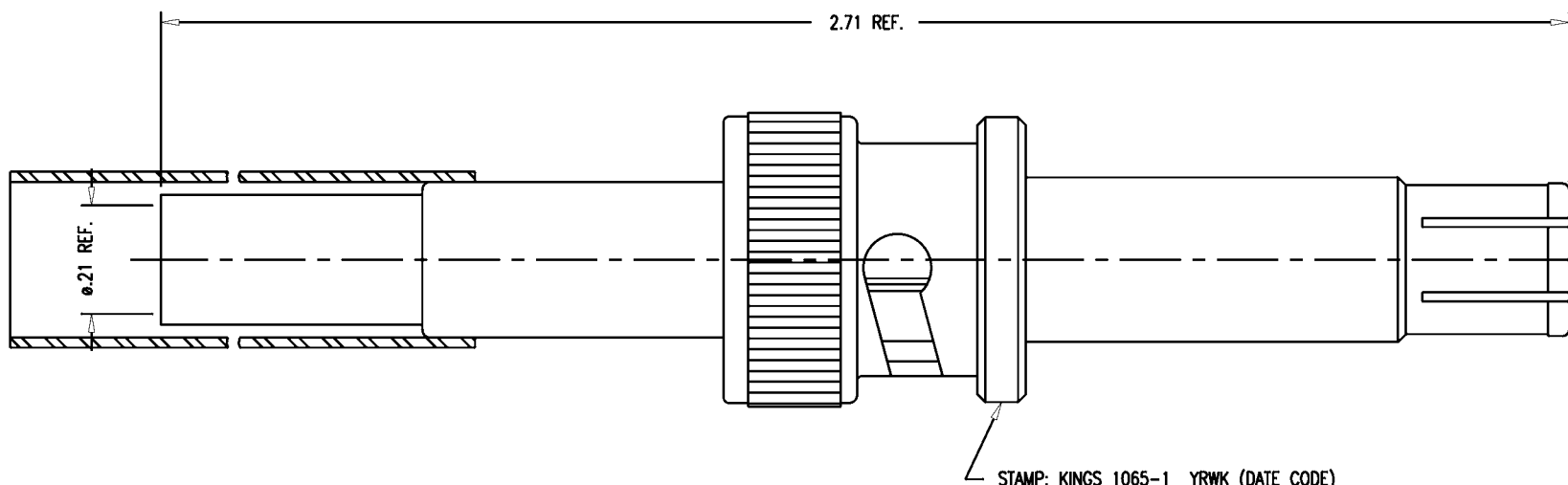

FIGURE 3

Item Number	Military PN	Product Description	Gender	Finish	A	Dimensions B	C	D	Cable Group	Cable Procedure	Crimp Die	Mounting Hole	Figure #
1065-1 QD		Plug, Crimp	M	Nickel	2.710	0.560			D	3-7-1	KTH-2001		1
1065-2		Plug, Crimp	M	Nickel	2.710	0.560			40	CP-419	KTH-2001		1
1064-1 QD		Receptacle, Bulkhd, Front Mt	F	Nickel	2.500	1.080	0.750	0.750		SOLDER		X	2
1069-1		Within Series Adapter, Bulkhd	F-F	Nickel	3.180	1.270	0.750	0.750				X	3

DASH NO.	M CODE	MADE FROM
----------	--------	-----------

GSD



NOTES:

1. FOR USE WITH RG-58, 58A & 58C/U CABLE.
2. FOR CABLING INSTRUCTIONS SEE 3-7-1.
4. FOR CRIMPING USE DIE KTH-2001.
5. MATERIALS:
INSULATOR: HIGH DENSITY POLYETHYLENE, MIL-P-22748
GASKET: SILICONE RUBBER, ZZ-R-765
HEAT SHRINK TUBING: POLYOLEFIN, PER MIL-I-23053/5 COLOR: RED
K-GRIP SLEEVE: COM. BRONZE, ASTM-B-135
K-GRIP BODY: BRASS, ASTM-B16
WASHERS: BRASS, QQ-B-613
ALL OTHER METAL PARTS: BER. COPPER, ASTM-B-196
6. FINISHES:
CENTER CONTACT: HARD GOLD PLATE, PER MIL-G-45204
SPRING WASHER: SILVER PLATE, PER QQ-S-365
ALL OTHER METAL PARTS: KINGS TARNISH RESISTANT NICKEL FINISH (TR-5)
7. ELECTRICAL CHARACTERISTICS:
WORKING VOLTAGE: 10 KV DC

GSD

1065-1

REVISIONS	
ISSUE	CHANGES
13	CN 33334 E REDRAWN WJM 08/26/91
14	CN 37544 C KH 02/20/98
15	CN 38562 E TML 05/28/02
1065-1S	
SCALE 4:1	
APPROX SURFACE AREA	
USED ON	
REF:	
PLUG, 10 KV	
DRAWN WJM	DATE 08/26/91
DESIGN MJB	DATE 09/04/91
APPR.	DATE
KINGS ELECTRONICS CO., INC. ROCK HILL, SOUTH CAROLINA 29730	
1065-1	