



NEUTRIK

NL4MD-V-1



4 pole chassis connector, grey D-size flange, self tapping screw holes (A-screw), vertical PCB mount

The state-of-the-art chassis connector for loudspeaker / amplifier applications. They feature a unique locking system, robust plastic housing and high current silver plated contacts.

Features & Benefits

- Standard current rating 30 Amp
- Glass reinforced materials make it extremely robust and dependable
- Precise keyway for secure mating
- Accurate twist lock latching system
- Metal insert in locking area
- Airtight design - optimized for speaker applications

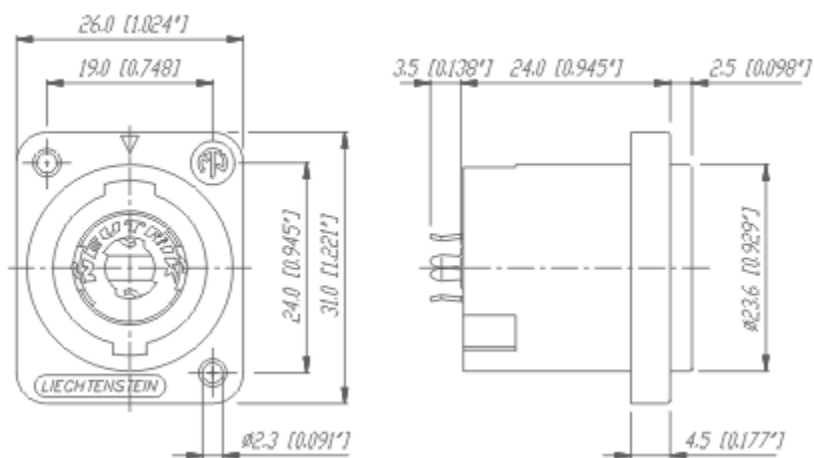

Product

Connector Type

Gender

Speakon

male

Electrical

Contact resistance

$\leq 3 \text{ m}\Omega$ (after lifetime)

Dielectric strength	4 kVdc (peak)
Insulation resistance	> 1 G Ω (after dampheat)
Rated current per contact	30 A rms continuous
Rated current per contact	40 A audiosignal, duty cycle 50 %
Rated voltage	250 V (Insulation)
Attention	speakON is NOT to be used as an AC mains connector!
Mechanical	
Lifetime	> 5000 mating cycles
Wiring	Vertical PCB mount
Locking device	Quick Lock
Mounting direction	rear
Chassis shape	D
Layout	standard hole position, self tapping screw holes (A-Screw)
Material	
Contact plating	4 μ m Ag
Contacts	Bronze (CuSn6)
Shell	Polyamide (PA 6 30 % GR) grey
Environmental	
Approvals	UL,CSA
Flammability	UL 94 HB
Solderability	Complies with IEC 68-2-20
Temperature range	-30 °C to +80 °C