

211769-1 Product Details



211769-1

TE Internal Number: 211769-1



CPC (Circular Plastic) and Circular Metal-Shell Connectors



Product Highlights:

- Housing
- Connector Style = Receptacle
- 9 Positions
- 9 Signal Positions
- 0 Power Positions

Documentation & Additional Information	
Product Drawings: <ul style="list-style-type: none"> • RECEPTACLE HOUSING, REVERSE SEX, SHELL SIZE 17, CPC (PDF, English) Catalog Pages/Data Sheets: <ul style="list-style-type: none"> • AMP Circular Connectors for Commercial Signal & Powe... (PDF, English) Product Specifications: <ul style="list-style-type: none"> • None Available Application Specifications: <ul style="list-style-type: none"> • Circular Plastic Connectors (CPC) (PDF, English) Instruction Sheets: <ul style="list-style-type: none"> • None Available CAD Files: (CAD Format & Compression Information) <ul style="list-style-type: none"> • 2D Drawing (DXF, Version AD) • 3D Model (IGES, Version AD) • 3D Model (STEP, Version AD) 	Additional Product Images: <ul style="list-style-type: none"> • Contact Arrangement • Keying Options Related Products: <ul style="list-style-type: none"> • Tooling • Mating Products (1)

Product Features (Please use the Product Drawing for all design activity)	
Product Type Features: <ul style="list-style-type: none"> • Connector Type = Housing • Mount Angle = Straight • Shell Size = 17 • PCB Mount Retention = Without • Shell Type = All Plastic • Product Series = Series 1 • Thread Size = 15/16-20 UNEF-2A • Sealed = No Mechanical Attachment: <ul style="list-style-type: none"> • Mount = Panel • Mating Retention Type = Threaded Coupling Body Features: <ul style="list-style-type: none"> • Mount Style = Flange with Mounting Holes Contact Features: <ul style="list-style-type: none"> • Contact Type = Socket • Reverse Gender = Reverse Housing Features: <ul style="list-style-type: none"> • Connector Style = Receptacle • Mating Alignment Type = Keyed • Housing Material = Thermoplastic - GF • Housing Color = Black • UL Flammability Rating = UL 94V-0 	Configuration Features: <ul style="list-style-type: none"> • Number of Positions = 9 • Number of Signal Positions = 9 • Number of Power Positions = 0 • Environmental Protection = Without • Reverse Numbering = Without Industry Standards: <ul style="list-style-type: none"> • VDE Tested = Yes • RoHS/ELV Compliance = RoHS compliant, ELV compliant • Lead Free Solder Processes = Not relevant for lead free process • RoHS/ELV Compliance History = Always was RoHS compliant Identification Marking: <ul style="list-style-type: none"> • Keying = A Environmental: <ul style="list-style-type: none"> • Fluid Resistance = None Conditions for Usage: <ul style="list-style-type: none"> • Accepts Wire Insulation Diameter, Range (mm [in]) = 3.81 [0.150] Other: <ul style="list-style-type: none"> • Brand = AMP

D

C

B

A

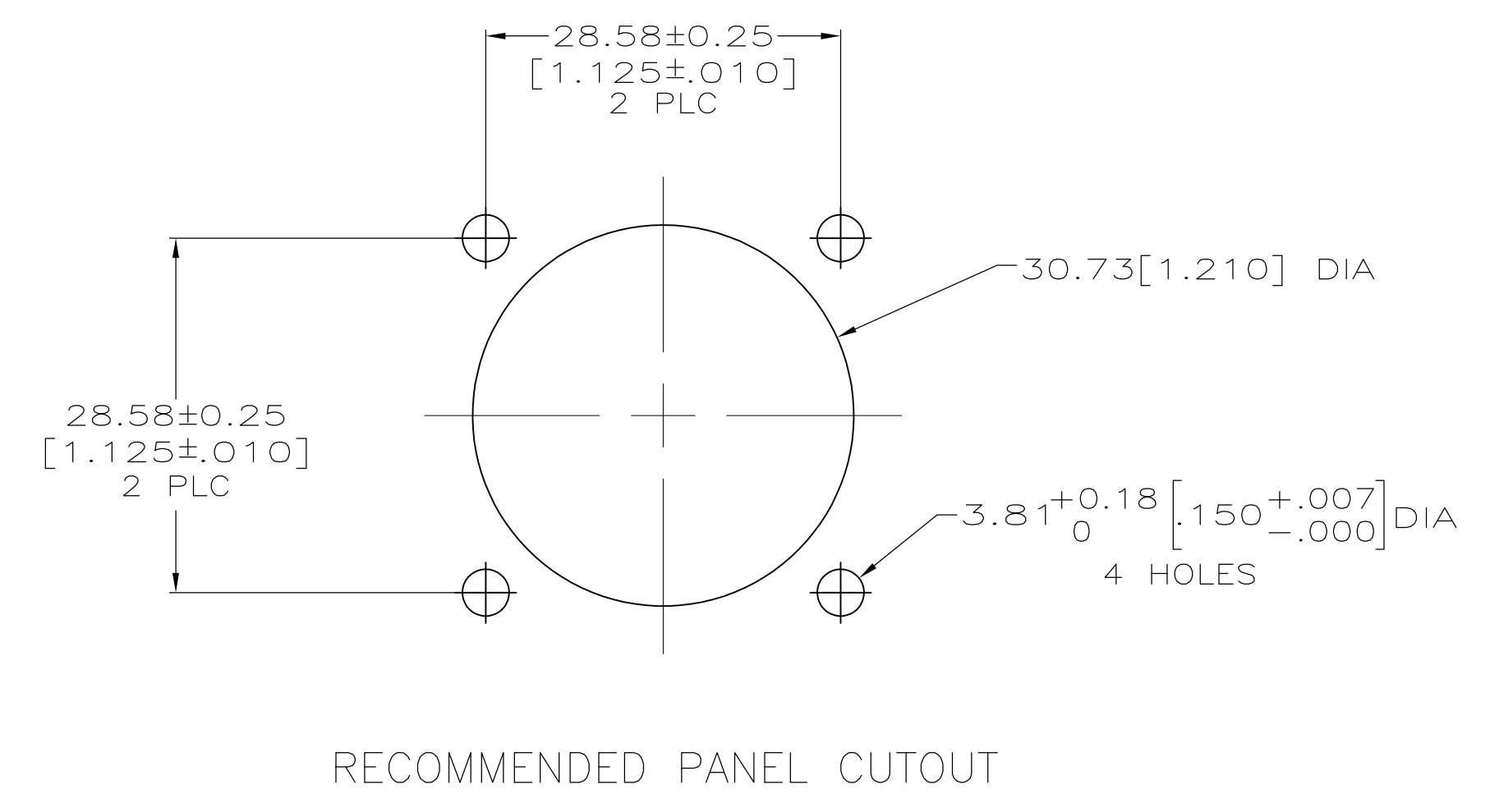
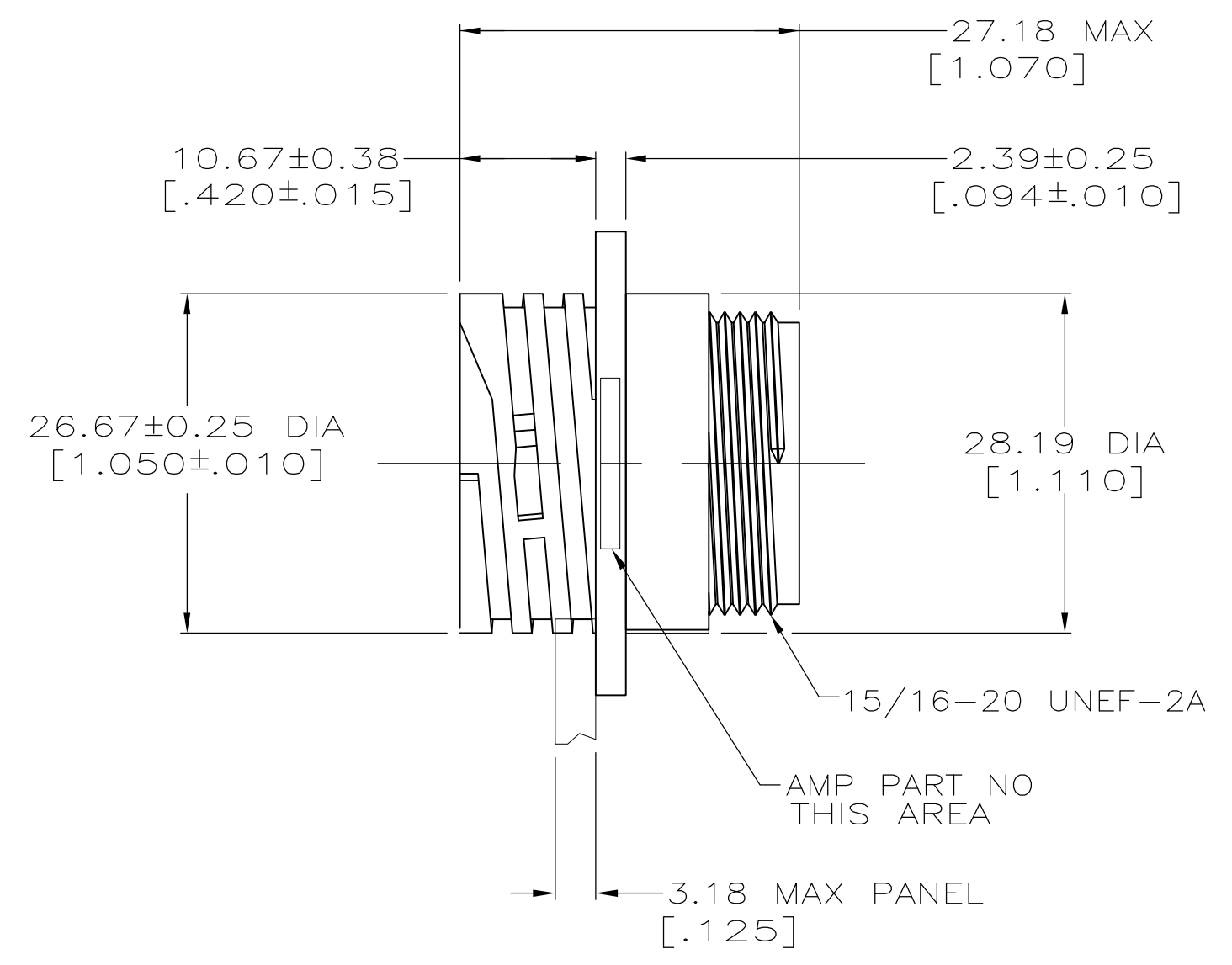
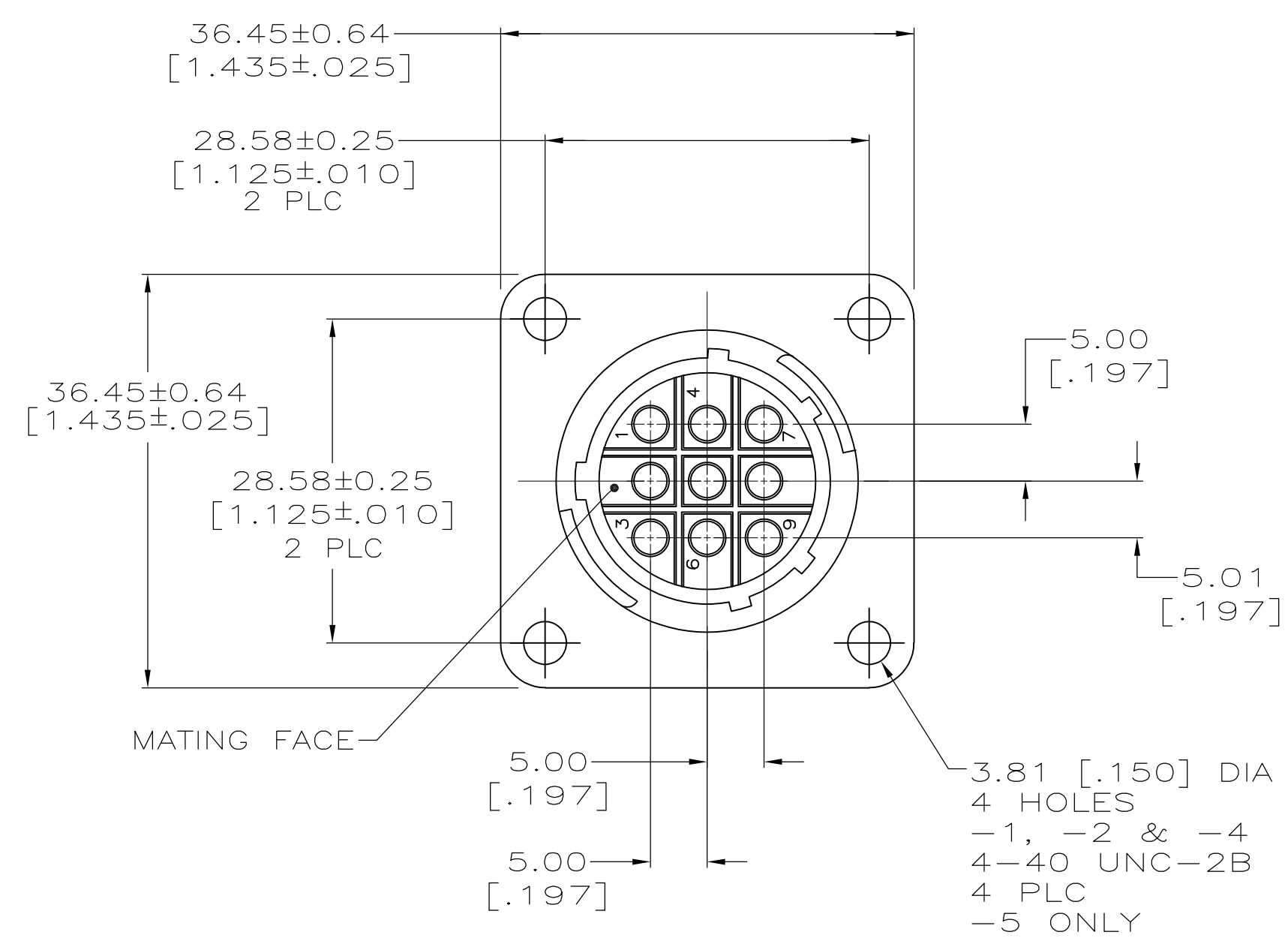

211769-1, -2, -4 & -5

D

C

B

A

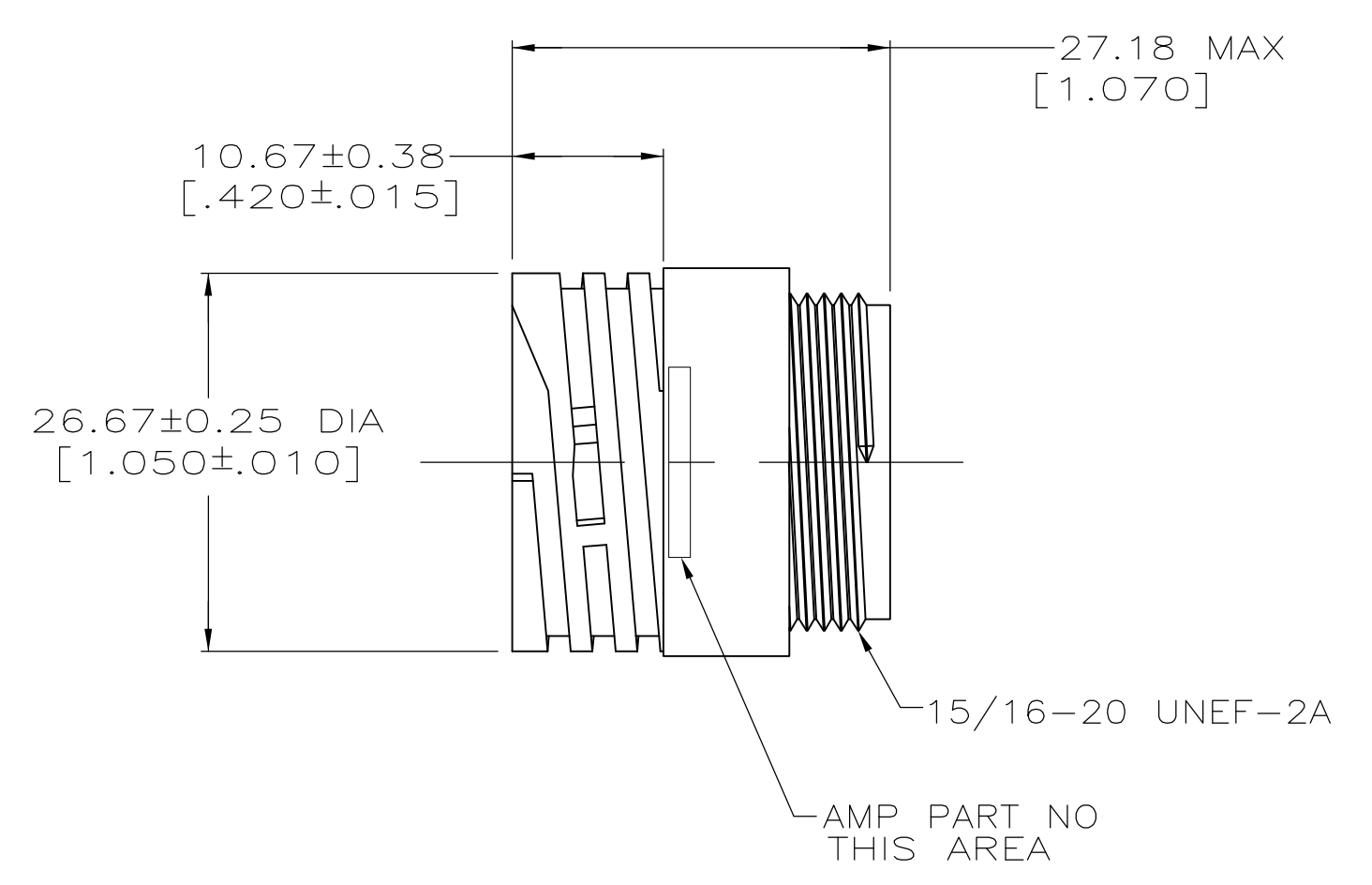
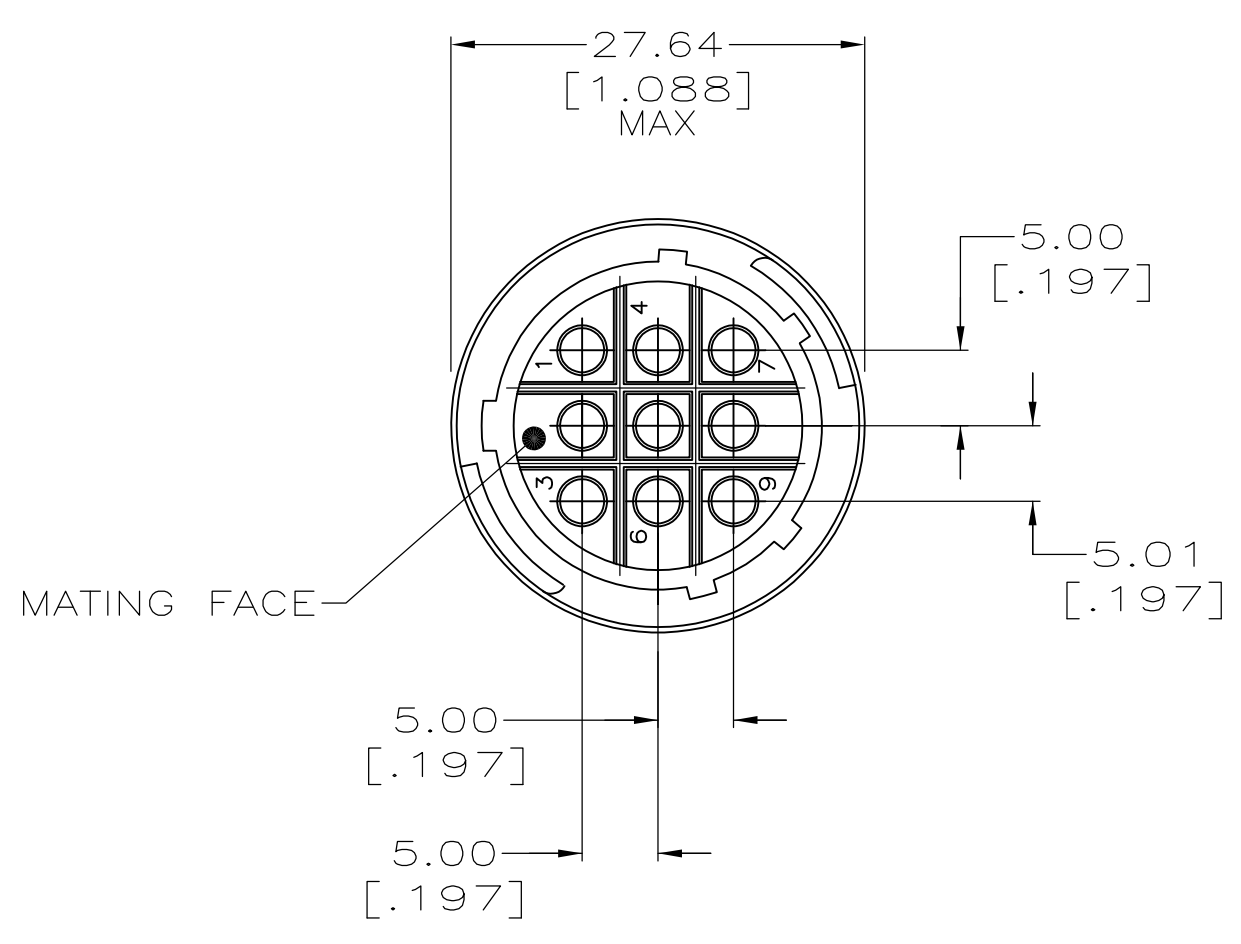

211769-3

1. CAVITY IDENTIFICATION ON FRONT AND REAR FACE.
2. WILL ACCEPT NINE (9) MULTIMATE SOCKET CONTACTS.
3. 3.81[.150] MAXIMUM INSULATION DIAMETER.
4. 2.54[.100] MAXIMUM INSULATION DIAMETER.

YES	FLANGE	211769-5
NO	FLANGE	211769-4
NO	FREE HANGING	211769-3
NO	FLANGE	211769-2
NO	FLANGE	211769-1
THREADED INSERTS	MOUNTING	PART NUMBER

THIS DRAWING IS A CONTROLLED DOCUMENT.		DWN D.BROCKWAY 09-24-94	TE Connectivity	
DIMENSIONS: mm [INCHES]		CHK R.STONE 09-30-94	NAME	
TOLERANCES UNLESS OTHERWISE SPECIFIED:		APPV A.FRANTUM 10-03-94	RECEPTACLE HOUSING, REVERSE SEX, SHELL SIZE 17, CPC	
0 PLC ± - 1 PLC ± - 2 PLC ± 0.13 [.005] 3 PLC ± - 4 PLC ± - ANGLES ± -		PRODUCT SPEC	SIZE A1	
MATERIAL -		FINISH -	CAGE CODE 00779	
WEIGHT -		RESTRICTED TO	DRAWING NO 211769	
CUSTOMER DRAWING		SCALE 2:1	SHEET 1 OF 1	
			REV G1	