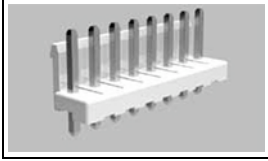

[My Cart](#) | [My Part Lists](#) | [Sign In/Register](#)[English \(Change\)](#)

Have a Question?
Chat with a Product
Information Specialist

What can we help you find?

[Products](#) [Industries](#) [Resources](#) [About TE](#) [My Account](#) [Innovation](#) [Support Center](#)**1-1123723-8 Product Details**[Share](#)[Print](#)[Email](#)**1-1123723-8**

TE Internal Number: 1-1123723-8



Active

[View 3D PDF](#)**Economy Power Connectors**

Converted to EU RoHS/ELV Compliant
(Statement of Compliance)

Product Highlights:

- Economy Power Product Line
- Connector
- Wire-to-Board
- Applies To Printed Circuit Board
- 8 Positions

[View all Features](#)**Quick Links**

- ▶ [Pricing & Availability](#)
- ▶ [Search for Tooling](#)
- ▶ [View Mating Products \(2\)](#)
- ▶ [View Headers \(1\)](#)
- ▶ [Product Feature Selector](#)
- ▶ [Contact Us About This Product](#)

Documentation & Additional Information**Product Drawings:**

- [3.96\(7.92\)MM PITCH ECONOMY POWER\(EP\) CONN HEADER ASSY \(PDF, English\)](#)

Catalog Pages/Data Sheets:

- [7-1773458-5_ECONOMY_POWER_QRG \(PDF, English\)](#)

Product Specifications:

- [EP II Connector System \(PDF, English\)](#)
- [Economy Power \(EP\) Connector \(PDF, Japanese\)](#)

Application Specifications:

- [Economy Power \(EP\)-II Contacts and Receptacle Housings \(PDF, English\)](#)
- [Crimping Economy Power \(EP\) Contact \(PDF, Japanese\)](#)

Instruction Sheets:

- [Economy Power \(EP\) Connector \(PDF, Japanese\)](#)

CAD Files: (CAD Format & Compression Information)

- [2D Drawing \(DXF, Version W\)](#)
- [3D Model \(IGES, Version W\)](#)
- [3D Model \(STEP, Version W\)](#)

[List all Documents](#)**Related Products:**

- [Tooling](#)
- [Mating Products \(2\)](#)
- [Headers \(1\)](#)

Product Features (Please use the Product Drawing for all design activity)**Product Type Features:**

- Product Line = Economy Power
- Product Type = Connector
- Connector Type = Header
- PCB Mounting Orientation = Vertical
- PCB Mount Retention = Without
- PCB Mount Alignment = Without
- Sealed = No

Mechanical Attachment:

- Mating Retention Type = Latching

Electrical Characteristics:

- Contact - Rated Current (A) = 7.5
- Operating Voltage Reference = AC
- Operating Voltage (VAC) = 250

Termination Features:

- Termination Method to PC Board = Through Hole - Solder

Dimensions:

- PCB Thickness, Recommended (mm [in]) = 1.60 [0.063]
- Tail Length (mm [in]) = 3.7 [0.146]
- Length (X-Axis) (mm [in]) = 31.62 [1.2448]
- Width (Z-Axis) (mm [in]) = 10.70 [0.421]
- Profile Height (Y-Axis) (mm [in]) = 8.50 [0.3346]

Housing Features:

- Centerline (mm [in]) = 3.96 [0.156]
- Connector Style = Plug
- Housing Color = Natural
- Housing Material = PBT GF
- Mating Alignment = With

Configuration Features:

- Number of Positions = 8
- Number of Rows = 1
- Tail Orientation = In-line

Industry Standards:

- RoHS/ELV Compliance = RoHS compliant, ELV compliant
- Lead Free Solder Processes = Wave solder capable to 240°C, Wave solder capable to 260°C, Wave solder capable to 265°C
- RoHS/ELV Compliance History = Converted to comply with RoHS directive
- UL Flammability Rating = UL 94V-0

Environmental:

- Operating Temperature (°C [°F]) = -25 - +105 [-13 - +221]

Conditions for Usage:

- Applies To = Printed Circuit Board
- Glow Wire Rating = Standard Part - Not Glow Wire

<p>Body Features:</p> <ul style="list-style-type: none"> • Selectively Loaded = No • Header Type = Unshrouded • Mating Retention = With <p>Contact Features:</p> <ul style="list-style-type: none"> • Contact Type = Pin • Contact Plating, Termination Area, Material = Tin • Contact Plating, Termination Area, Thickness (µm [µin]) = 0.8 [31.49] • Contact Plating, Mating Area, Thickness (µm [µin]) = 0.8 [31.49] • Contact Plating, Mating Area, Material = Tin • Contact Design = Square Post • Contact Base Material = Brass 	<p>Operation/Application:</p> <ul style="list-style-type: none"> • Application Use = Wire-to-Board • Contact Transmits (Typical Application) = Power <p>Other:</p> <ul style="list-style-type: none"> • Brand = AMP
---	--

Customer Support

[Email or Chat With Us](#)

[Find a Phone Number](#)

[Knowledge Base](#)

[Manage Your Account](#)



© 2014 TE Connectivity Ltd. family of companies. All Rights Reserved | [\[+\] Provide Website Feedback](#)

THIS DRAWING IS UNPUBLISHED.

RELEASED FOR PUBLICATION

-,-

© COPYRIGHT - By -

ALL RIGHTS RESERVED.

LOC

DIST

REVISIONS

変更

DESCRIPTION

DATE

DWN

APVD

P

LTR

REVISED PER ECR-12-007692

25APR12

LL

FM

POST POSITION No.1



表 1
(TABLE 1)

No	名称 (NAME)	材料 (MATERIAL)
①	ヘッダーハウジング (HEADER HOUSING)	PBT ガラス強化 UL94V-0 (PBT GLASS FILLED UL94V-0)
②	ポスト コンタクト (POST CONTACT)	黄銅錫めっき仕上げ (POST TIN・BRASS)

- 注記:
- 嵌合相手側製品型番: □-1123722-□
 - 取付け基板寸法: FIG 1参照
 - 適用基板厚: 1.6t
 - 7.92mmピッチタイプ (FIG.2参照)

- NOTES:
- MATING CONN P/N: □-1123722-□
 - APPLICABLE P.C.B LAY OUT: SEE FIG.1
 - APPLICABLE P.C.B THICKNESS: 1.6t
 - TYPE OF 7.92mmPITCH(SEE FIG.2)
 - OBSOLETE PARTS: OBSOLETE CIS STREAMLINING PER D.RENAUD/D.SINISI

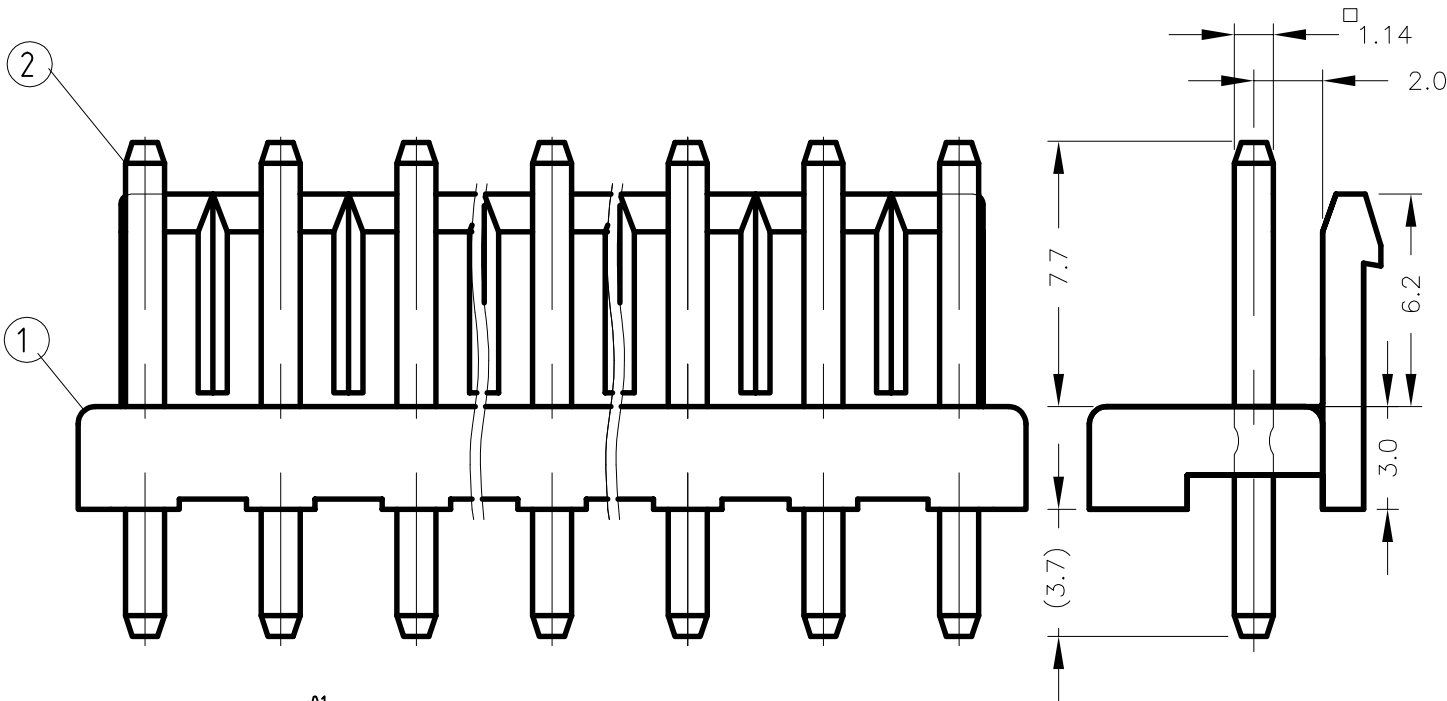
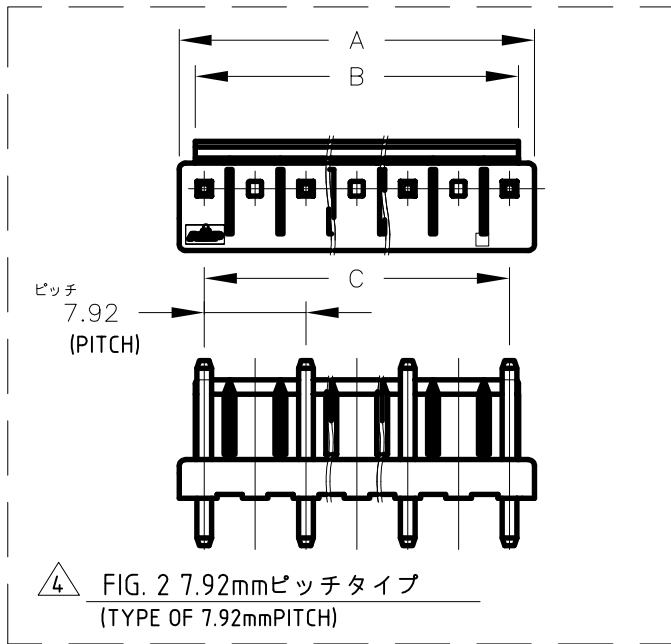
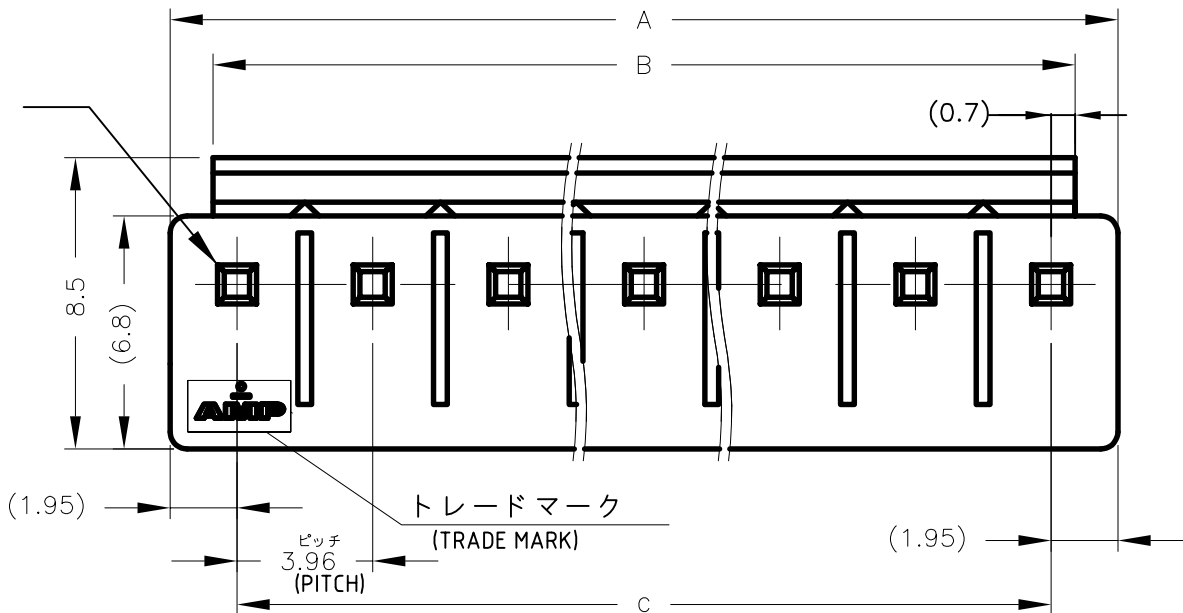
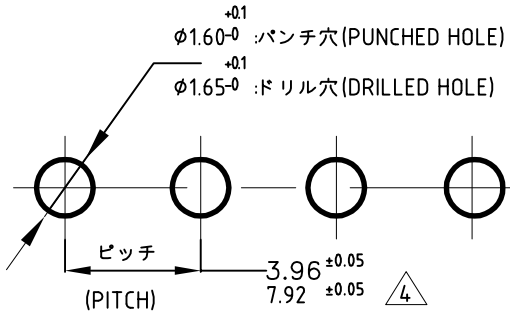
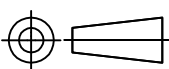

FIG. 1

THIS DRAWING IS A CONTROLLED DOCUMENT.

DIMENSIONS:
単位: 耗
mm



MATERIAL
材料
SEE TABLE1

TOLERANCES UNLESS
OTHERWISE SPECIFIED:
一般公差

0 PLC 5> ± 0.3
1 PLC 5< ± 0.4
2 PLC ±
3 PLC ±
4 PLC ±
ANGLES ±

FINISH
仕上

—//—

DWN 13MAR'01

N.YAMASAKI

CHK 13MAR'01

M.SHINDO

APVD 13MAR'01

Y.KASHIWA

PRODUCT SPEC
製品規格
108-5609

APPLICATION SPEC
取付適用規格

WEIGHT

CUSTOMER DRAWING



TE Connectivity

NAME
名称
3.96(7.92)MM PITCH ECONOMY POWER(EP) CONN
HEADER ASSY

3.96(7.92)mmピッチ エコノミーパワー(EP)コネクタ ヘッダーアッセンブリ

SIZE

CAGE CODE

DRAWING NO

番号

A300779C=1123723

RESTRICTED TO

—

SCALE

尺度

SHEET

1 of 3

REV

Z1

2) × : ポスト抜き (WITHOUT POST)

A1470-19 (3/11)

