

[My Cart](#) | [My Part Lists](#) | [Sign In/Register](#)[English \(Change\)](#)

Have a Question?
Chat with a Product
Information Specialist

What can we help you find?

[Products](#) [Industries](#) [Resources](#) [About TE](#) [My Account](#) [Innovation](#) [Support Center](#)**206036-1 Product Details**[Share](#)[Print](#)[Email](#)**206036-1**

TE Internal Number: 206036-1



Active

[View 3D PDF](#)**CPC (Circular Plastic) and Circular Metal-Shell Connectors**

Always EU RoHS/ELV Compliant (Statement of Compliance)

Product Highlights:

- Housing
- Connector Style = Receptacle
- 16 Positions
- 16 Signal Positions
- 0 Power Positions

[View all Features](#)**Quick Links**

- ▶ [Pricing & Availability](#)
- ▶ [Search for Tooling](#)
- ▶ [View Mating Products \(4\)](#)
- ▶ [Product Feature Selector](#)
- ▶ [Contact Us About This Product](#)

[Add to My Part List](#)[Request Sample](#)[Find Similar Products](#)[Buy Product](#)**Documentation & Additional Information****Product Drawings:**

- [RECEPTACLE HOUSING, STD SEX, SHELL SIZE 17, CPC](#) (PDF, English)

Catalog Pages/Data Sheets:

- [AMP Circular Connectors for Commercial Signal & Power](#) (PDF, English)

Product Specifications:

- None Available

Application Specifications:

- [Circular Plastic Connectors \(CPC\)](#) (PDF, English)

Instruction Sheets:

- [Circular Plastic Connectors \(CPC\)](#) (PDF, English)

CAD Files: (CAD Format & Compression Information)

- [2D Drawing](#) (DXF, Version AV)
- [3D Model](#) (IGES, Version AV)
- [3D Model](#) (STEP, Version AV)

[List all Documents](#)**Additional Product Images:**

- [Contact Arrangement](#)
- [Keying Options](#)

Related Products:

- [Tooling](#)
- [Mating Products \(4\)](#)

Product Features (Please use the Product Drawing for all design activity)**Product Type Features:**

- Connector Type = Housing
- Mount Angle = Straight
- Shell Size = 17
- PCB Mount Retention = Without
- Shell Type = All Plastic
- Product Series = Series 1
- Thread Size = 15/16-20 UNEF-2A
- Sealed = No

Mechanical Attachment:

- Mount = Panel
- Mating Retention Type = Threaded Coupling

Body Features:

- Mount Style = Flange with Mounting Holes

Contact Features:

- Contact Type = Pin
- Reverse Gender = Standard

Housing Features:

- Connector Style = Receptacle
- Mating Alignment Type = Keyed
- Housing Material = Thermoplastic - GF
- Housing Color = Black
- ILL Flammability Rating = ILL 94V-0

Configuration Features:

- Number of Positions = 16
- Number of Signal Positions = 16
- Number of Power Positions = 0
- Environmental Protection = Without
- Reverse Numbering = Without

Industry Standards:

- VDE Tested = No
- RoHS/ELV Compliance = RoHS compliant, ELV compliant
- Lead Free Solder Processes = Not relevant for lead free process
- RoHS/ELV Compliance History = Always was RoHS compliant

Identification Marking:

- Keying = A

Environmental:

- Fluid Resistance = None

Conditions for Usage:

- Accepts Wire Insulation Diameter, Range (mm [in]) = 2.54 [0.100]

Other:

- Brand = AMP

- 1
- HOUSING: NYLON, BLACK.
PERIPHERAL SEAL: ELASTOMER, GRAY.
THREADED INSERTS: BRASS.
- 2
- CAVITY IDENTIFICATION ON FRONT AND REAR FACE.
- 3
- WILL ACCEPT (16) MULTIMATE PIN CONTACTS.
- 4
- HOUSING: NYLON, BLUE.
PERIPHERAL SEAL: ELASTOMER, GRAY.
THREADED INSERTS: BRASS.
- 5
- OBSOLETE PARTS: OBSOLETE CIS STREAMLINING PER D.RENAUD/D.SINISI

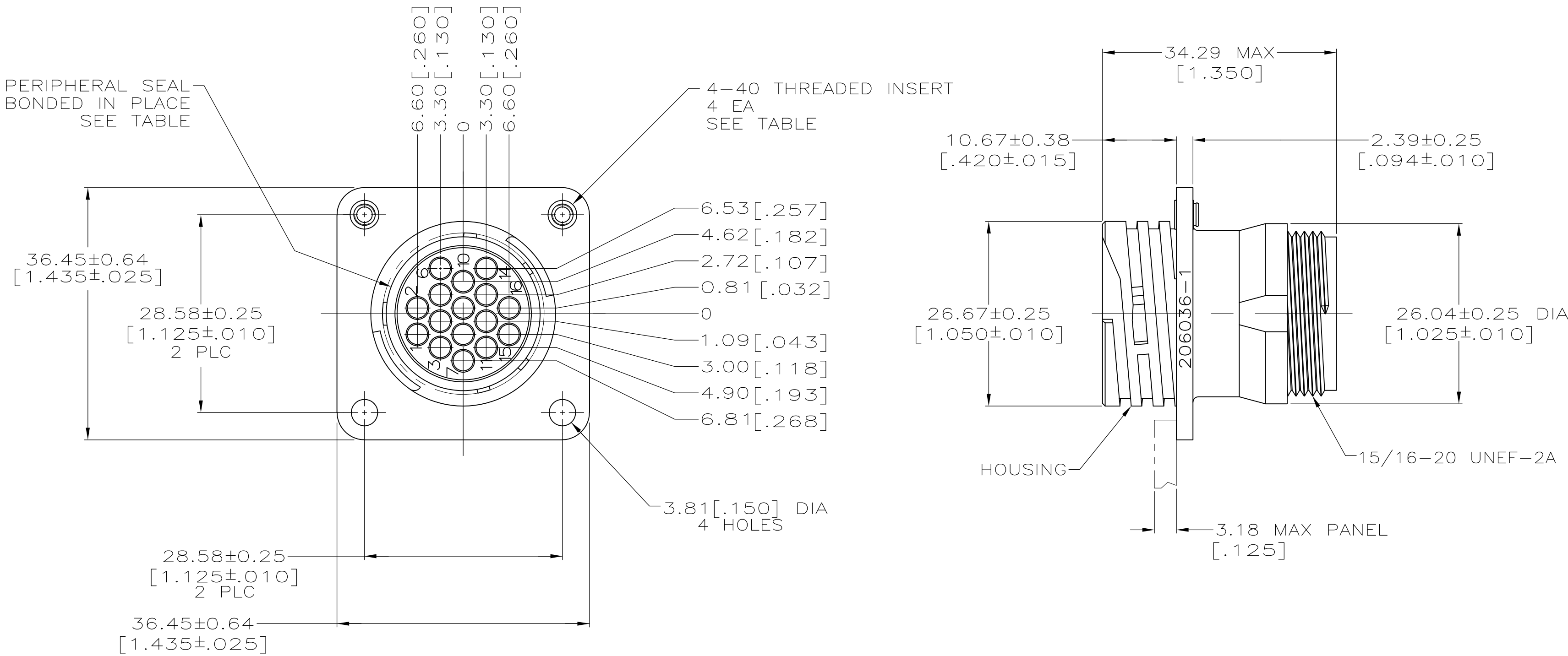

RECOMMENDED PANEL CUTOUT

OBSOLETE	4	STANDARD	NO	YES	206036-9
	4	STANDARD	YES	NO	206036-8
	4	SMALL PACK	NO	NO	206036-7
	4	STANDARD	NO	YES	206036-4
	4	STANDARD	NO	NO	206036-1
MATERIAL		PACKAGING	4-40 THREADED INSERTS	PERIPHERAL SEAL	PART NUMBER
THIS DRAWING IS A CONTROLLED DOCUMENT.			DWN D. GELTZ CHK R. STONE APVD A. FRANTUM	TE Connectivity	
DIMENSIONS: mm[INCHES]		TOLERANCES UNLESS OTHERWISE SPECIFIED:		NAME	
		0 PLC ± - 1 PLC ± - 2 PLC ± 0.13 [.005] 3 PLC ± - 4 PLC ± - ANGLES ± -		PRODUCT SPEC 108-10024	
MATERIAL		FINISH		APPLICATION SPEC	
-		-		-	
CUSTOMER DRAWING			SCALE	2:1	SHEET 1 OF 3
			REV	T	

- 1 CAVITY IDENTIFICATION ON FRONT AND REAR FACE.
- 2 WILL ACCEPT (3) TYPE XII PIN CONTACTS.
- 3 HOUSING: NYLON, BLACK.
PERIPHERAL SEAL: ELASTOMER, GRAY.

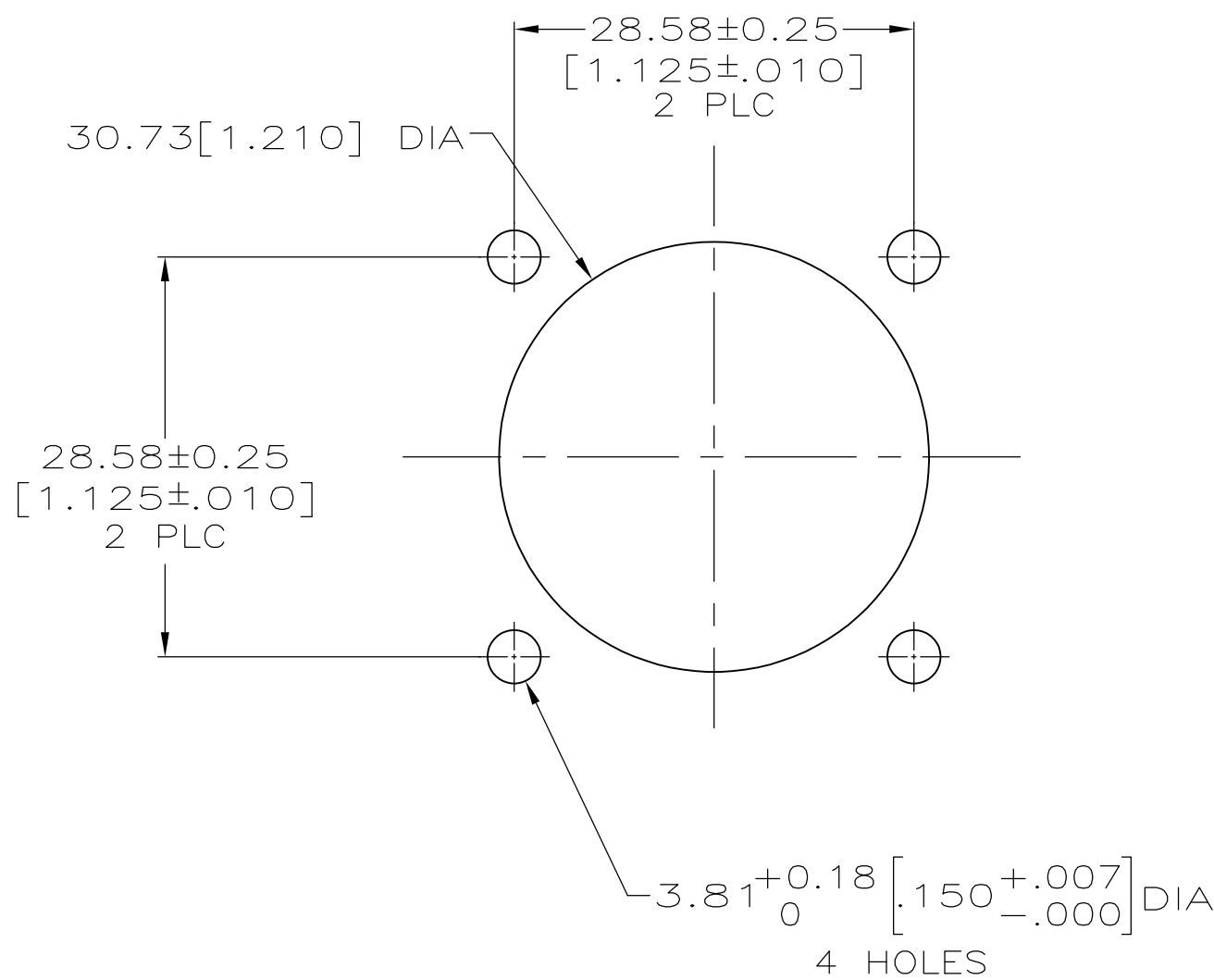
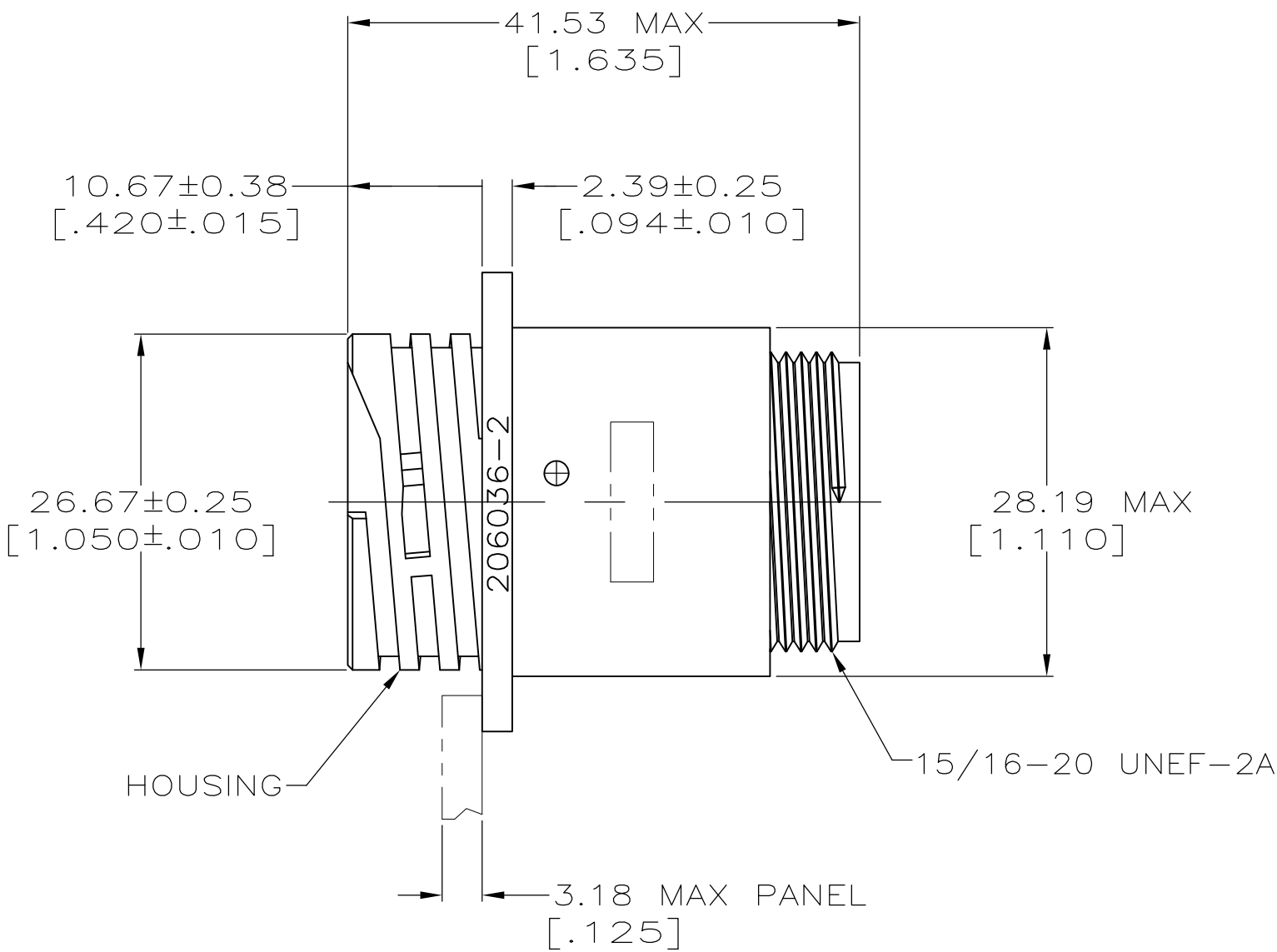
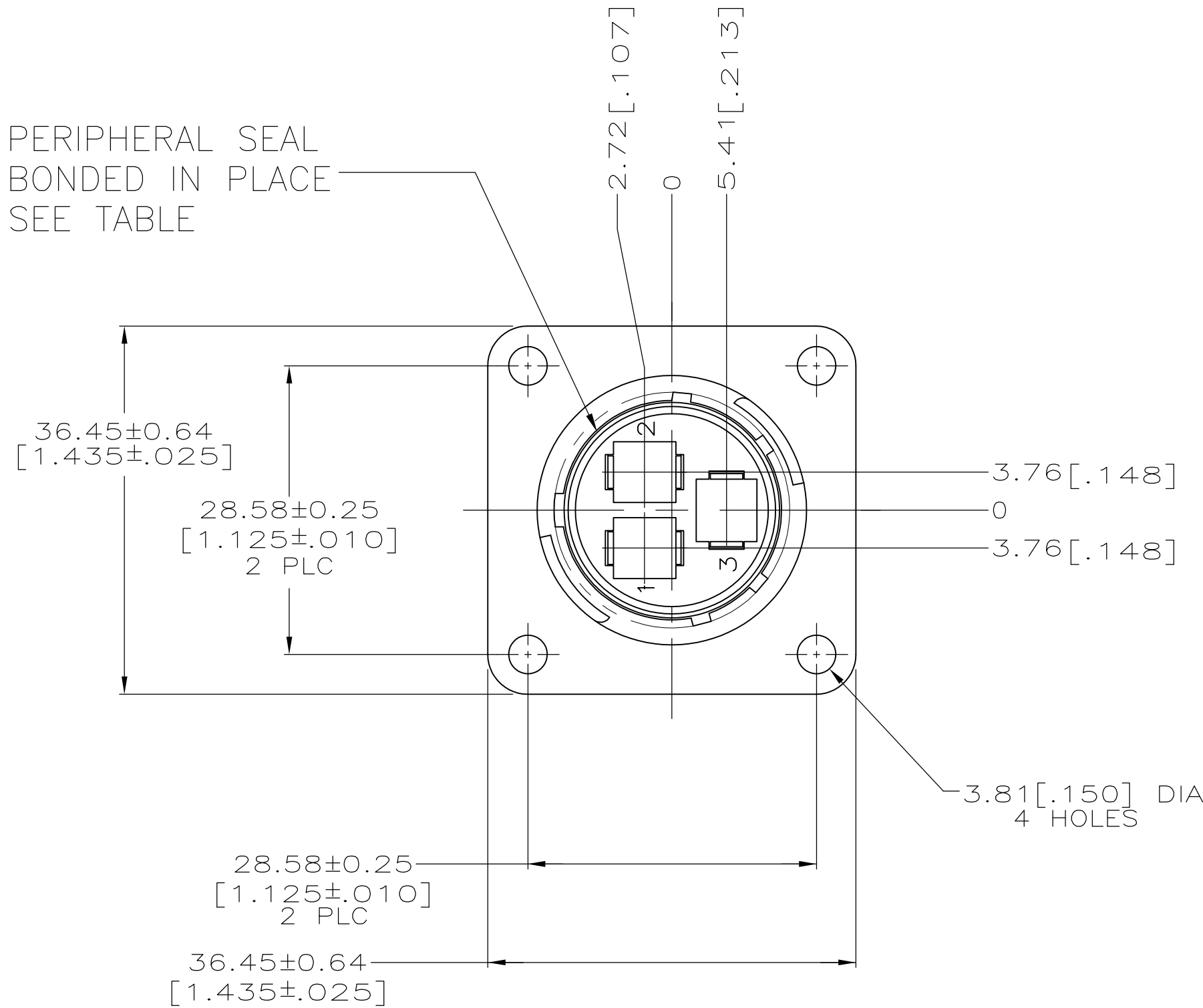

RECOMMENDED PANEL CUTOUT

PRELIMINARY	<div>3</div>	NO	YES	1-206036-6
	<div>3</div>	NO	NO	206036-2
MATERIAL	4-40 THREADED INSERTS		PERIPHERAL SEAL	PART NUMBER
THIS DRAWING IS A CONTROLLED DOCUMENT.		DWN D. GELTZ CHK R. STONE APVD A. FRANTUM	TE Connectivity	
DIMENSIONS: mm[INCHES]		TOLERANCES UNLESS OTHERWISE SPECIFIED:	NAME	
		0 PLC ± -	PRODUCT SPEC	
		1 PLC ± -	108-10024	
		2 PLC ± 0.13 [.005]	APPLICATION SPEC	
MATERIAL		FINISH	WEIGHT	RESTRICTED TO
-		-	-	-
CUSTOMER DRAWING		SCALE	SHEET	REV
		2:1	2 OF 3	T

LOC	DIST	REVISIONS				
		P	LTR	DESCRIPTION	DATE	DWN
FT	0			SEE SHEET 1		

- 1 CAVITY IDENTIFICATION ON FRONT AND REAR FACE.
- 2 WILL ACCEP (16) MULTIMATE PIN CONTACTS.
- 3 HOUSING: NYLON, BLACK.
PERIPHERAL SEAL: ELASTOMER, GRAY.
- 4 HOUSING: POLYESTER, PBT, BLACK.
PERIPHERAL SEAL: ELASTOMER, GRAY.

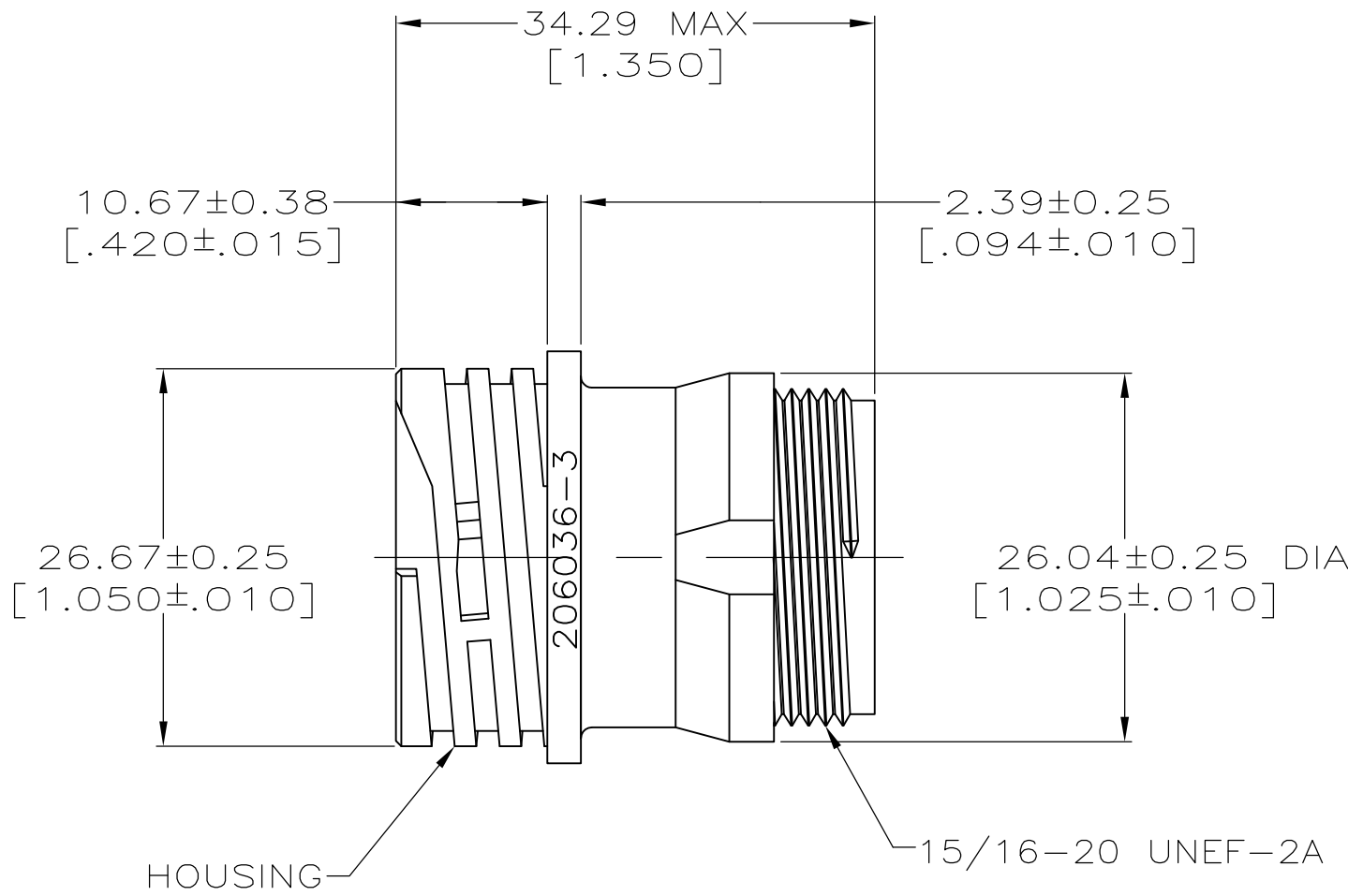
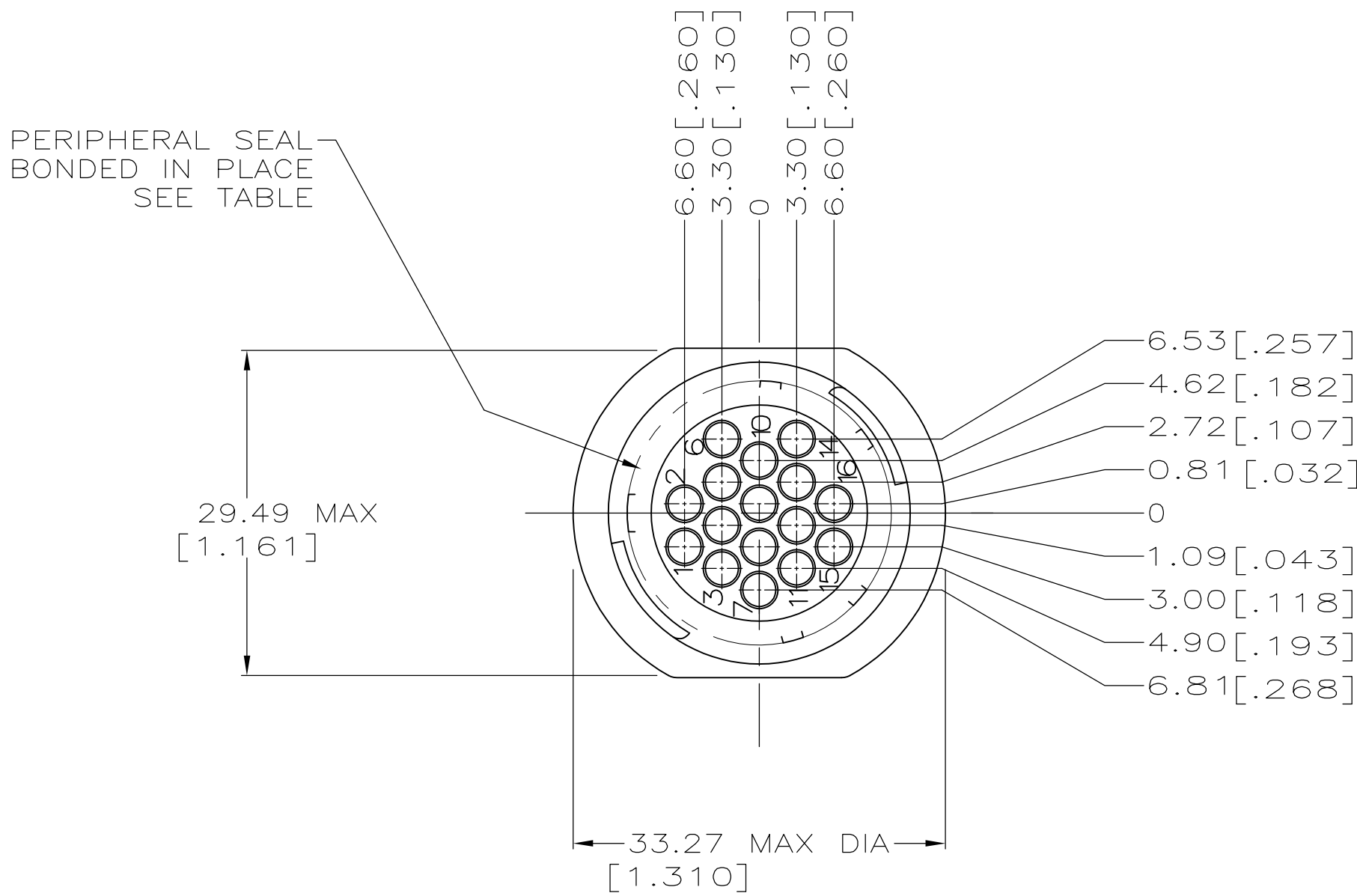

OBSOLETE	4	NO	1-206036-3
	3	YES	206036-5
	3	NO	206036-3
MATERIAL		PERIPHERAL SEAL	PART NUMBER

THIS DRAWING IS A CONTROLLED DOCUMENT.

DWN
D. GELTZ
CHK
R. STONE
APVD
A. FRANTUM

07/27/93
7-22-93
8-12-93

TE Connectivity

RECEPTACLE HOUSING, STD SEX,
SHELL SIZE 17, CPC

DIMENSIONS:

mm[INCHES]

TOLERANCES UNLESS OTHERWISE SPECIFIED:

0 PLC ± -
1 PLC ± -
2 PLC ± 0.13 [.005]
3 PLC ± -
4 PLC ± -
ANGLES ± -
FINISH -

PRODUCT SPEC
108-10024

APPLICATION SPEC

SIZE
A1

CAGE CODE
00779

DRAWING NO
206036

RESTRICTED TO
-

MATERIAL
-

WEIGHT
-

CUSTOMER DRAWING

SCALE
2:1

SHEET
3

OF
3

REV
T