

Part no.: 21100-721



Features:

- For handles on plug-in units type 2



Technical information:

Description	Description	Qty/PU	Application
Washer	2.7, St, nickel-plated	100 piece	

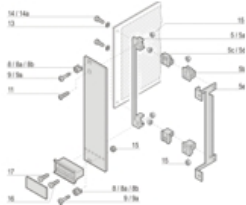

Item 13, 3 U front panel mounting

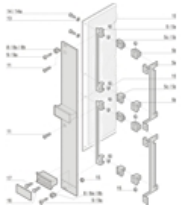

Item 13, 6 U front panel mounting

Delivery comprises:

Quantity required for IEEE-Plug-in units			
3 U		6 U	
< 8 HP	≥ 8 HP	< 8 HP	≥ 8 HP
2	2	2	2

Quantity required for plug-in units type 2 with extraction handle			
3 U		6 U	
< 8 HP	≥ 8 HP	< 8 HP	≥ 8 HP
2	2	2	2

Quantity required for plug-in units type 2 with fixed handle							
3 U				6 U			
unshielded		shielded		unshielded		shielded	
< 8 HP	≥ 8 HP	< 8 HP	≥ 8 HP	< 8 HP	≥ 8 HP	< 8 HP	≥ 8 HP
2	2	2	2	4	4	4	4