

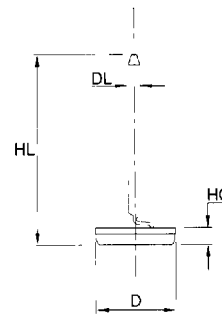

ENGINEERING DATA - DISH DIODES - 20/30 AMP

DIMENSIONS

SYM.	INCHES		MILLIMETERS	
	MIN.	MAX.	MIN.	MAX.
D (20 amp)	.329	.333	8.36	8.46
DL(30amp)	.379	.383	9.63	9.77
DL	.056	.058	1.42	1.47
HL	.865	.890	21.97	22.61
HC	.079	.086	2.00	2.18



ELECTRICAL RATINGS OF STANDARD DISH DIODE - 20 AMP

CHARACTERISTICS	SYMBOL	7410, 7411			7420, 7421	7430, 7431	UNIT
RENARD PART NUMBER		7410, 7411	7420, 7421	7430, 7431			
Peak Repetitive Reverse voltage	V_{RRM}	100	200	300			Volts
Non Repetitive Peak Reverse Voltage	V_{RSM}	120	240	360			Volts
Average Rectified Forward Current	I_o	20					Amps
Non Repetitive Peak Surge Current	I_{FSM}	400					Amps
Operating and Storage Junction Temp Rg	T_J, T_{stg}	-40 to +175					°C
Thermal Resistance, Junction to Case	R_{OJC}	0.8					°C/Watt
Maximum Instantaneous Forward Voltage Drop I_F 80 Amp. T_C 25°C		1.2					Vdc
Maximim Reverse Current (rated dc voltage) T_C 25°C		.5					Milliamps

ELECTRICAL RATINGS OF STANDARD DISH DIODE - 30 AMP

CHARACTERISTICS	SYMBOL	7412, 7413			7422, 7423	7432, 7433	UNIT
RENARD PART NUMBER		7412, 7413	7422, 7423	7432, 7433			
Peak Repetitive Reverse voltage	V_{RRM}	100	200	300			Volts
Non Repetitive Peak Reverse Voltage	V_{RSM}	120	240	360			Volts
Average Rectified Forward Current	I_o	30					Amps
Non Repetitive Peak Surge Current	I_{FSM}	400					Amps
Operating and Storage Junction Temp. Rg	T_J, T_{stg}	-40 to +175					°C
Thermal Resistance, Junction to Case	R_{OJC}	0.6					°C/Watt
Maximum Instantaneous Forward Voltage Drop I_F 80 Amp. T_C 25°C		1.2					Vdc
Maximim Reverse Current (rated dc voltage) T_C 25°C		5					Milliamps