

REV.	DATE	DESCRIPTION
NC	03/08/05	INITIAL RELEASE

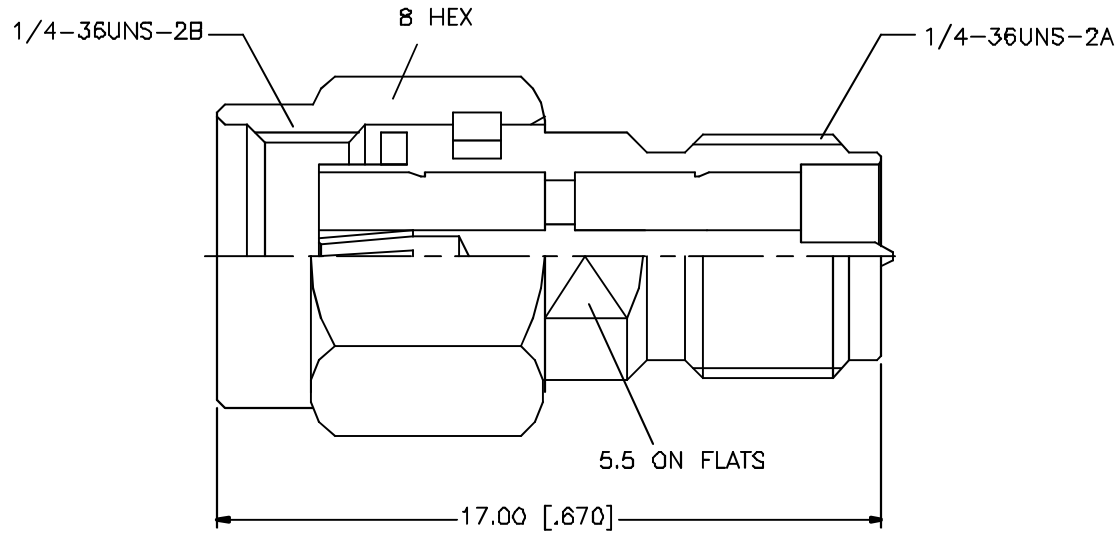

8					<small>UNLESS OTHERWISE SPECIFIED DIMENSIONS ARE IN MILLIMETERS DIMENSIONS IN () ARE IN INCHES AND FOR CUSTOMER REFERENCE ONLY.</small> <small>UNLESS OTHERWISE SPECIFIED TOLERANCES FOR MILLIMETERS ARE:</small> Ø.5 - 8mm ± 0.20mm 8 - 30mm ± 0.40mm 30 - 120mm ± 0.50mm <small>UNLESS OTHERWISE SPECIFIED TOLERANCES FOR INCHES ARE:</small> .020 - .315 = ± 0.007" .315 - 1.180 = ± 0.015" 1.180 - 4.724 = ± 0.020" DD NOT SCALE DRAWING	APPROVALS	DATE	<h1 style="color: blue; margin: 0;">Amphenol Connex</h1>	
7				DRAWN		G.R.S.	03/08/05		PART DESCRIPTION SMA REV. POLARITY JACK TO REV. POLARITY PLUG ADAPTER
6				CHECKED					
5				ISSUED					
4				SHEET		1 OF 1			PART NO.
3	CONTACT PIN	BER. COPPER	GOLD	1			DWG. NO.	132171RP-RP.DWG	
2	INSULATOR	TEFLON	NATURAL	1			REV	NC	
1	BODY	BRASS	GOLD	1			SIZE	A	
	DESCRIPTION	MATERIAL	FINISH	QTY			SCALE	NA	
						CAD FILE			
						C:/132/132171RP-RP.DWG			

Amphenol Connex

Adapters

Amphenol Connex
5069 Maureen Lane, Unit B
Moorpark, CA 93021 USA

New

FEATURES & BENEFITS:

- High Quality
- Wide Selection
- Low Cost

APPLICATIONS:

- Instrumentation
- Military-Aerospace
- Broadband
- RFID
- Telecommunication

800.942.6639
www.amphenolconnex.com

7/16 & N Adapter Kit
P/N 312100 • Call for Details

QUALITY COAXIAL ADAPTERS



Amphenol Connex

Coaxial Adapters

		MMCX		MCX		SMA		SMB		SMC		Mini-UHF		F		BNC		TNC		UHF		N		7/16		U.FL	
		Plug	Jack	Plug	Jack	Plug	Jack	Plug	Jack	Plug	Jack	Plug	Jack	Plug	Jack	Plug	Jack	Plug	Jack	Plug	Jack	Plug	Jack	Plug	Jack	Jack	
MMCX	Plug	262132				242142	242141																242169	242167			
	Jack	262136	262129			242140	242142																242166	242168		242225	
	Bulkhead Jack		262130																								
MCX	Plug				252169	242128	242127																242173	242171			
	Jack				252171	242126	242129																242170	242172			
SMA	Plug	242142	242140	242128	242126	132168 132339 R/A	132171	242146	242144	242177	242174	242118	242116		242104	242102	242106	242124	242110	242108		242114	242112			242212	
	Jack	242141	242143	242127	242129	132171 132172 R/A	132169 132274 R/A	242145	242147	242175	242176	242117	242119		242103	242123	242105	242107	242109	242111		242113	242115				
	Bulkhead Jack	242193					132170 132170-10		242182							242227											272188
SMB	Plug					242146	242145	142246	142310																		
	Jack					242144	242147	142310	142244																		
Bulkhead Jack	Plug					242177	242175																				
	Jack					242174	242176			252141																	
Mini-UHF	Plug					242118	242117														242153						
	Jack					242116	242119																				
F	Plug													222156	222157 Push-on 222122 R/A								242157	242152			
	Jack							242223	242224					222157 Push-on 222122 R/A		242154	242161						242156 242158 R/A	242120			
	Bulkhead Jack														222121												
BNC	Plug			242205	242203	242104	242103	242187	242184					242160	242154	112447 50Ω 112448 75Ω 112655 50Ω R/A	112667 50Ω 112668 75Ω	242151	242148	242139	242134	242122	242101				
	Jack			242204	242206	242102	242123	242185	242186					242159	242161	112451 50Ω 112452 75Ω	112445 50Ω 12446 75Ω	242149	242150	242164 242232 R/A	242165	242121	242100				
	Bulkhead Jack																112433 50Ω 112434 75Ω						242162				
	Panel Jack																112712										
TNC	Plug			242210	242208	242106	242105							242197			242151	242149	122350 50Ω 122351 75Ω	122352 50Ω R/A 122353 75Ω R/A		242133	242131				
	Jack			242209		242124	242107										242148	242150	122352 50Ω R/A 122353 75Ω R/A	122348 50Ω 122349 75Ω		242130	242132				
	Bulkhead Jack						242178													122342 50Ω 122343 75Ω						242192	
UHF	Plug					242110	242109										242139	242164									
	Jack					242108	242111										242134	242165									
Bulkhead Jack	Plug																				182134 R/A						
	Jack																				182109	242155					
	Bulkhead Jack																									242216	
N	Plug	242169	242166	242173	242170	242114	242113							242157	242156 242158 R/A	242122	242121	242133	242130		242155	172122 172261 R/A	172276 172126 R/A	242138	242135		
	Jack	242167	242168	242171	242172	242112	242115							242152	242120	242101	242100	242131	242132			172276 172126 R/A	172123	242136	242137		
	Bulkhead Jack						242125		242183													172336	172124		272183		
	Panel Jack						242163		242198														172278				
7/16	Plug																					242138	242136	272134	272150 R/A		
	Jack																					242135	242137	272150 R/A	272135		
Bulkhead Jack	Plug																									272174	
	Jack																										
1.0/2.3	Plug																							242217			
	Jack																							242218			
Bulkhead Jack	Plug																										
	Jack																										
Bulkhead Jack	Plug																										
	Jack																										
Bulkhead Jack	Plug																										
	Jack																										
Bulkhead Jack	Plug																										
	Jack																										
Bulkhead Jack	Plug																										
	Jack																										
Bulkhead Jack	Plug																										
	Jack																										
Bulkhead Jack	Plug																										
	Jack																										
Bulkhead Jack	Plug																										
	Jack																										
Bulkhead Jack	Plug																										
	Jack																										
Bulkhead Jack	Plug																										
	Jack																										
Bulkhead Jack	Plug																										
	Jack																										
Bulkhead Jack	Plug																										
	Jack																										
Bulkhead Jack	Plug																										
	Jack																										
Bulkhead Jack	Plug																										
	Jack																										
Bulkhead Jack	Plug																										
	Jack																										
Bulkhead Jack	Plug																										