

704.074.2 - Stop switch actuator

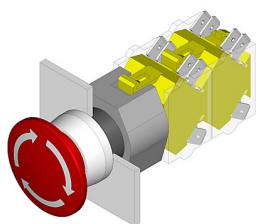

Attention: The preview is based on a sample product. This can differ from your current configuration.

Mounting

Mounting cut-out Ø 22.5 mm
Design raised

Front

Front ring material Plastic
Front ring colour grey
Front shape round
Front dimension Ø 40 mm

Other Attributes

Marking Arrows
Weight 0.047 kg

Operating-/Indication part

Lens material Plastic
Lens optics opaque
Lens profile Mushroom
Lens colour red

IP-Rating

Front protection IP 65

Actuator

Switching action Maintained

Function

Stop switch

EAO – Your Expert Partner for Human Machine Interfaces

704.074.2 - Stop switch actuator

Dimensions

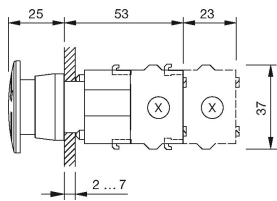

X = Screw terminal

Mounting cut-outs

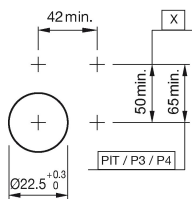

PIT = Push-in terminal

Wiring diagram



Additional information

Twist to unlock clockwise

Max. 3 switching elements can be clipped on

Legend

Switching action: C = Maintained