

# EAO – Your Expert Partner for Human Machine Interfaces

## 704.010.7 - Pushbutton actuator

### 704.010.7 - Pushbutton actuator

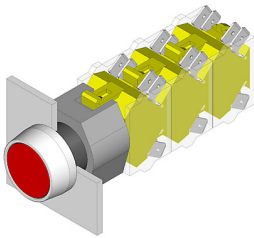

*Attention: The preview is based on a sample product. This can differ from your current configuration.*

#### Mounting

Mounting cut-out Ø 22.5 mm  
Design raised

#### Front

Front shape round  
Front dimension Ø 29 mm  
Front ring material Plastic  
Front ring colour grey

#### Other Attributes

Weight 0.040 kg

#### Operating-/Indication part

Lens optics transparent  
Lens material Plastic  
Lens colour colourless  
Lens profile flat

#### IP-Rating

Front protection IP 65

#### Actuator

Switching action Momentary  
Housing material Plastic  
Housing colour grey

#### Function

Pushbutton

# EAO – Your Expert Partner for Human Machine Interfaces

704.010.7 - Pushbutton actuator

## Dimensions

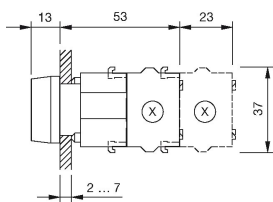

X = Screw terminal

## Mounting cut-outs

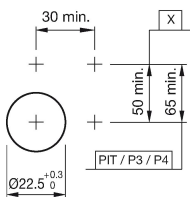

PIT = Push-in terminal

## Wiring diagram



## Additional information

Frontring with protective cover to be mounted with a torque of 40 Ncm onto actuator  
Max. 3 switching elements can be clipped on

## Legend

Switching action: B = Momentary