

84-909 - E-stop protective shroud



Attention: The preview is based on a sample product. This can differ from your current configuration.

Mounting

Mounting cut-out \varnothing 22.5 mm

Other Attributes

Marking
Weight 0.021 kg
Dimension \varnothing 45 mm
Material Metal
Colour yellow RAL 1003

IP-Rating

Front protection IP 40

EAO – Your Expert Partner for Human Machine Interfaces

84-909 - E-stop protective shroud

Dimensions

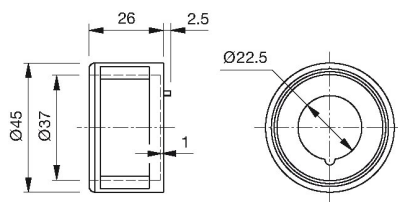

Additional information

Front panel thickness 1 ... 3 mm

With anti-twist device

When using a protective shroud the e-stop or stop switch has to be turned by 180° to be mounted. See dimensional drawing

The protection shroud is not suitable for a proper use of emergency-stop. It can obstruct a spontaneous operation of the emergency-stop