

EAO – Your Expert Partner for Human Machine Interfaces

704.732.0 - Pushbutton actuator square

704.732.0 - Pushbutton actuator square

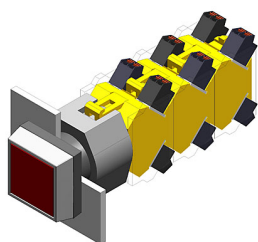

Attention: The preview is based on a sample product. This can differ from your current configuration.

Mounting

Mounting cut-out	Ø 22.5 mm
Design	raised

Other Attributes

Weight	0.020 kg
--------	----------

IP-Rating

Front protection	IP 65
------------------	-------

Actuator

Housing material	Plastic
Housing colour	black
Switching action	Maintained

Function

Pushbutton

EAO – Your Expert Partner for Human Machine Interfaces

704.732.0 - Pushbutton actuator square

Dimensions

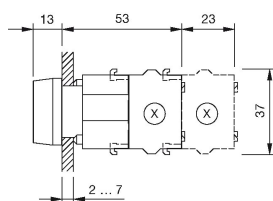

X = Screw terminal

Mounting cut-outs

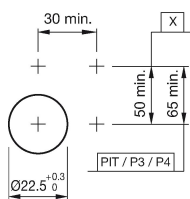

PIT = Push-in terminal

Wiring diagram



Additional information

Max. 3 switching elements can be clipped on

Legend

Switching action: C = Maintained