

# EAO – Your Expert Partner for Human Machine Interfaces

## 704.731.0 - Pushbutton actuator square

### 704.731.0 - Pushbutton actuator square

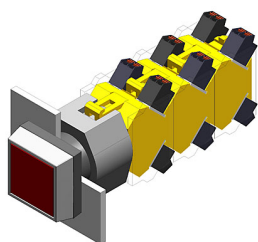

*Attention: The preview is based on a sample product. This can differ from your current configuration.*

#### Mounting

Mounting cut-out                    Ø 22.5 mm  
Design                                    raised

#### Other Attributes

Weight                                    0.020 kg

#### IP-Rating

Front protection                    IP 65

#### Actuator

Housing material                    Plastic  
Housing colour                    black  
Switching action                    Momentary

#### Function

Pushbutton

# EAO – Your Expert Partner for Human Machine Interfaces

704.731.0 - Pushbutton actuator square

## Dimensions

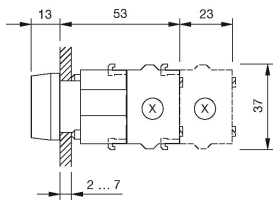

X = Screw terminal

## Mounting cut-outs

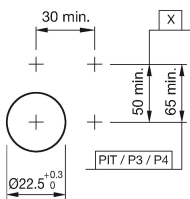

PIT = Push-in terminal

## Wiring diagram



## Additional information

Max. 3 switching elements can be clipped on

## Legend

Switching action: B = Momentary