

EAO – Your Expert Partner for Human Machine Interfaces

704.341.0 - Keylock switch actuator 2 positions

704.341.0 - Keylock switch actuator 2 positions

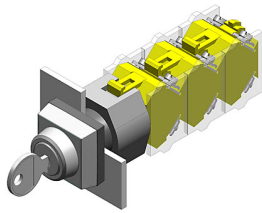

Attention: The preview is based on a sample product. This can differ from your current configuration.

Mounting

Mounting cut-out
Design \varnothing 22.5 mm
raised

Front

Front dimension 30 x 30 mm
Front shape square
Front bezel material Plastic
Front bezel colour grey

Other Attributes

Weight 0.070 kg

Operating-/Indication part

Switching angle $C = 90^\circ$

IP-Rating

Front protection IP 65

Actuator

Key remove A
Switching action Rest - Maintained

Switching element

Rotary positions 2

Function

Keylock switch

EAO – Your Expert Partner for Human Machine Interfaces

704.341.0 - Keylock switch actuator 2 positions

Dimensions

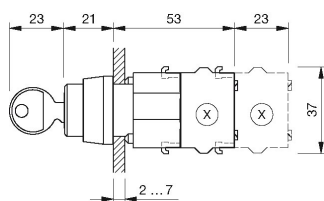

X = Screw terminal

Mounting cut-outs

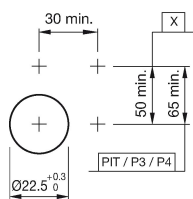

PIT = Push-in terminal

Wiring diagram



Switching positions

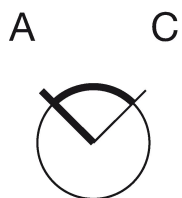

Additional information

Locknumbers 251, lock type Ronis
Two keys are supplied with each key lock switch
Further lock numbers see «Technical data»
Max. 3 switching elements can be clipped on

Legend

Switching action: A = Rest, C = Maintained