

# EAO – Your Expert Partner for Human Machine Interfaces

## 704.042.2 - Pushbutton actuator

### 704.042.2 - Pushbutton actuator

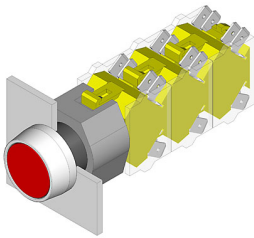

*Attention: The preview is based on a sample product. This can differ from your current configuration.*

#### Mounting

Mounting cut-out Ø 22.5 mm  
Design raised

#### Front

Front shape round  
Front dimension Ø 29 mm  
Front ring material Aluminium  
Front ring colour natural anodized

#### Other Attributes

Weight 0.040 kg

#### Operating-/Indication part

Lens optics transparent  
Lens material Plastic  
Lens colour red  
Lens profile flat

#### IP-Rating

Front protection IP 65

#### Actuator

Switching action Maintained  
Housing material Plastic  
Housing colour grey

#### Function

Pushbutton

# EAO – Your Expert Partner for Human Machine Interfaces

704.042.2 - Pushbutton actuator

## Dimensions

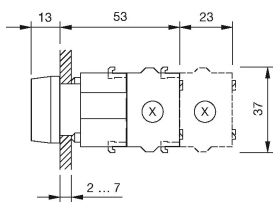

X = Screw terminal

## Mounting cut-outs

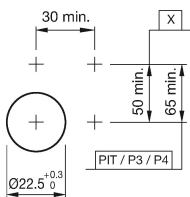

PIT = Push-in terminal

## Wiring diagram



## Additional information

Frontring with protective cover to be mounted with a torque of 40 Ncm onto actuator  
Max. 3 switching elements can be clipped on  
The colour of anodized aluminium parts can vary due to technical production reasons

## Legend

Switching action: C = Maintained