

**PRODUCT  
DATA SHEET**

Type	Size	Rating	Description	Part No.
Incandescent	T6	28V 0.04A	T-1¼ Midget Groove Lamp	388

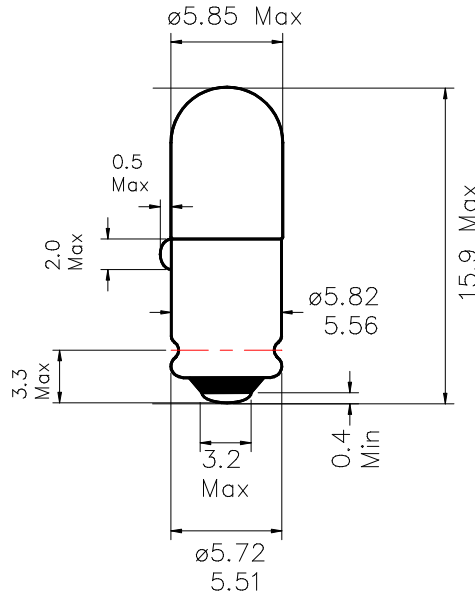

Drawing Not To Scale  
All Dimensions In mm

**PHOTOMETRY DATA**

TEST VOLTS	CURRENT (mA)			LIGHT OUTPUT (Lm)			LIFE (Hours)
	Min.	Nom.	Max.	Min.	Nom.	Max.	
28.0	36	40	44	2.9	3.8	4.7	10,000

**NOTES:**

- 1) Nickel-plated S5.7s base to IEC 61-1, (BS EN60061-1), sheet 7004-62-x.
- 2) C-2F filament shape.
- 3) Lamp Marking: "VCH 388 28V 40mA", to be engraved on the cap shell. Other marking as according to purchase order.
- 4) Lamp components are lead-free

Issue No.	Date	C.N. No.	Drawn	Tech	QA	Sales
1	26/10/06		NR		Approved	