



DATASHEET

QUICK CHANGERS

v1.3

1. Datasheet

1.1. Quick Changers

Quick Changer

| | | | | |
|--------------|--|----------------------------|---------------------------------|----------------------------|
| Name | Quick Changer I/O support – Robot Side | Quick Changer - Robot Side | Quick Changer - Robot Side 4.5A | Quick Changer - Robot Side |
| Item # | 102326 | 102037 | 104277 | 109498 |
| Version | QC-R – I/O | QC-R v2 | QC-R v2-4.5 | QC-R v3 |
| Illustration | | | | |

Dual Quick Changer

| | | | |
|--------------|--------------------|-------------------------|--------------------|
| Name | Dual Quick Changer | Dual Quick Changer 4.5A | Dual Quick Changer |
| Item # | 101788 | 104293 | 109878 |
| Version | Dual QC v2 | Dual QC v2-4.5 | Dual QC v3 |
| Illustration | | | |

If not specified, the data represent the combination of the different Quick Changer types/sides.

| Technical data | Min | Typical | Max | Units |
|----------------------------------|-----|---------|-------|------------|
| Permissible force * | - | - | 600* | [N] |
| Permissible torque * | - | - | 60* | [Nm] |
| Rated payload * | - | - | 20* | [kg] |
| | - | - | 44 | [lbs] |
| Repeatability | - | - | ±0.02 | [mm] |
| IP Classification | 67 | | | |
| Operating life (Tool change) | - | 5.000 | - | [cycles] |
| Operating life (Robot operation) | - | 10 | - | [M cycles] |

* See static load capacity graph below.

| | Quick Changer | Quick Changer for I/O | Dual Quick Changer | Quick Changer - Tool Side | Units |
|------------|----------------------------------|-----------------------|--------------------|---------------------------|-------|
| Weight | 0.06 | 0.093 | 0.41 | 0.14 | [kg] |
| | 0.13 | 0.21 | 0.9 | 0.31 | [lb] |
| Dimensions | See Mechanical dimension section | | | | |

QC-R V3 | DQC V3 and the QC-R V2 | QC-R V2-4.5A | DQC V2 | DQC V2-4.5A

The following graph shows the load capacity that the QC-R V3 | DQC V3 and the QC-R V2 | QC-R V2-4.5A | DQC V2 | DQC V2-4.5A can handle in a static situation. The values for a situation with an acceleration of 2g are half of the static values.

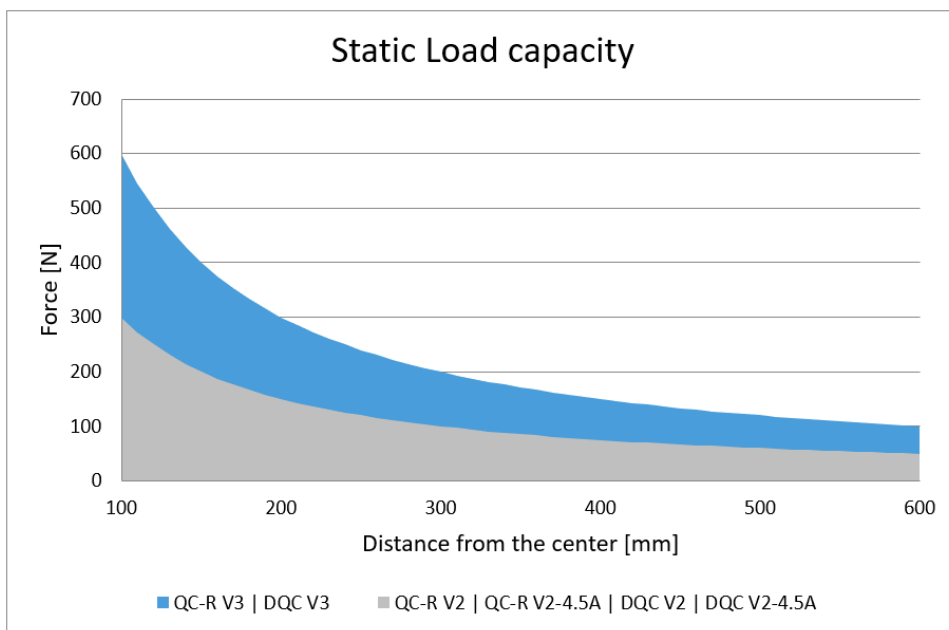

1.2. Quick Changer - Robot Side

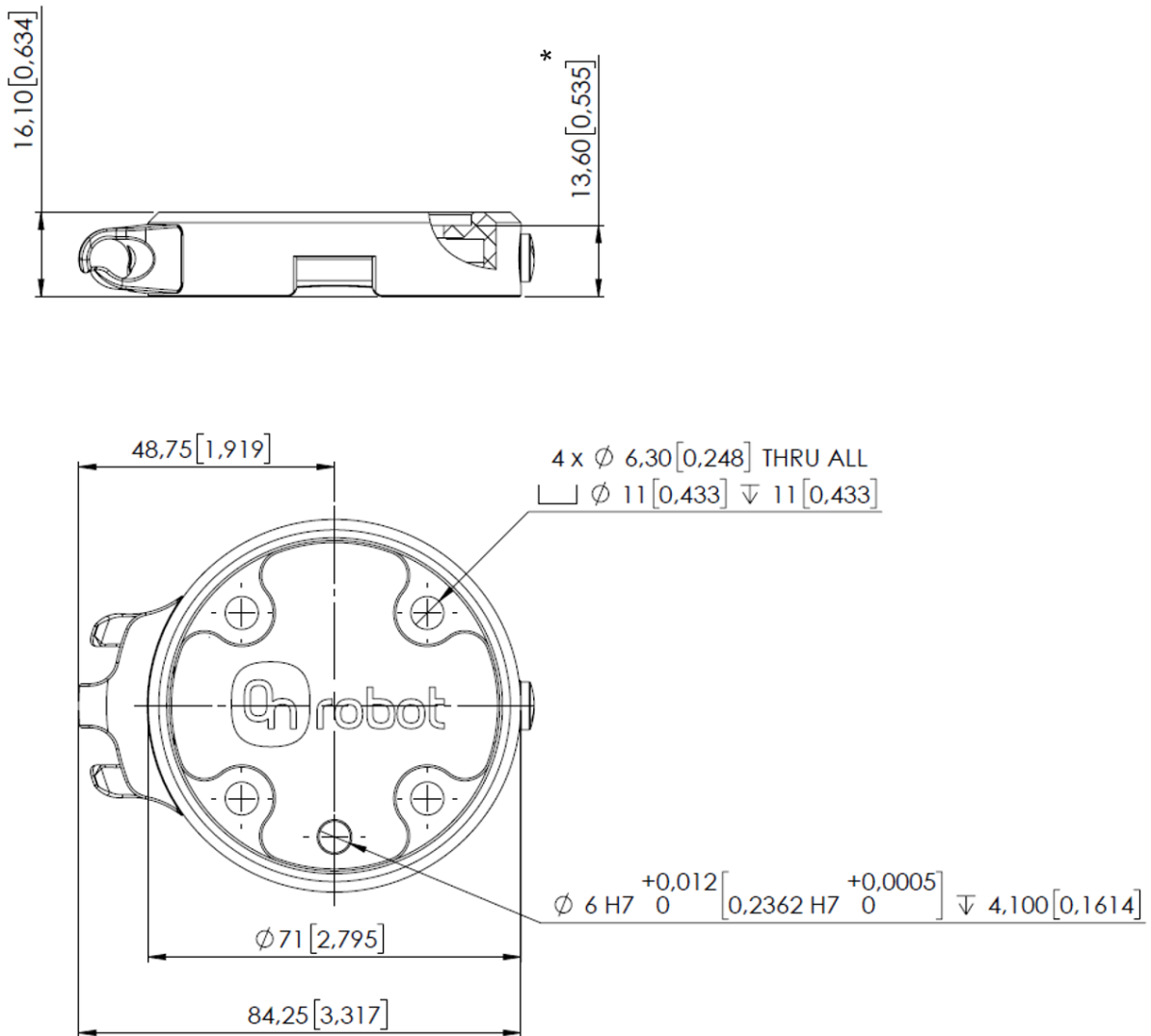

* Distance from Robot flange interface to OnRobot tool.

All dimensions are in mm and [inches].



NOTE:

The cable holder (on the left side) is only required with the long (5 meter) cable.

1.3. Dual Quick Changer

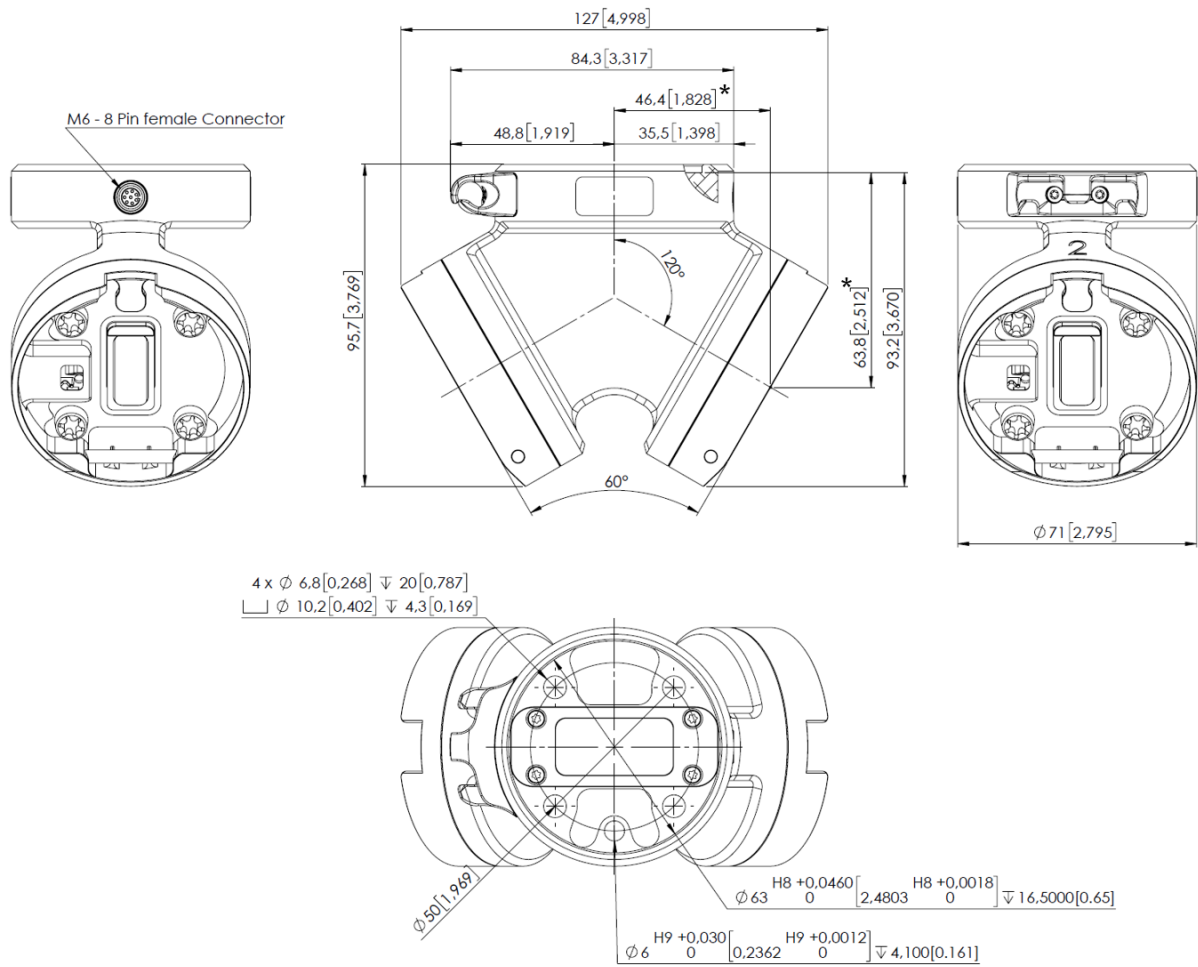

* Distance from Robot flange interface to OnRobot tool

All dimensions are in mm and [inches].

1.4. Quick Changer for I/O - Robot Side

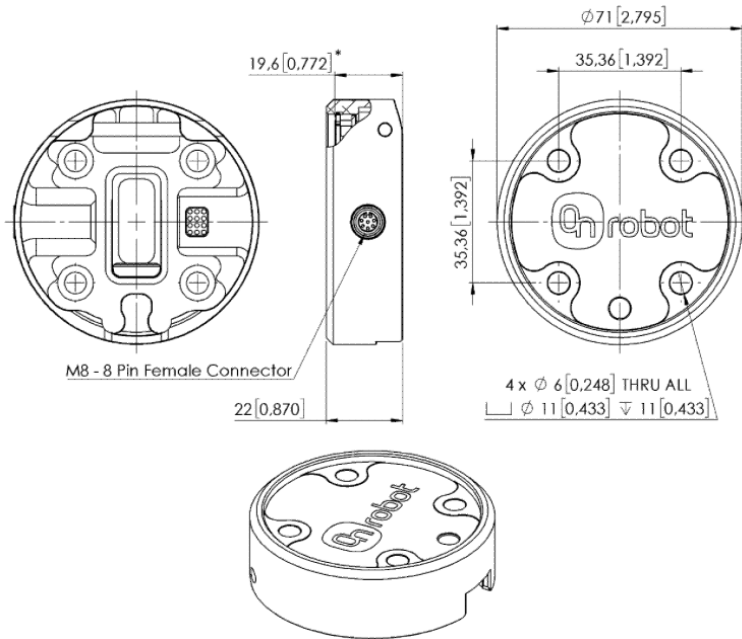

* Distance from Robot flange interface to OnRobot tool
 All dimensions are in mm and [inches].

1.5. Quick Changer - Tool Side

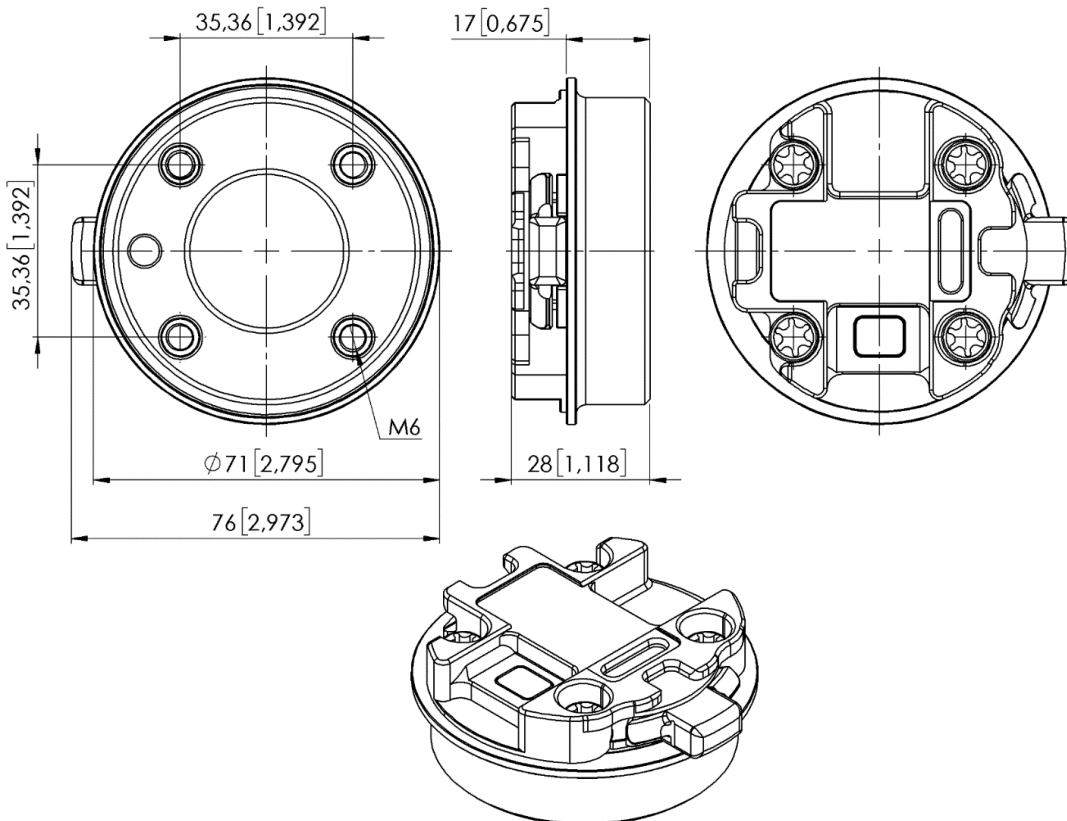

All dimensions are in mm and [inches].