

THIS COPY IS PROVIDED ON A RESTRICTED BASIS AND IS NOT TO BE USED IN ANY WAY DETRIMENTAL TO THE INTERESTS OF PANDUIT CORP.

PART NUMBER	PANEL THICKNESS	WIRE DIAMETER	RECOMMENDED FOR USE WITH 1000V SOLAR WIRES	DIMENSIONS - IN [mm]			
				F	H	S	W
MEC100-PV-C	.051-.098" [1.3-2.5mm]	.161-.240" [4.1-6.1mm]	1 OR 2 12 GAUGE, USE-2 WIRES	.44 [11.2]	.73 [18.5]	.20 [5.1]	.38 [9.7]
MEC100-2PV-C	.051-.098" [1.3-2.5mm]	.200-.300" [5.1-7.6mm]	1 OR 2 10 GAUGE, PV WIRES	.44 [11.2]	.73 [18.5]	.28 [7.1]	.38 [9.7]

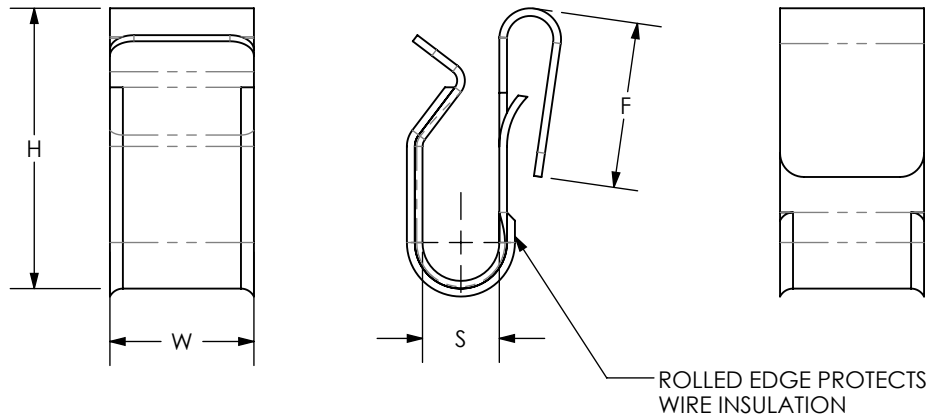
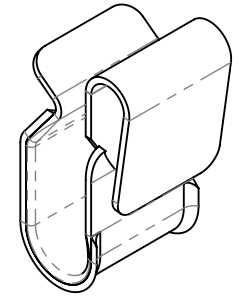

NOTES:

1. UL LISTED TO US AND CANADIAN REQUIREMENTS UNDER FILE E136577
2. MATERIAL: .02" [.5] THICK 410 STAINLESS STEEL
3. CABLE ORIENTATION IS PARALLEL TO PANEL EDGE
4. NO INSTALLATION TOOLS REQUIRED
5. PACKAGING QTY: C = 100

REV	DATE	BY	CHK	APR	DESCRIPTION	ECN
01	12/19	JHNU	TMR	RGB	REVISED UPPER LIMIT ON WIRE DIAMETER RANGE	056434
00	11/19	JHNU	TMR	RGB	DRAWING RELEASED	056434

TITLE		SOLAR METAL EDGE CLIP (MEC100-PV-C, MEC100-2PV-C) CUSTOMER DRAWING	
ITEM REVISION NAME	00494EBK/00		
DATASET FILE NAME	00494EBK-DC/00.SLDDRW		
UNLESS OTHERWISE SPECIFIED, DIMENSIONAL TOLERANCES ARE: IN [mm]		MATERIAL	
.X ±	.XXX ±	SEE NOTES	
.XX ± .04 [1.0]	ANGLES ±		
DRAWN BY		DATE	DRAWING NUMBER
JHNU	11/19	TMR	00494EBK-DC
THIRD ANGLE PROJECTION		SCALE	SHEET 1 OF 1
N/A			SIZE
			A