

PART

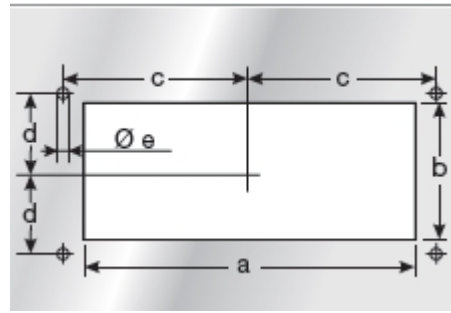

CUTOUT

NOTES:

1. VISIT OUR ON-LINE CATALOG AT WWW.PANDUIT.COM FOR A LIST OF CURRENT PARTS APPLICABLE FOR USE WITH THIS PRODUCT.
2. DIMENSIONS IN [] ARE METRIC.
3. ALL MATERIALS AND COMPONENTS USED MEET THE MATERIAL RESTRICTIONS OF RoHS (EUROPEAN DIRECTIVE 2011/65/EU ON THE RESTRICTION OF HAZARDOUS SUBSTANCES) AS PROPOSED BY THE RoHS TECHNICAL ADAPTATION COMMITTEE.
4. MATERIAL:
 FRAME - POLYPROPYLENE (PP)
 BLOCK - TPE
5. PROTECTION CLASS:
 NEMA 12,4x*
 IP 66
6. TEMPERATURE RANGE: -22 - 158 °F
7. FLAMMABILITY: HB
8. RoHS COMPLIANT
9. COMPLIANCE: cURus
10. UV RESISTANT
11. WEIGHT: SEE TABLE

*Indoor Use



PART NUMBER	A	B	INSTALLATION HEIGHT in. (mm)	NUMBER OF OPENINGS		a	b	c	d	e	PART WEIGHT lbs. (g)	PKG QTY
	in. (mm)	in. (mm)		TOTAL	NUMBER X DIA.	in. (mm)	in. (mm)	in. (mm)	in. (mm)	in. (mm)		
CESUM3-E23	5.87 (149)	2.40 (61)	0.37 (9.4)	23	23 x 0.2 - 0.35 (23 x 5 - 9)	4.41 (112)	1.42 (36)	2.56 (65)	0.63 (16)	0.22 (5.5)	0.117 (53)	5
CESUM3-E14	5.87 (149)	2.40 (61)	0.37 (9.4)	14	14 x 0.3 - .047 (14 x 7.5 - 12)	4.41 (112)	1.42 (36)	2.56 (65)	0.63 (16)	0.22 (5.5)	0.117 (53)	5
CESUM3-D24	4.84 (123)	2.40 (61)	0.37 (9.4)	24	16 x 0.12 - 0.24 (16 x 3 - 6)	3.39 (86)	1.42 (36)	2.03 (51.5)	0.63 (16)	0.22 (5.5)	0.99 (44.70)	5
					6 x 0.2 - 0.35 (6 x 5 - 9)							
					2 x 0.3 - 0.47 (2 x 7.5 - 12)							
CESUM3-D17	4.84 (123)	2.40 (61)	0.37 (9.4)	17	17 x 0.2 - 0.35 (17 x 5 - 9)	3.39 (86)	1.42 (36)	2.03 (51.5)	0.63 (16)	0.22 (5.5)	0.98 (44.55)	5
CESUM3-D12	4.84 (123)	2.40 (61)	0.37 (9.4)	12	2 x 0.12 - 0.2 (2 x 3 - 5)	3.39 (86)	1.42 (36)	2.03 (51.5)	0.63 (16)	0.22 (5.5)	0.94 (42.84)	5
					4 x 0.2 - 0.35 (4 x 5 - 9)							
					2 x 0.3 - 0.47 (2 x 7.5 - 12)							
					2 x 0.4 - 0.63 (2 x 10 - 16)							
					2 x 0.55 - 0.79 (2 x 14 - 20)							
CESUM3-D10	4.84 (123)	2.40 (61)	0.37 (9.4)	10	10 x 0.3 - 0.47 (10 x 7.5 - 12)	3.39 (86)	1.42 (36)	2.03 (51.5)	0.63 (16)	0.22 (5.5)	0.98 (44.67)	5
CESUM3-C15	4.05 (103)	2.40 (61)	0.37 (9.4)	15	8 x 0.12 - 0.24 (8 x 3 - 6)	2.56 (65)	1.42 (36)	1.63 (41.5)	0.63 (16)	0.22 (5.5)	0.83 (37.80)	5
					3 x 0.2 - 0.35 (3 x 5 - 9)							
					4 x 0.3 - 0.47 (4 x 7.5 - 12)							
CESUM3-C14	4.05 (103)	2.40 (61)	0.37 (9.4)	14	14 x 0.2 - 0.35 (14 x 5 - 9)	2.56 (65)	1.42 (36)	1.63 (41.5)	0.63 (16)	0.22 (5.5)	0.83 (37.80)	5

00A	9/13/2022	SERH	MDS	JADE	INITIAL RELEASE	124032/00
REV	DATE	BY	CHK	APR	DESCRIPTION	ECN

PART NUMBER		SEE TABLE	
TITLE			
CESUM3 Control Drawing			
CUSTOMER DRAWING			
ITEM REVISION NAME		00872EBJ/00	
DATASET FILE NAME		00872EBJ_DC/00A	
		THIRD ANGLE PROJECTION	
MATERIAL		SEE NOTE 4	
DRAWING NUMBER		00872EBJ-DC	
DRAWN BY	DATE	CHK	SCALE
SERH	9/13/2022	MDS	1:1
SHEET 1 OF 1			B

B

B

A

A

B-SIZE CUSTOMER