

WIRING		
MIN PIN #	PORT / PIN	FUNCTION
1	ALL PORTS PIN 1	DRAIN
2	ALL PORTS PIN 2	V+
3	ALL PORTS PIN 3	V-
4	ALL PORTS PIN 4	CAN_H
5	ALL PORTS PIN 5	CAN_L

REVISIONS			
REV.	DESCRIPTION	DATE	APPROVED
A	REDRAWN IN SW	8/28/2006	

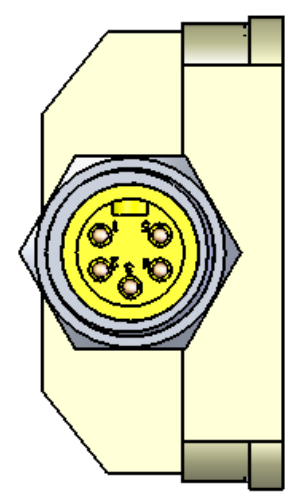
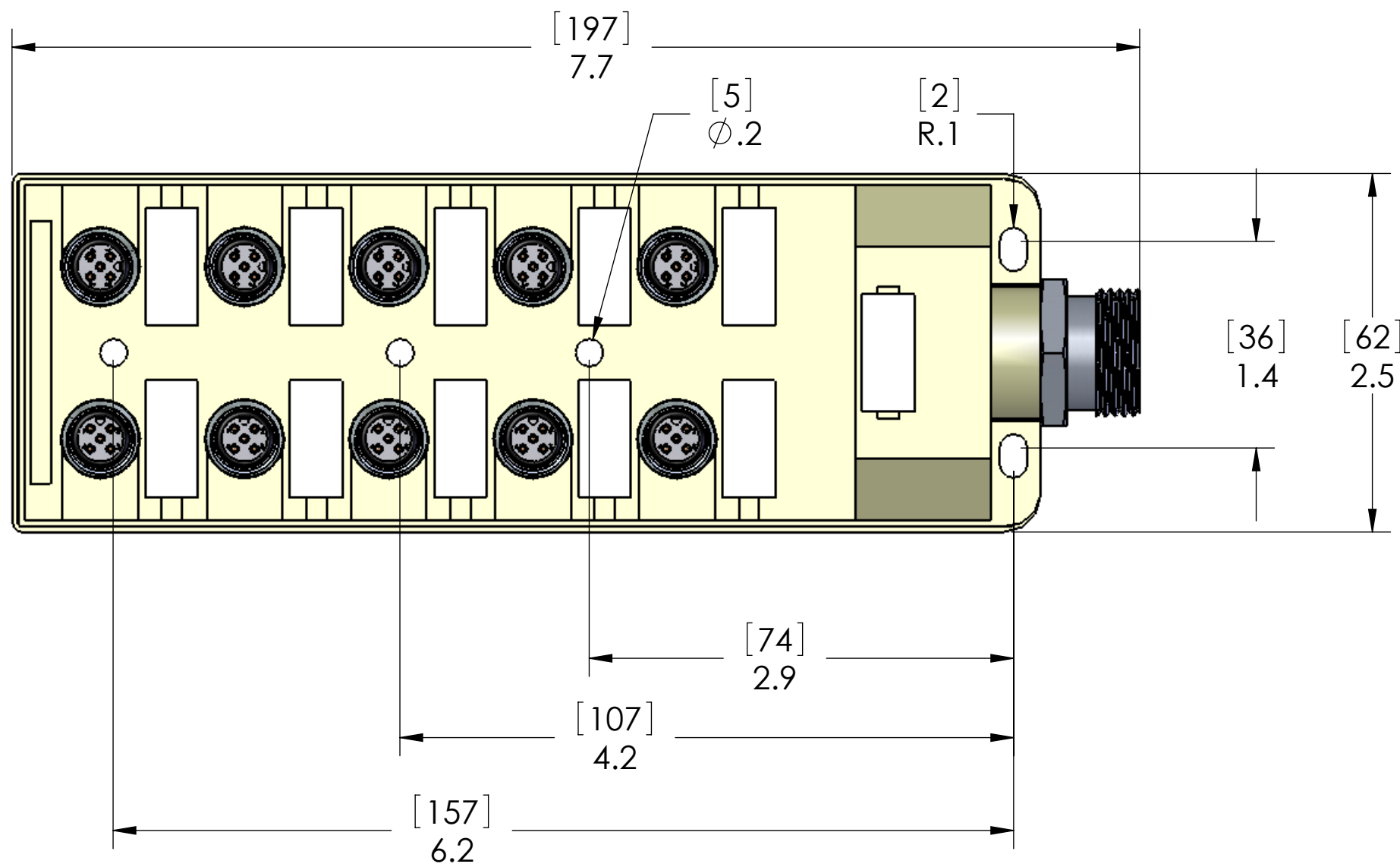

MATERIALS:	
BLOCK HOUSING:	POLYPROPYLENE
PORT CONN INSERTS:	POLYAMIDE
PORT CONN HSG:	NICKEL PLATED BRASS
CONTACTS:	GOLD PLATED COPPER ALLOY
OUTPUT CONN HSG:	ANODIZED ALUMINUM HSG
OUTPUT CONN INS.:	YELLOW PVC
O-RINGS:	NBR

PROPRIETARY AND CONFIDENTIAL
 THE INFORMATION CONTAINED IN THIS DRAWING IS THE SOLE PROPERTY OF MENCOM CORPORATION. ANY REPRODUCTION IN PART OR AS A WHOLE WITHOUT THE WRITTEN PERMISSION OF MENCOM CORPORATION IS PROHIBITED.

UNLESS OTHERWISE SPECIFIED:		NAME
DIMENSIONS ARE IN INCHES		DRAWN BEM
TOLERANCES:		CHECKED
FRACTIONAL ±1/64		ENG APPR.
ANGULAR: MACH ±5° BEND ±5°		MFG APPR.
TWO PLACE DECIMAL ±.01		Q.A.
THREE PLACE DECIMAL ±.004		COMMENTS:
MATERIAL		
FINISH		
DO NOT SCALE DRAWING		

MENCOM CORPORATION		
TITLE:		
SIZE	DWG. NO.	REV
B	JDN-050-005-M000	A
SCALE: 1:1	WEIGHT:	SHEET 1 OF 1