

FEMALE END VIEW		TYPICAL PANEL CUTOUT		SPECIFICATIONS	
 <p>1 = BROWN 2 = WHITE 3 = BLUE 4 = BLACK</p>				CONTACT CARRIER MATERIAL	NYLON OR TPU
				CONTACT MATERIAL/PLATING	BRASS/GOLD
				O-RING MATERIAL	BUNA-N
				RATED CURRENT [A]	4.0 A
				RATED VOLTAGE [V]	250 V
				HOUSING, LOCKNUT MATERIAL/PLATING	BRASS/NICKEL
				NUMBER OF CONDUCTORS [AWG]	4x18 AWG
				TEMPERATURE RATING	-40°C to +105°C (-40°F to +221°F)
				PROTECTION CLASS	MEETS NEMA 1,3,4,6P AND IEC IP68
				MAX. PANEL THICKNESS	3.0 [0.12]

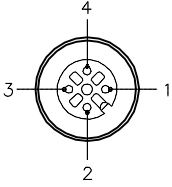
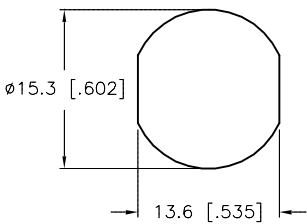
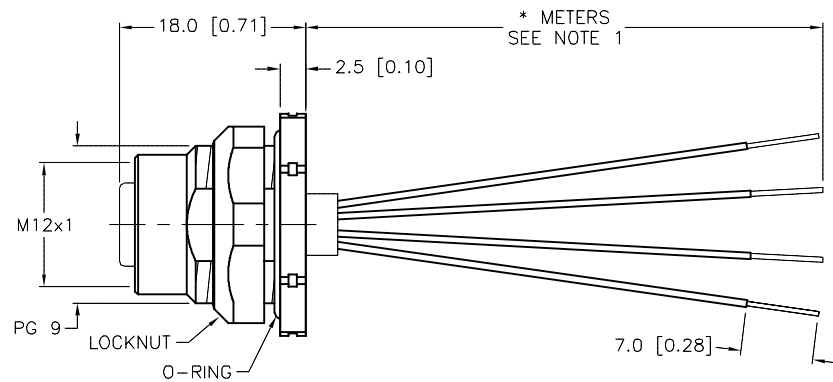
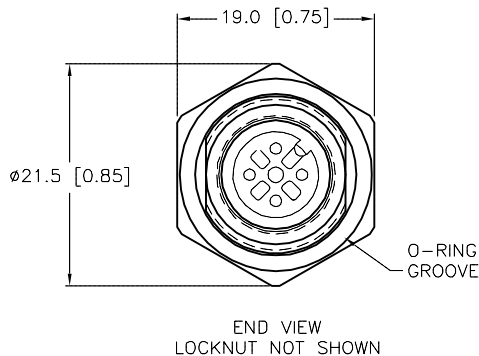

CABLE LENGTH	TOLERANCE*
ALL LENGTHS	+ 4% (OR 50mm) OF LENGTH - 0% (OR 0mm) OF LENGTH WHICHEVER IS GREATER
STRIP LENGTH	TOLERANCE*
0-7mm	±0.5mm
8-29mm	±1.0mm
30-49mm	±2.0mm
50-69mm	±3.0mm
70-100mm	±4.0mm
OVER 100mm	±5.0mm
* UNLESS OTHERWISE SPECIFIED	

#### NOTES:

- "\*" INDICATES LEAD LENGTH IN METERS. CONTACT TURCK TO ORDER SPECIFIC LENGTHS.
- "/S613" DESIGNATES 18 AWG CONDUCTORS.
- "/S658" DESIGNATES 300 VOLT RATED WIRES. ALL OTHER SPECS ARE THE SAME AS STANDARD STYLES.

#### SOURCE DRAWING - FOR REFERENCE ONLY

A	DRAWING RELEASE	KMY	02/17/12	
REV	DESCRIPTION	BY	DATE	ECO NO.

RELATED DOCUMENTS 1. 2. 3. 4.	3RD ANGLE PROJECTION 	THIS DRAWING IS CONFIDENTIAL AND THE PROPERTY OF TURCK INC. USE OF THIS DOCUMENT WITHOUT WRITTEN PERMISSION IS PROHIBITED.		<b>TURCK INC</b> High Technology Sensors and Automation Controls 3000 CAMPUS DRIVE MINNEAPOLIS, MN 55441 1-800-544-7769 (763) 553-7300 (763) 553-0708 fax turck.com	
MATERIAL	SEE SPECIFICATIONS	DRFT	KMY	DATE	02/08/12
FINISH	SEE SPECIFICATIONS	APVD	E.S.	SCALE	1=.8
		UNIT OF MEASUREMENT		DESCRIPTION	
		MILLIMETER [ INCH ]		FKFD 4.4-*/S613/S658	
		DO NOT SCALE THIS DRAWING		IDENTIFICATION NO.	
				REV	
				A	
				FILE: 777028619	
				SHEET 1 OF 1	