

| SPECIFICATIONS                 |                                   |
|--------------------------------|-----------------------------------|
| CONTACT CARRIER MATERIAL/COLOR | NYLON OR TPU/YELLOW               |
| CONTACT MATERIAL/PLATING       | BRASS/GOLD                        |
| RATED CURRENT [A]              | 4.0 A                             |
| RATED VOLTAGE [V]              | 250 V                             |
| HOUSING MATERIAL/PLATING       | BRASS/NICKEL                      |
| CONDUCTOR INSULATION MATERIAL  | PVC                               |
| NUMBER OF CONDUCTORS [AWG]     | 4x22 AWG                          |
| TEMPERATURE RATING             | -40°C to +105°C (-40°F to +221°F) |
| PROTECTION CLASS               | MEETS NEMA 1,3,4,6P AND IEC IP68  |

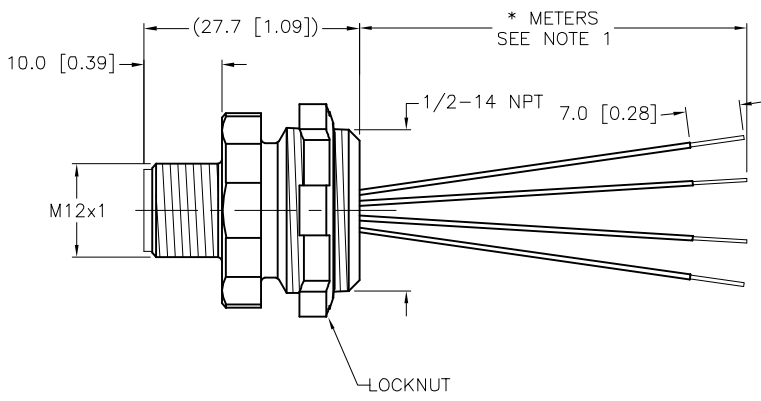
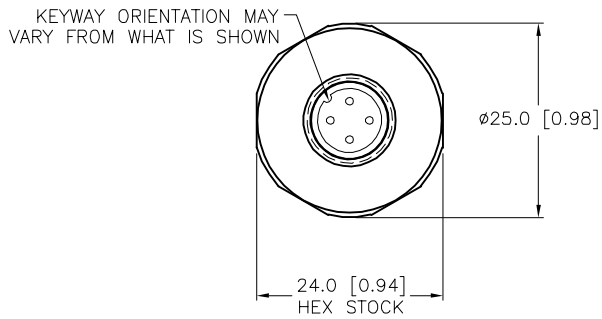

| CABLE LENGTH                 | TOLERANCE *   |
|------------------------------|---|
| ALL LENGTHS                  | + 4% (OR 50mm) OF LENGTH<br>- 0% (OR 0mm) OF LENGTH<br>WHICHEVER IS GREATER |
| STRIP LENGTH                 | TOLERANCE *   |
| 0-7mm                        | ±0.5mm  |
| 8-29mm                       | ±1.0mm  |
| 30-49mm                      | ±2.0mm  |
| 50-69mm                      | ±3.0mm  |
| 70-100mm                     | ±4.0mm  |
| OVER 100mm                   | ±5.0mm  |
| * UNLESS OTHERWISE SPECIFIED |   |

- NOTES:**
- "\*" DESIGNATES LEAD LENGTH IN METERS. CONTACT TURCK TO ORDER SPECIFIC LENGTHS.
  - "W/LN" DESIGNATES LOCKNUT INCLUDED IN PACKAGE.

**SOURCE DRAWING - FOR REFERENCE ONLY**

|   |   |  |             |  |                 |
|---|---|--|-------------|--|-----------------|
| RELATED DOCUMENTS<br>1.<br>2.<br>3.<br>4. | 3RD ANGLE PROJECTION<br>  | THIS DRAWING IS CONFIDENTIAL AND THE PROPERTY OF TURCK INC. USE OF THIS DOCUMENT WITHOUT WRITTEN PERMISSION IS PROHIBITED. |             | <b>TURCK</b><br>3000 CAMPUS DRIVE<br>MINNEAPOLIS, MN 55441<br>1-800-544-7769<br>(763) 553-7300<br>(763) 553-0708 fax<br>www.turck.us |                 |
|   |   | DRFT   | RDS         |  | DATE 11/05/08   |
| MATERIAL<br>SEE SPECIFICATIONS            | ALL DIMENSIONS DISPLAYED ON THIS DRAWING ARE FOR REFERENCE ONLY | DSGN   | SCALE 1=1.0 | IDENTIFICATION NO.   | REV<br>C        |
| FINISH<br>SEE SPECIFICATIONS              |   | UNIT OF MEASUREMENT<br><b>MILLIMETER [ INCH ]</b>  |             |  | FILE: 777015492 |
| DO NOT SCALE THIS DRAWING                 |   |  |             |  |                 |

|     |  |     |          |         |
|-----|--|-----|----------|---------|
| C   | DRAWING PROCESSED AS PART OF ECO 33971 | CBM | 04/06/11 | 33971   |
| REV | DESCRIPTION                            | BY  | DATE     | ECO NO. |