



Product designation

Signal tower
Ø50mm/1.97"

Product type designation

LTN50

General characteristics

Diameter mm - inch 50 / 1.97

Material Metal

Mechanical features

Weight g 28

Ambient conditions

Temperature

Operating temperature

| | | |
|-----|----|-----|
| min | °C | -30 |
| max | °C | +50 |

Dimensions

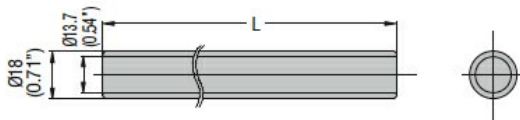

| Type | L (mm/in) |
|-----------|--------------|
| LTP50P100 | 100 (3.94") |
| LTP50P250 | 250 (9.84") |
| LTP50P400 | 400 (15.75") |

Certifications and compliance

Compliance

CSA C22.2 n° 14
IEC/EN/BS 60947-1
IEC/EN/BS 60947-5-1
UL508

Certificates

cULus

ETIM classification

ETIM 8.0

EC001155 -
Tube for signal
tower